

The deed or easement of which this plat is a part is recorded in Deed Book 59, at page 9.

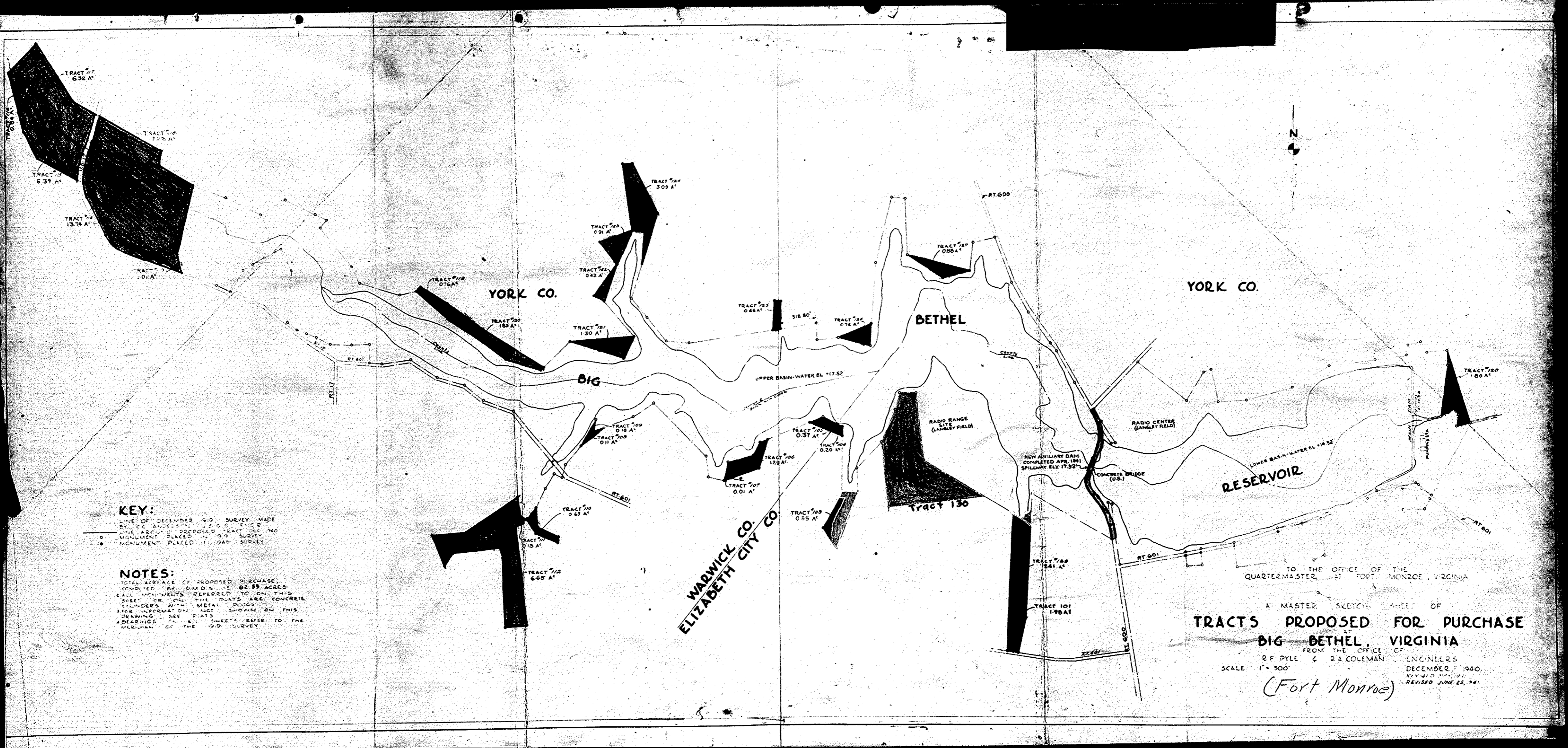

KEY:
 — LINE OF DECEMBER 9, 1940 SURVEY MADE BY YORK CO. AND U.S.G.S. ENGINEERS
 — LINE ABOUT PROPOSED TRACT SEE NO. MONUMENT PLACED IN 1940 SURVEY
 • MONUMENT PLACED IN 1940 SURVEY

NOTES:
 TOTAL ACRES OF PROPOSED PURCHASE COMPLETED BY D.M.D.S. IS 62.93 ACRES. ALL MONUMENTS REFERRED TO ON THIS SHEET OR ON THE PLATS ARE CONCRETE CYLINDERS WITH METAL PLUGS. FOR INFORMATION NOT SHOWN ON THIS DRAWING SEE PLATS. ALL SHEETS REFER TO THE MERIDIAN OF THE 1940 SURVEY.

WARWICK CO.
ELIZABETH CITY CO.

TO THE OFFICE OF THE QUARTERMASTER AT FORT MONROE, VIRGINIA

A MASTER SKETCH SHEET OF
TRACTS PROPOSED FOR PURCHASE
BIG BETHEL, VIRGINIA
 FROM THE OFFICE OF
 R. F. PYLE & R. J. COLEMAN ENGINEERS
 DECEMBER, 1940.
 SCALE 1" = 300'
 (Fort Monroe)
 REVISED JUNE 25, 1941