

A plat of a small piece of woodland, Situate in Pisonon District, York County, Virginia, being a part of the portion of Capt. Thomas Phillips' estate that pertains to the share of Mrs W.C. Moore - The whole area of this Survey is 18.04 ACRES - Eight (8) acres of which is cut off at the East End, adjoining Edwards, for Moore, leaving the area of the remainder of the tract to be 10.04 Acres - Surveyed Oct 23rd 1922 - Sydney Smith, Surveyor

Map Book No. 4 Page 19

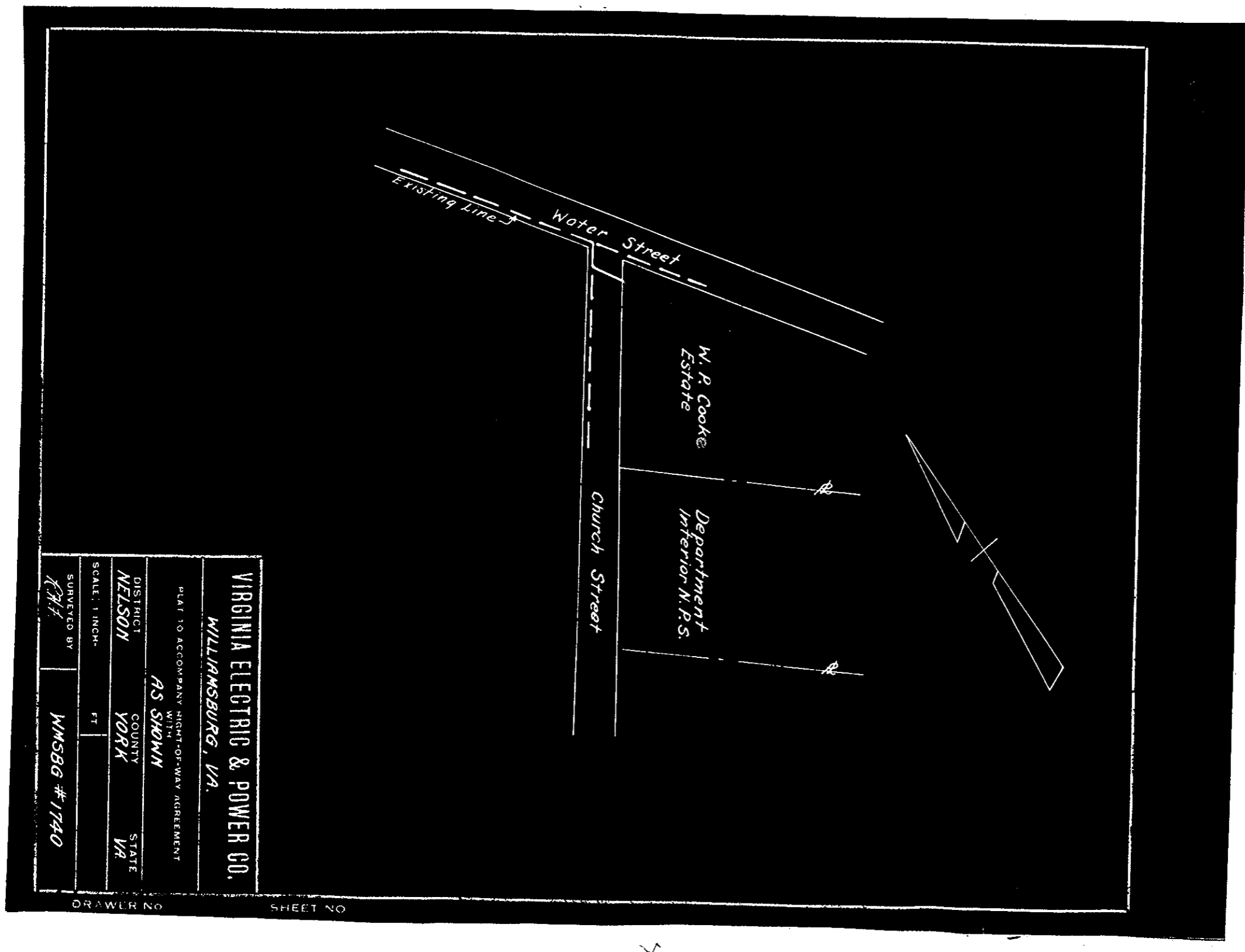

The Right of way of which this plat is a part is in Deed Book 60, A at page 468.