

REF: FORM NO. 15 VIRGINIA ELECTRIC AND POWER COMPANY PLAN TO ACCOMPANY RIGHT-OF-WAY AGREEMENT			
PENINSULA	DISTRICT		
BRUTON	COUNTY	YORK	STATE
WILLIAMSBURG	OFFICE	NO. 84	5
		1948	

Plan Book No. 4 Page 48

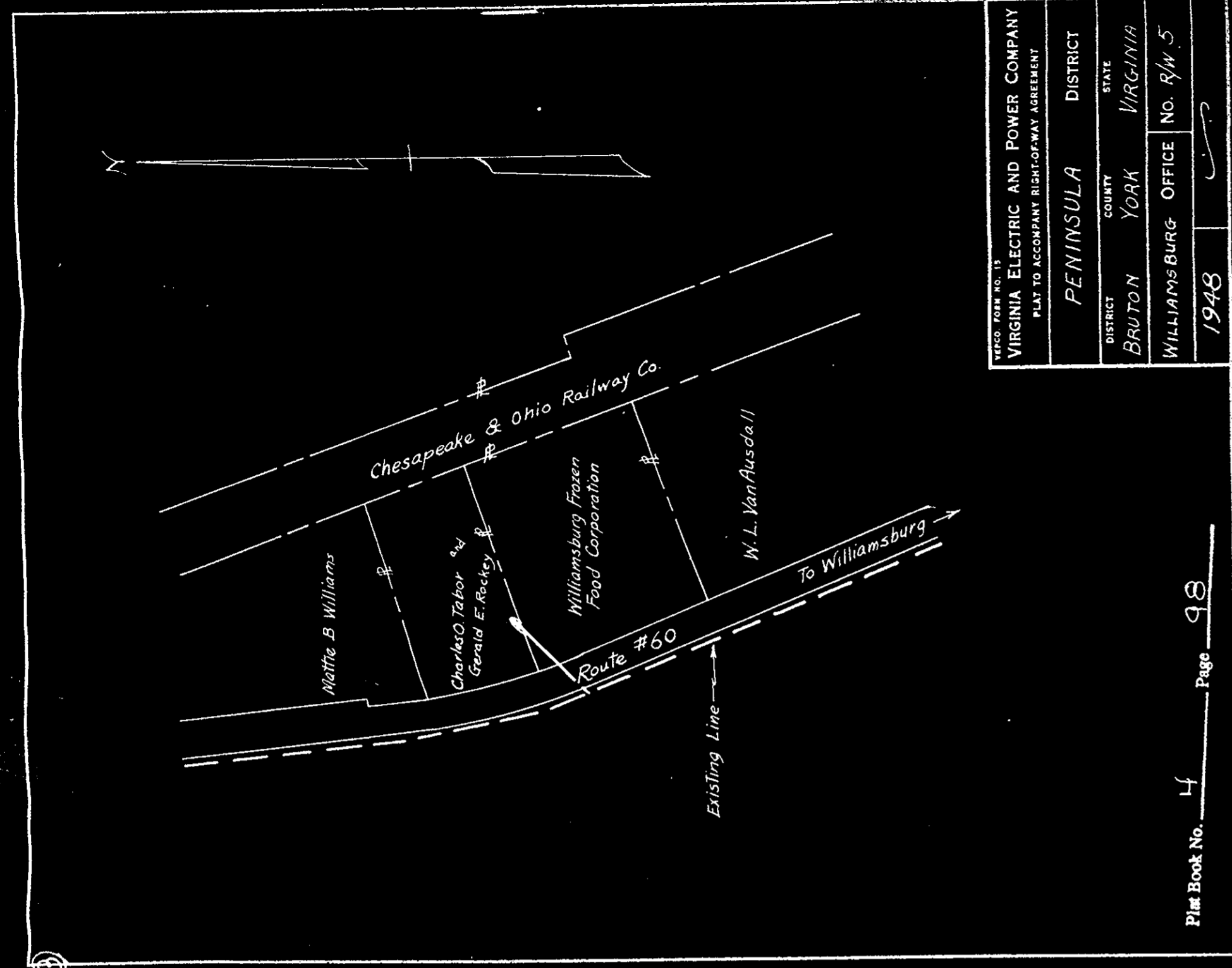

REF: FORM NO. 15 VIRGINIA ELECTRIC AND POWER COMPANY PLAN TO ACCOMPANY RIGHT-OF-WAY AGREEMENT			
PENINSULA	DISTRICT		
BRUTON	COUNTY	YORK	STATE
WILLIAMSBURG	OFFICE	NO. 84	5
		1948	

Plan Book No. 4 Page 48

Dead Book 65, page 160

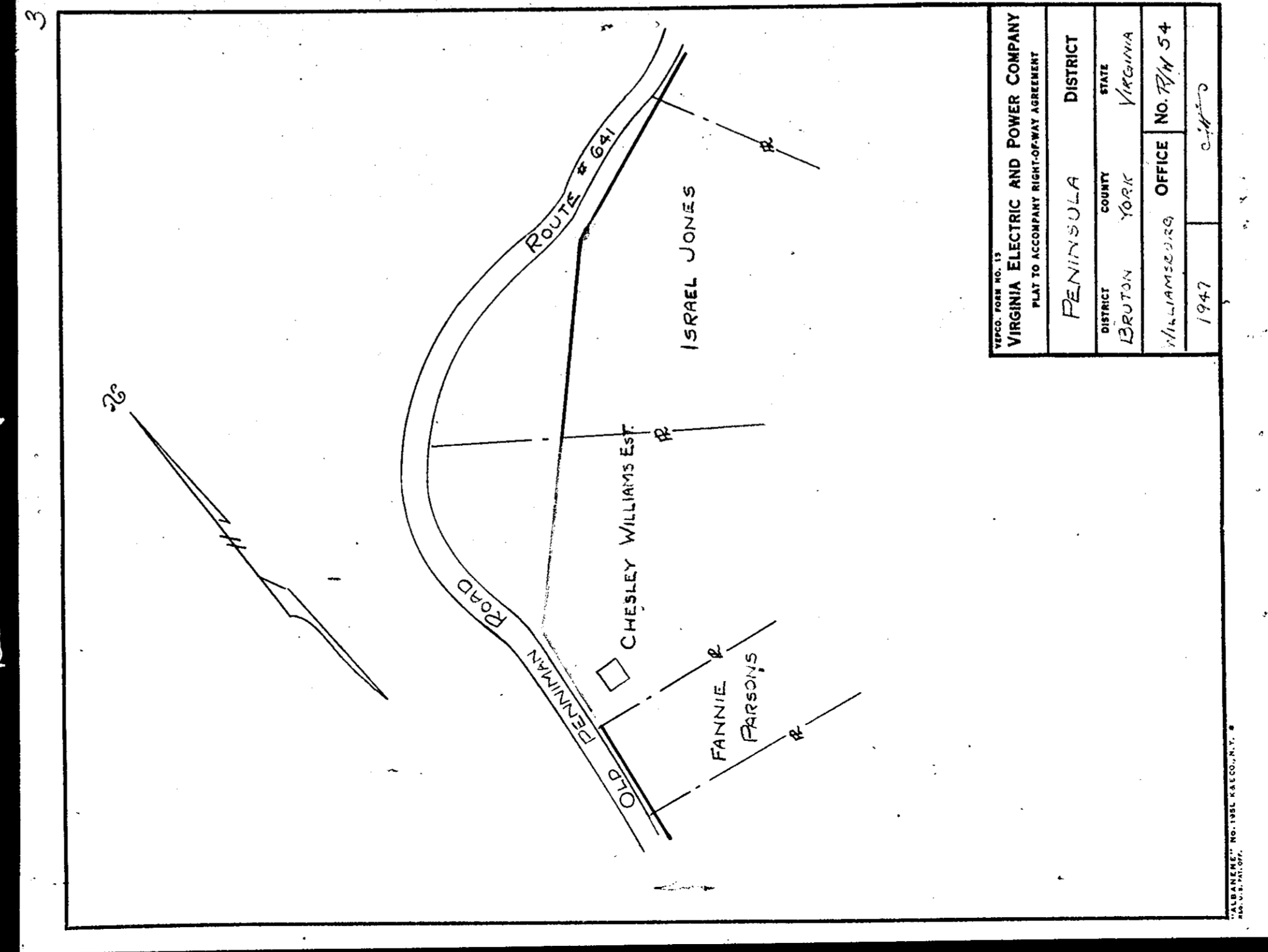

REF: FORM NO. 15 VIRGINIA ELECTRIC AND POWER COMPANY PLAN TO ACCOMPANY RIGHT-OF-WAY AGREEMENT			
PENINSULA	DISTRICT		
BRUTON	COUNTY	YORK	STATE
WILLIAMSBURG	OFFICE	NO. 84	54
		1947	

Plan Book No. 4 Page 48

Dead Book 65, page 161

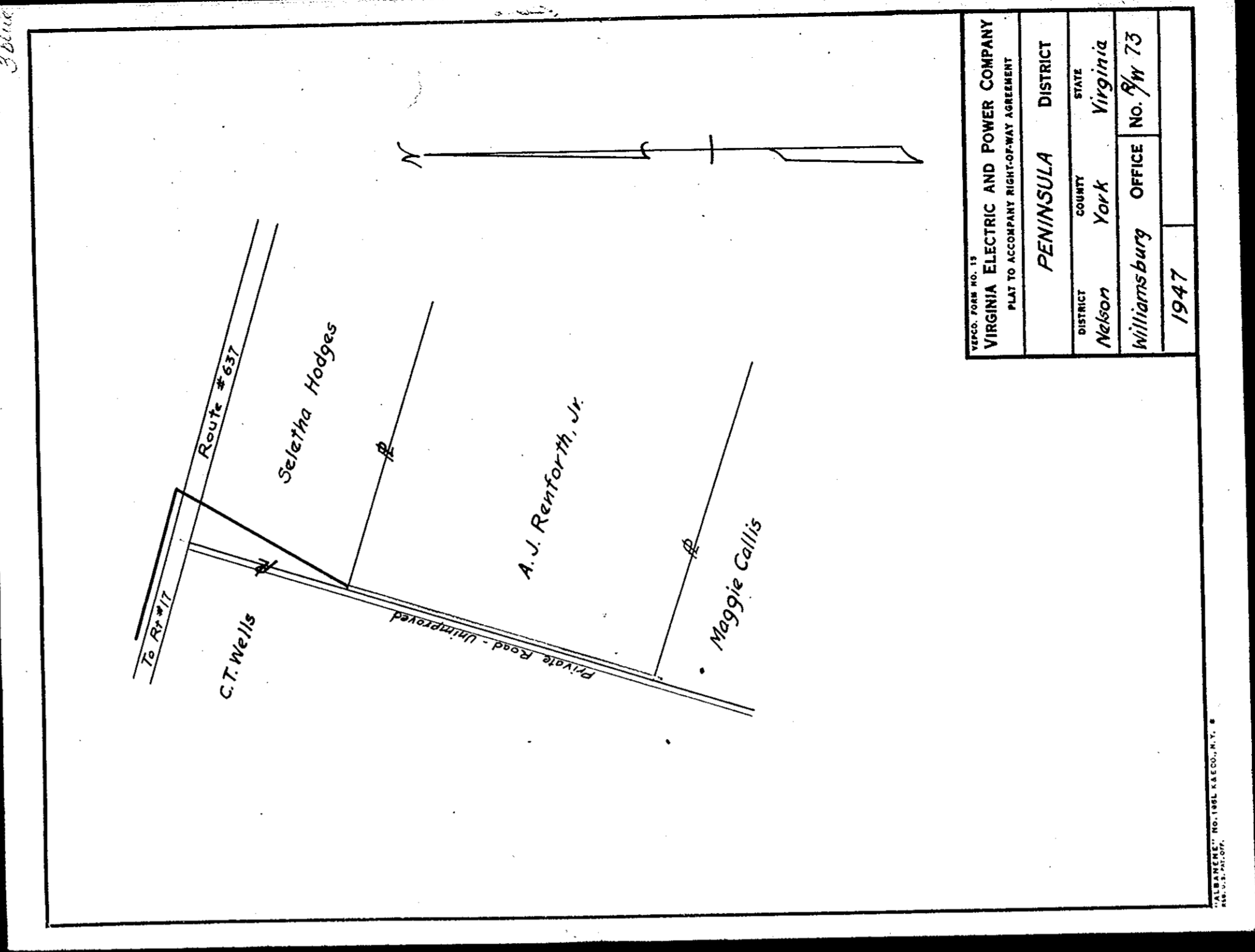

REF: FORM NO. 15 VIRGINIA ELECTRIC AND POWER COMPANY PLAN TO ACCOMPANY RIGHT-OF-WAY AGREEMENT			
PENINSULA	DISTRICT		
BRUTON	COUNTY	YORK	STATE
WILLIAMSBURG	OFFICE	NO. 84	73
		1947	

Plan Book No. 4 Page 48