

Plan Book No. 4 Page 165

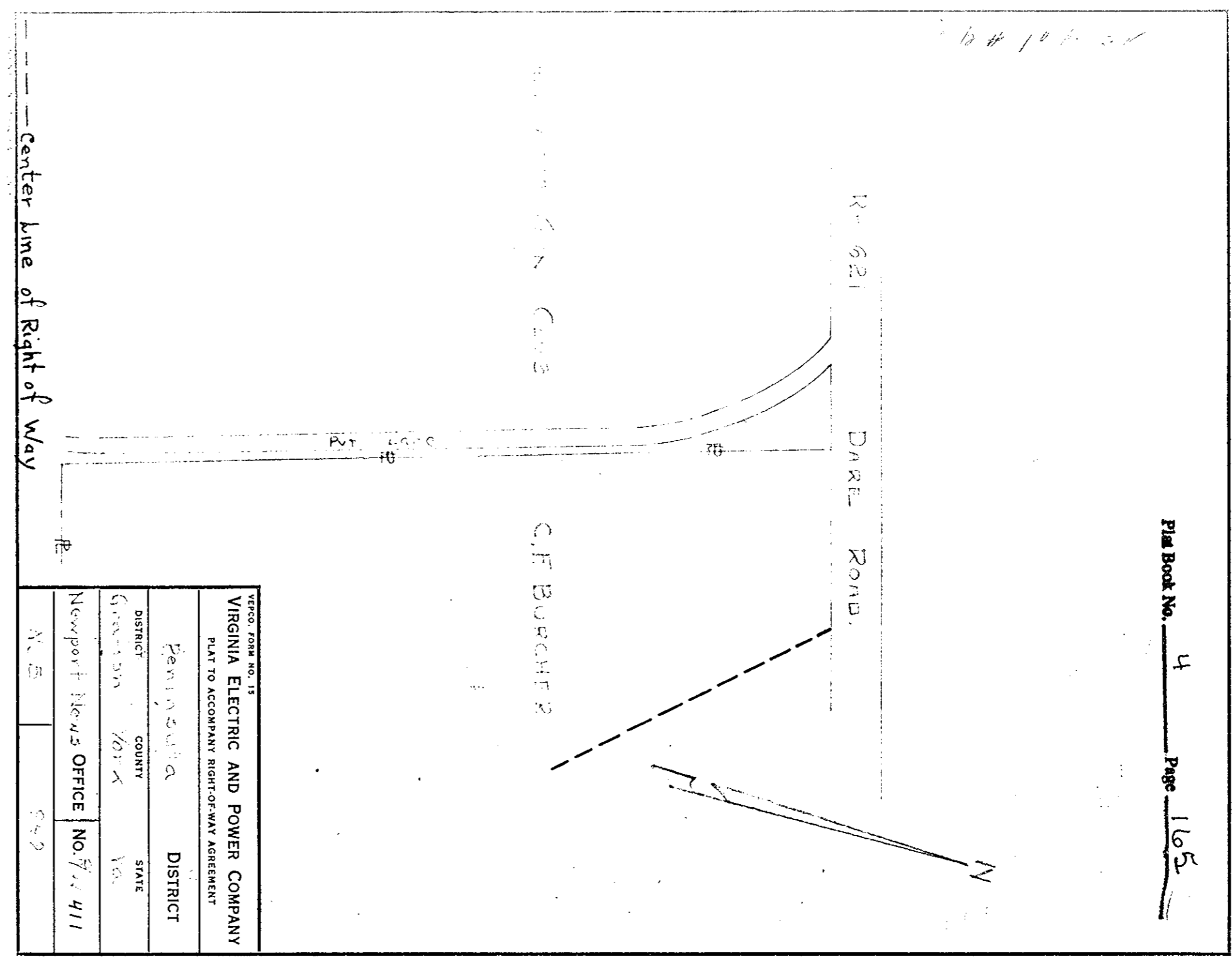

Plan Book No. 4 Page 165

VIRGINIA FORM NO. 13	
VIRGINIA ELECTRIC AND POWER COMPANY	
PLAT TO ACCOMPANY RIGHT-OF-WAY AGREEMENT	
DISTRICT	PENINSULAR
COUNTY	GLAUCOUSTON
STATE	VA.
NEWPORT NEWS OFFICE	NO. 5711 411
N. S.	549

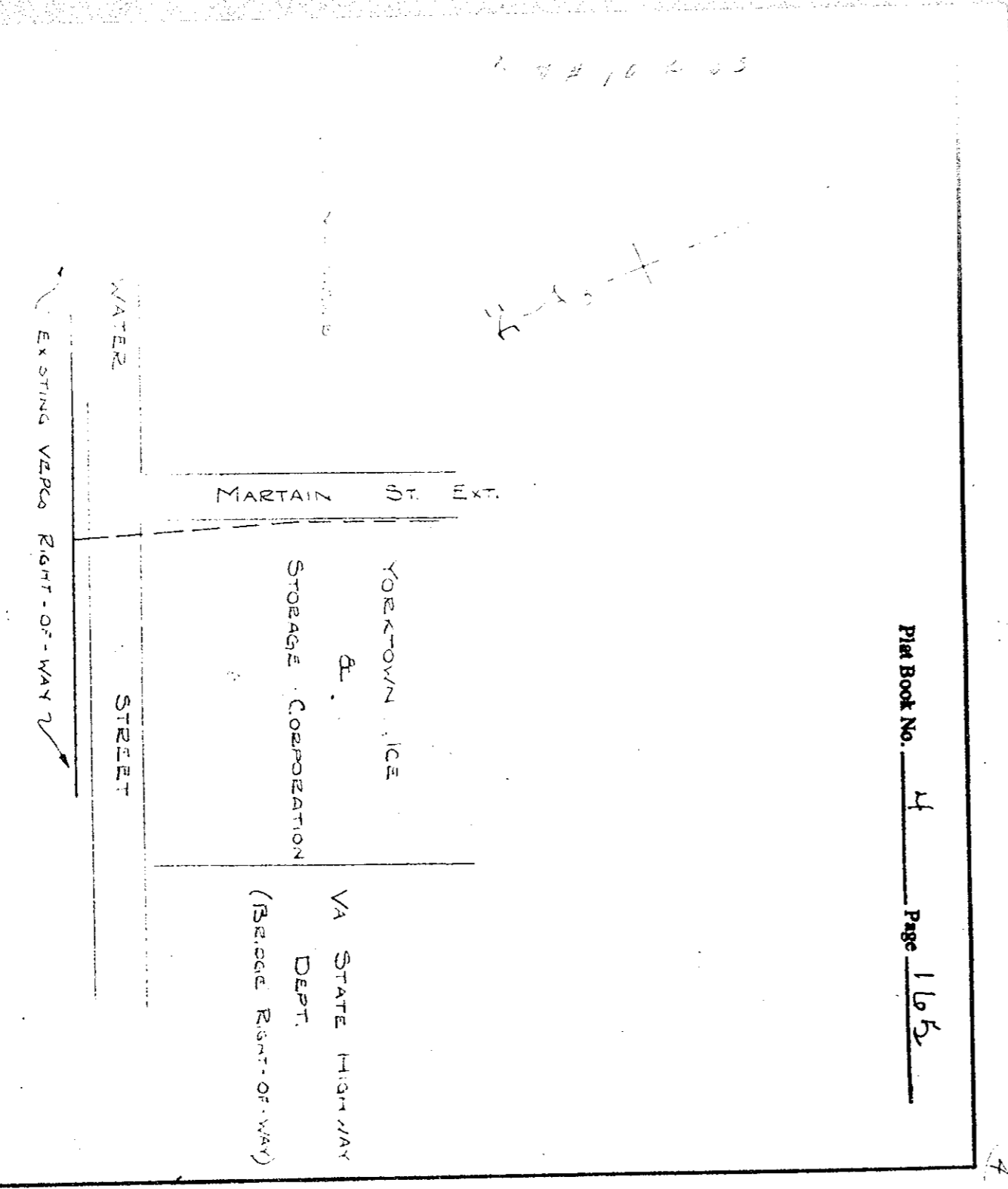

Plan Book No. 4 Page 165

VIRGINIA FORM NO. 13	
VIRGINIA ELECTRIC AND POWER COMPANY	
PLAT TO ACCOMPANY RIGHT-OF-WAY AGREEMENT	
DISTRICT	PENINSULAR
COUNTY	GLAUCOUSTON
STATE	VA.
OFFICE	WILLIAMSBURG
OFFICE NO.	E/W 12
DATE	5/13/50
DATE	5/1950

Plan Book No. 4 Page 165