

SUBDIVISION PLAT OF
SKIMINO LANDING ESTATES
PHASE II-A

BRUTON DISTRICT
COUNTY OF YORK, VIRGINIA
DATE: OCTOBER 13, 1998



Committed to Excellence

ENGINEERS • ARCHITECTS • SURVEYORS

1006 RICHMOND ROAD, P.O. BOX 3505 WILLIAMSBURG, VIRGINIA 23187
(757)253-0673 FAX: (757)253-2319 E-MAIL: djginc@visi.net
NORFOLK - VIRGINIA BEACH AREA (757)874-5015

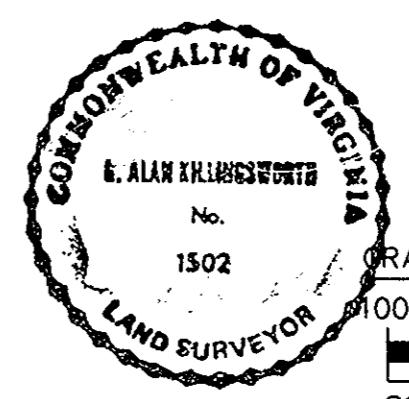

SHEET 4 OF 4

JOB NO. 1941120

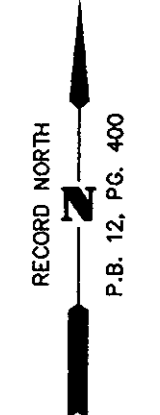
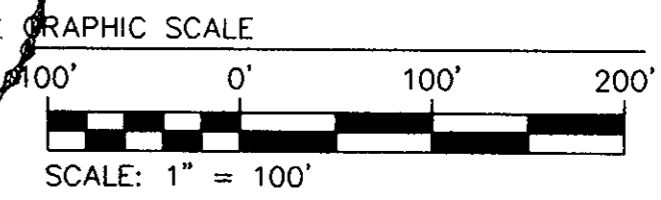

EASEMENT LINE DATA TABLE

NUMBER	DIRECTION	DISTANCE
*T19	N 61°33'40" W	148.17'
*T20	N 26°29'25" E	15.01'
*T21	S 61°33'40" E	151.19'
*T22	N 59°54'01" E	275.82'
*T23	S 55°45'56" E	20.00'
*T24	S 27°38'14" W	138.76'
*T25	S 03°05'07" E	31.17'
*T26	S 80°03'49" W	194.48'
*T27	N 62°09'28" W	123.93'
*T40	S 33°23'19" W	25.76'
*T41	S 61°42'22" W	85.34'
*T42	N 40°19'39" W	17.16'
*T43	N 61°42'22" E	82.20'
*T44	N 33°23'19" E	27.75'

EASEMENT LINE DATA TABLE

NUMBER	DIRECTION	DISTANCE
*T48	N 31°46'01" W	105.82'
*T49	S 31°46'01" E	103.03'
*T50	S 40°19'39" E	11.58'
*T51	N 29°19'39" W	137.38'
*T52	S 29°19'39" E	127.66'
*T53	N 41°59'14" W	16.38'
*T54	N 12°33'53" W	55.18'
*T55	N 21°55'39" W	20.20'
*T56	S 21°55'39" E	14.77'
*T57	S 12°33'53" E	52.47'
*T58	S 41°59'14" E	33.43'

EASEMENT CURVE DATA TABLE

NUMBER	DELTA	RADIUS	LENGTH	TANGENT	CHORD	CHORD BEARING
*C80	01°08'49"	764.37	15.30	7.65	15.30	S 39°49'51" W
*C81	07°50'21"	236.25	32.32	16.19	32.30	S 44°10'52" W
*C83	12°03'50"	450.00	94.75	47.55	94.57	S 85°12'44" E
*C84	03°17'07"	450.00	25.80	12.90	25.80	S 77°32'15" E
*C85	20°18'00"	35.00	12.40	6.27	12.34	S 73°04'39" E
*C86	35°04'55"	35.00	21.43	11.06	21.10	N 79°13'54" E
*C87	05°16'45"	35.00	3.22	1.61	3.22	S 36°50'02" W
*C88	04°20'30"	154.94	11.74	5.87	11.74	S 32°01'28" W
*C89	21°07'37"	155.00	57.15	28.91	56.83	S 19°17'27" W

APPROVED
YORK COUNTY BOARD OF SUPERVISORS

BY: John T. Quinn, PE
PLAT APPROVING AGENT

DATE: 11-23-98

STATE OF VIRGINIA
COUNTY OF YORK

IN THE CLERK'S OFFICE OF THE CIRCUIT COURT FOR THE COUNTY OF YORK THE 23rd DAY OF Nov, 1998 THIS MAP WAS PRESENTED AND ADMITTED TO RECORD AS THE LAW DIRECTS IN PLAT BOOK 122 PAGE 649.

TESTE: Nancy B. Kane
CLERK

BY: Carol D. Roselmin, Deputy Clerk

