

HAMPTON ROADS DISTRICT SIGN UNIT

DESIGNED BY: CHELSEY STANKAN, 07/27/05, 3030  
CHECKED BY: JEFFREY STANKAN, 07/27/05, 3030  
CADD OPERATOR: JEFFREY STANKAN, 07/27/05, 3030  
REVISED BY:

2/14/2005 10:06:46

Design File - C:\Documents and Settings\jstankan\My Documents\Projects\0620-099-176\0620-099-176.dwg  
Level: 01 - 1:100  
Level: 02 - 1:500  
Level: 03 - 1:100  
Level: 04 - 1:100  
Level: 05 - 1:100  
Level: 06 - 1:100  
Level: 07 - 1:100  
Level: 08 - 1:100  
Level: 09 - 1:100  
Level: 10 - 1:100

- Note 1: See General Notes For Erosion & Siltation Legend.
- Note 2: Figures in parenthesis and dot-dot-dashed lines denote temporary easements.
- Note 3: Figures in brackets and dot-dashed lines denote permanent easements.
- Note 4: Figures in double brackets and dot-dashed lines denote utility easements.
- Note 5: [Symbol] Denotes Construction Limits In Cuts  
[Symbol] Denotes Construction Limits In Fills
- Note 6: [Symbol] For drainage descriptions see sheets 2D thru 2Dx31.
- Note 7: All existing pipe and structure are to be used unless otherwise noted.
- Note 8: Pavement markings shown on this plan sheet are for schematic purposes only. See sheet [ ] for typical pavement markings for bicycle lanes.

- Note 9: [Symbol] Denotes demolition of pavement.
- Note 10: Suitable transition to existing pavement to be provided if found necessary as directed by the engineer.
- Note 11: [Symbol] Denotes 3.048M easement required for Verizon Virginia Inc.

DESIGN FEATURES RELATING TO CONSTRUCTION OR TO REGULATION AND CONTROL OF TRAFFIC MAY BE SUBJECT TO CHANGE AS DEEMED NECESSARY BY THE DEPARTMENT

ROUTE	STATE	FEDERAL AID PROJECT	ROUTE	STATE	PROJECT
620	VA		620	VA	0620-099-176, RW-201 C-501

THESE PLANS ARE UNFINISHED AND ARE NOT TO BE USED FOR ANY TYPE OF CONSTRUCTION.

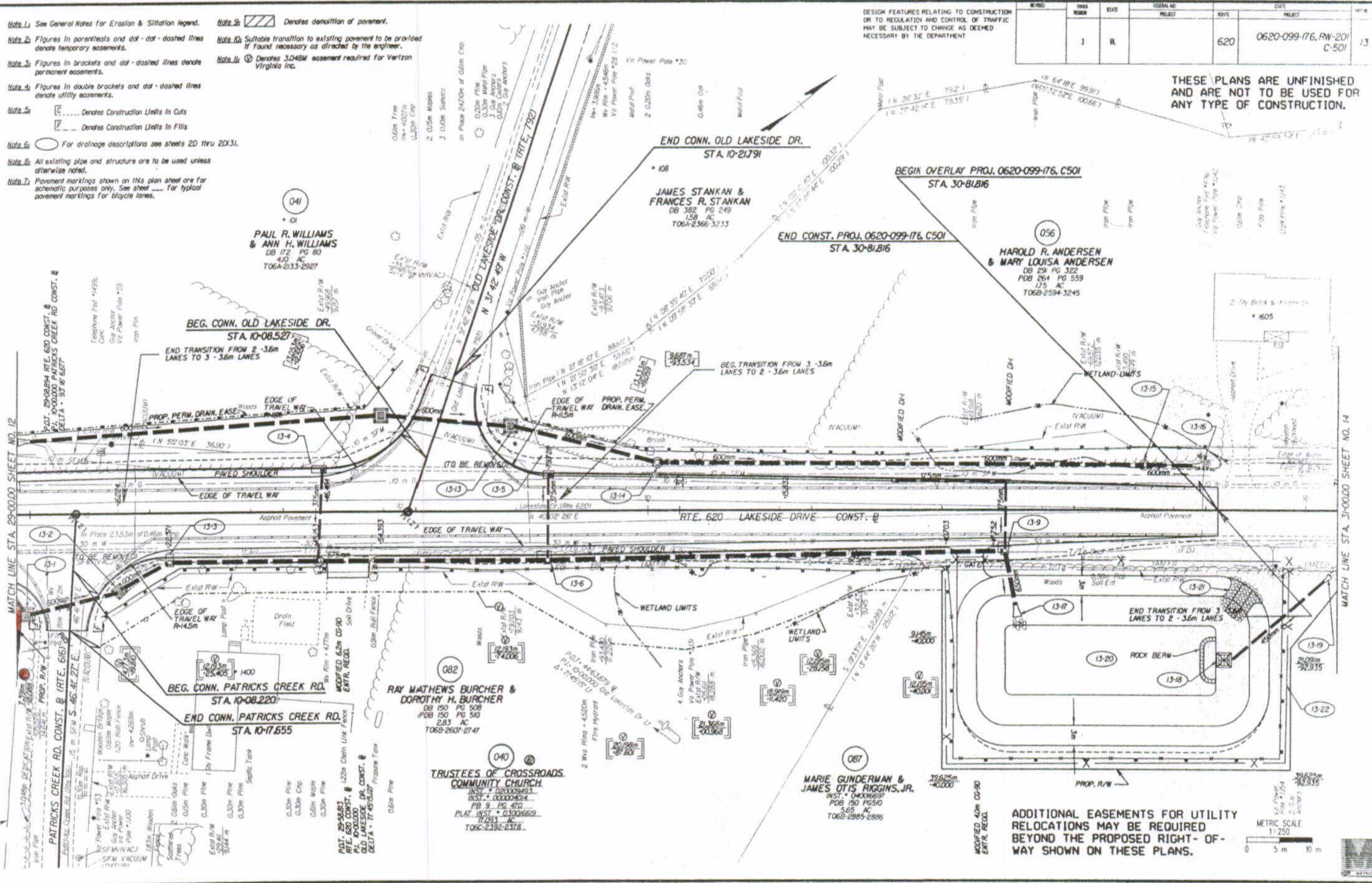

ADDITIONAL EASEMENTS FOR UTILITY RELOCATIONS MAY BE REQUIRED BEYOND THE PROPOSED RIGHT-OF-WAY SHOWN ON THESE PLANS.

METRIC SCALE 1:250  
0 5 m 10 m