

VICINITY MAP  
SCALE: 1" = 2,000'

- PRIMARY U.S. GEODETIC CONTROL MONUMENTS
- (118) - COORDINATES—U.S.SURVEY FEET—12093296.742(E), 3570788.165(N).
  - (119) - COORDINATES—U.S.SURVEY FEET—12097204.377(E), 3569944.967(N).

THE PLATTING OF THE LAND HEREON SHOWN IS WITH THE FREE CONSENT AND IN ACCORDANCE WITH THE DESIRES OF THE UNDERSIGNED OWNERS, PROPRIETORS, AND TRUSTEES, IF ANY.

DATE: 8/30/06  
KENNETH L. ALLEN, MEMBER  
CARYS CHAPEL, L.L.C., A VIRGINIA LIMITED LIABILITY COMPANY

DATE: 8/30/06  
BY: Kevin E. Kelly  
KEVIN E. KELLY, VICE PRESIDENT  
FOR RBC CENTURA BANK, A NORTH CAROLINA BANKING CORPORATION (BENEFICIARY) BY DEED DATED: FEBRUARY 8, 2005 - INSTRUMENT #050002496

DATE: 8/30/06  
BY: Kevin E. Kelly  
KEVIN E. KELLY, VICE PRESIDENT  
FOR CB SERVICES CORPORATION, A VIRGINIA CORPORATION (TRUSTEE) BY DEED DATED: FEBRUARY 8, 2005 - INSTRUMENT #050002496

TO THE BEST OF MY KNOWLEDGE AND BELIEF, ALL THE REQUIREMENTS SET FORTH IN THE ORDINANCE FOR APPROVING PLATS OF SUBDIVISION IN THE COUNTY OF YORK, VIRGINIA HAVE BEEN COMPLIED WITH, INCLUDING A CLOSURE OF NOT LESS THAN 1 1/20,000'. THIS IS TO CERTIFY THAT THE LAND EMBRACED IN THIS SUBDIVISION IS IN THE NAME OF: CARYS CHAPEL, L.L.C., A VIRGINIA LIMITED LIABILITY COMPANY, AND WAS ACQUIRED FROM RUSSELL B. HOPSON AND SANDRA H. CASTINE, AS CO-TRUSTEES OF THE EVA L. HOPSON DECLARATION OF TRUST, DATED FEBRUARY 7, 1997, BY DEED DATED JANUARY 27, 2005 AND DULY RECORDED IN THE CLERKS OFFICE OF THE CIRCUIT COURT OF YORK COUNTY-POQUOSON, VIRGINIA AS INSTRUMENT #050002495.

I CERTIFY THAT MONUMENTS AND IRON RODS AS SHOWN ON THIS PLAT WILL BE SET ON OR BEFORE 30 SEPT. 2007.  
R. L. SMALL  
DATE: 6/6/06

UTILITY NOTES:  
WATER: EACH LOT WITHIN THIS SUBDIVISION IS SERVED BY PUBLIC WATER PROVIDED BY THE CITY OF NEWPORT NEWS, VA.  
SEWER: EACH LOT WITHIN THIS SUBDIVISION IS SERVED BY PUBLIC SEWER PROVIDED BY COUNTY OF YORK, VA.

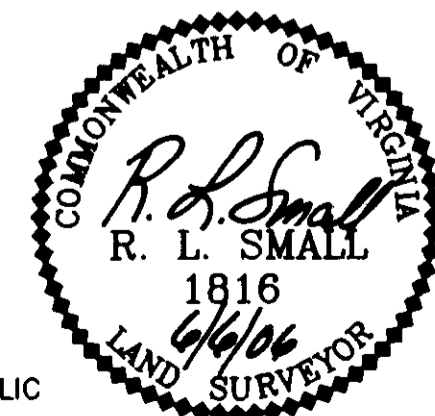

NOTARY PUBLIC FOR OWNERS  
STATE OF VIRGINIA TO WIT:  
I, Francis B. Barb, A NOTARY PUBLIC IN AND FOR THE STATE OF Virginia DO HEREBY CERTIFY THAT THE ABOVE NAMED PERSONS WHOSE NAMES ARE SIGNED TO THE FOREGOING WRITING HAVE ACKNOWLEDGED THE SAME BEFORE ME IN MY JURISDICTION AFORESAID, GIVEN UNDER MY HAND THIS 30 DAY OF August, 2006  
Francis B. Barb  
NOTARY PUBLIC  
MY COMMISSION EXPIRES: 11-30-06

NOTARY PUBLIC FOR BENEFICIARY  
STATE OF VIRGINIA TO WIT:  
I, Francis B. Barb, A NOTARY PUBLIC IN AND FOR THE STATE OF Virginia DO HEREBY CERTIFY THAT THE ABOVE NAMED PERSONS WHOSE NAMES ARE SIGNED TO THE FOREGOING WRITING HAVE ACKNOWLEDGED THE SAME BEFORE ME IN MY JURISDICTION AFORESAID, GIVEN UNDER MY HAND THIS 30 DAY OF August, 2006  
Francis B. Barb  
NOTARY PUBLIC  
MY COMMISSION EXPIRES: 11-30-06

NOTARY PUBLIC FOR TRUSTEE  
STATE OF VIRGINIA TO WIT:  
I, Francis B. Barb, A NOTARY PUBLIC IN AND FOR THE STATE OF Virginia DO HEREBY CERTIFY THAT THE ABOVE NAMED PERSONS WHOSE NAMES ARE SIGNED TO THE FOREGOING WRITING HAVE ACKNOWLEDGED THE SAME BEFORE ME IN MY JURISDICTION AFORESAID, GIVEN UNDER MY HAND THIS 30 DAY OF August, 2006  
Francis B. Barb  
NOTARY PUBLIC  
MY COMMISSION EXPIRES: 11-30-06

CURVE DATA TABLE						
NUMBER	DELTA ANGLE	RADIUS	ARC LENGTH	TANGENT	CHORD LENGTH	CHORD DIRECTION
C1	79°30'13"	275.00	381.59	228.73	351.70	S 15°43'15" E
C2	98°12'39"	325.00	557.08	375.26	491.34	N 25°04'28" W
C3	89°19'33"	25.00	38.98	24.71	35.15	S 79°51'52" W
C4	250°37'07"	60.00	262.43	84.71	97.93	S 19°29'21" E
C5	13°40'45"	300.00	71.62	35.98	71.45	S 30°52'14" W
C6	98°12'39"	300.00	514.23	346.40	453.55	S 25°04'28" E

LOT AREA : 3.8996 ACRES OR 169,868 S.F.  
R/W AREA : 0.7993 ACRE OR 34,819 S.F.  
COMMON AREA : 3.8216 ACRES OR 166,467 S.F.  
TOTAL SUBDIVIDED AREA : 8.5205 ACRES OR 371,154 S.F.

NOTES:

- THE PROPERTY SHOWN HEREON IS LOCATED IN ZONE X AS SHOWN ON FLOOD INSURANCE RATE MAP COMMUNITY PANEL NUMBER 510182 0041 B EFFECTIVE DATE: DECEMBER 16, 1988.
- MINIMUM BUILDING SETBACK REQUIREMENTS:  
FRONT: 30' (FEET)  
SIDE: 10' (FEET)  
REAR: 20' (FEET)
- PROPERTY IS ZONED R20 (SINGLE FAMILY RESIDENTIAL DISTRICT)
- TAX MAP PARCEL #: 38-00-00-071A
- GPIN#: V03B-3147-2921
- ALL STREETS ARE HEREBY DEDICATED FOR PUBLIC USE.
- ALL "COMMON AREAS" ARE TO BE CONVEYED TO THE WOODS OF TABB HOMEOWNERS ASSOCIATION.
- THE VIRGINIA DEPARTMENT OF TRANSPORTATION AND YORK COUNTY SHALL BE SAVED HARMLESS FROM ANY MAINTENANCE RESPONSIBILITY OR LIABILITY ASSOCIATED WITH THE STORMWATER MANAGEMENT BASINS AND THEIR OUTFLOW STRUCTURES, TO THE EXTENT ALLOWED BY THE LAW.
- THE RECORDATION OF THIS PLAT SHALL OPERATE TO TRANSFER, IN FEE SIMPLE, TO THE COUNTY OF YORK SUCH PORTION OF THE PREMISES PLATTED AS IS ON THE PLAT SET APART FOR STREETS, ALLEYS OR OTHER PUBLIC USE AND TO TRANSFER TO THE COUNTY OF YORK ANY EASEMENT INDICATED ON THE PLAT FOR DRAINAGE AND/OR SANITARY SEWER TO CREATE A PUBLIC RIGHT-OF-PASSAGE OVER THE SAME, UNLESS OTHERWISE NOTED ON THIS PLAT.
- DRAINAGE AND UTILITY EASEMENTS CONVEYED TO THE COUNTY BY RECORDATION OF THIS PLAT SHALL BE EXCLUSIVE TO THE COUNTY, UNLESS OTHERWISE NOTED. CONVEYANCE OF SUCH EASEMENTS TO THE COUNTY ALSO INCLUDE (i) THE RIGHT OF INGRESS AND EGRESS OVER THE OWNERS LAND ADJACENT TO THE EASEMENT AS NECESSARY TO INSPECT, MAINTAIN AND OPERATE THE COUNTY'S FACILITIES WITHIN THE EASEMENT AND (ii) THE RIGHT OF THE COUNTY TO ASSIGN TO OTHERS FROM TIME TO TIME THE RIGHT TO LOCATE FACILITIES THEREIN SERVING THE PUBLIC, INCLUDING, BUT NOT LIMITED TO, WATER, ELECTRIC, TELEPHONE, COMMUNICATIONS, AND GAS UTILITY FACILITIES.
- THIS SUBDIVISION IS AN OPEN SPACE CLUSTER DEVELOPMENT PURSUANT TO THE PROVISIONS OF SECTION 24.1-402 OF THE YORK COUNTY ZONING ORDINANCE.
- NONE OF THE AREA CONTAINED IN THIS SUBDIVISION IS WITHIN A RESOURCE PROTECTION AREA OR RESOURCE MANAGEMENT AREA.

THIS PLAT HAS BEEN REVIEWED AND APPROVED FOR THE ISSUANCE OF A COMMERCIAL ENTRANCE PERMIT. DRAINAGE, IF GENERATED TO THE EXISTING PUBLIC RIGHT-OF-WAY, IS DEEMED ACCEPTABLE. THE STREETS DEPICTED HEREON ARE ELIGIBLE FOR V.D.O.T. MAINTENANCE AT SUCH TIME AS ALL APPLICABLE PROVISIONS GOVERNING PUBLIC USE AND THE CONSTRUCTION OF THE STREETS MEET THE PROVISIONS OF THE SUBDIVISION STREET REQUIREMENTS.

Alfred D. Dwyer 9/06/06  
VIRGINIA DEPARTMENT OF TRANSPORTATION DATE

SUBDIVISION PLAT OF  
**THE WOODS OF TABB**  
SECTION SEVEN  
BETHEL MAGISTERIAL DISTRICT  
COUNTY OF YORK, VIRGINIA  
SCALE: 1" = 60' DATE: 6 JUNE 2006  
**DAVIS & ASSOCIATES, P.C.**  
SURVEYORS - PLANNERS  
3630 GEORGE WASHINGTON  
MEMORIAL HIGHWAY - SUITE "G"  
YORKTOWN, VIRGINIA 23693  
Scale 1" = 60 ft  
SHEET 1 OF 2  
- S Y M B O L S -

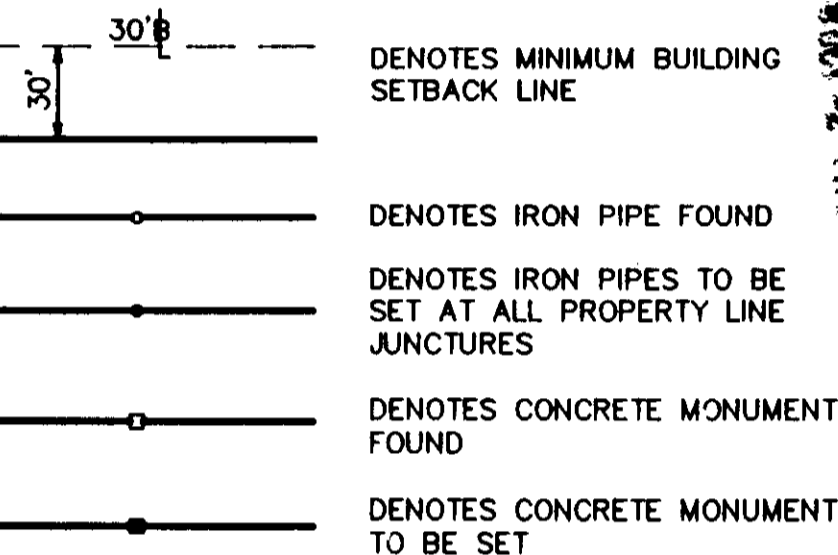

APPROVED  
YORK COUNTY BOARD OF SUPERVISORS  
BY: Alfred D. Dwyer  
PLAT APPROVING AGENT  
DATE: 9/29/06

STATE OF VIRGINIA  
COUNTY OF YORK  
IN THE CLERK'S OFFICE OF THE CIRCUIT COURT FOR THE COUNTY OF YORK-POQUOSON THE 2nd DAY OF Oct, 2006, THIS MAP WAS PRESENTED AND ADMITTED TO RECORD AS THE LAW DIRECTS AS INSTRUMENT # 06002424

TESTE: Lynn S. Jenkins 12:48 pm  
CLERK  
BY: Rodul P. P. P.