

SURVEYED BY - B.B. HARMON (15)1253-2537
 SUPERVISED BY - E.H. BRUM (15)1253-2557
 DESIGNED BY - M.D. WINSTEAD (15)1253-2556
 HAMPTON ROADS DISTRICT DESIGN UNIT

DESIGN FEATURES RELATING TO CONSTRUCTION OR TO REGULATION AND CONTROL OF TRAFFIC MAY BE SUBJECT TO CHANGE AS DEEMED NECESSARY BY THE DEPARTMENT

REVISED 12/09/05 02/06/06	STATE VA.	FEDERAL AID PROJECT	ROUTE 17	STATE PROJECT 6017-099-129, RW-201, C-501	SHEET NO. 15
---------------------------------	--------------	------------------------	-------------	---	-----------------

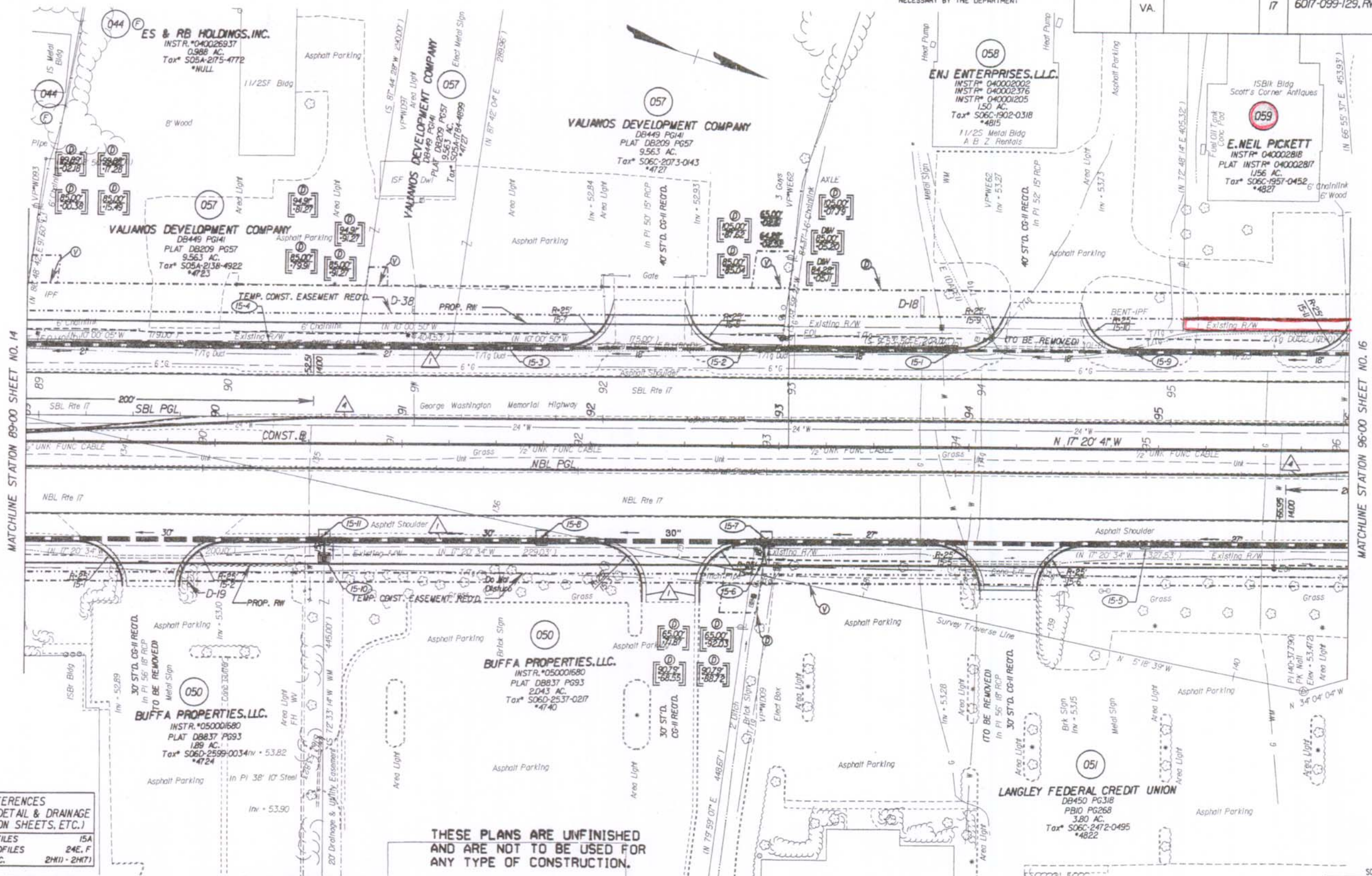

THESE PLANS ARE UNFINISHED AND ARE NOT TO BE USED FOR ANY TYPE OF CONSTRUCTION.

REFERENCES
(PROFILES, DETAIL & DRAINAGE DESCRIPTION SHEETS, ETC.)

MAINLINE PROFILES	15A
ENTRANCE PROFILES	24E, F
DRAINAGE DESC.	2H(1) - 2H(7)

NOTE: PGL DENOTES PROFILE GRADE LINE
 NOTE: SEE GENERAL NOTES FOR E&S LEGEND
 ○ DENOTES DRAINAGE STRUCTURE NUMBER

Note: Figures in brackets and dot-dashed lines denote Permanent Easements.
 (V) Denotes variable easement required for Verizon/Virginia
 (D) Denotes variable easement required for Dominion Virginia Power

Note: Figures in parentheses and dot-dot-dashed lines denote Temporary Easements.

(C) Denotes Construction Limits In Cuts
 (F) Denotes Construction Limits In Fills
 (1) ST'D. CG-7 RECD.
 (4) ST'D. MS-2 RECD.



PLAN NO.	PROJECT	FILE NO.	SHEET NO.
	6017-099-129		15

State Highway Plat Book No. 10 Page 61 doc # 070008494