

SURVEYED BY: B.B. HARRIS (152) 925-5131
 SUPERVISED BY: P.M. BYRUM (152) 925-2557
 DESIGNED BY: M.D. WINSTEAD (152) 925-2556
 HAMPTON ROADS DISTRICT DESIGN UNIT

DESIGN FEATURES RELATING TO CONSTRUCTION OR TO REGULATION AND CONTROL OF TRAFFIC MAY BE SUBJECT TO CHANGE AS DEEMED NECESSARY BY THE DEPARTMENT

REVISED	STATE	FEDERAL AID	ROUTE	PROJECT	SHEET NO.
02/06/06 03/23/06 06/08/06 08/10/06	VA.		17	6017-099-129, RW-201, C-501	11

REFERENCES
 (PROFILES, DETAIL & DRAINAGE DESCRIPTION SHEETS, ETC.)

MAINLINE PROFILES 11A
 ENTRANCE PROFILES 24C, D
 DRAINAGE DESC. 2H11 - 2H71
 CROSS-OVER DETAIL 2E

THESE PLANS ARE UNFINISHED AND ARE NOT TO BE USED FOR ANY TYPE OF CONSTRUCTION.

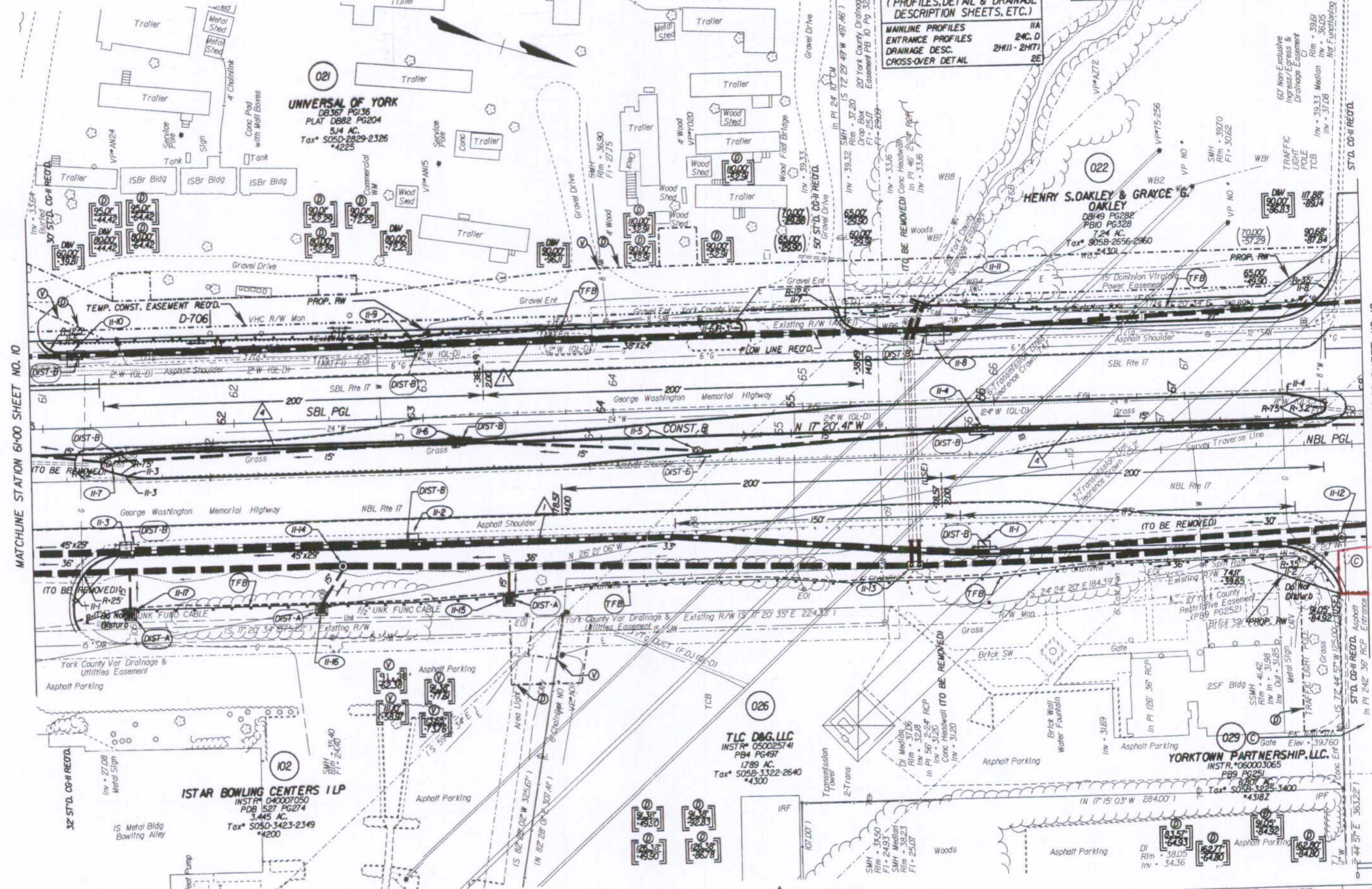

MATCHLINE STATION 6+00 SHEET NO. 10

MATCHLINE STATION 68+00 SHEET NO. 12

NOTE: PGL DENOTES PROFILE GRADE LINE
 NOTE: SEE GENERAL NOTES FOR E&S LEGEND
 ○ DENOTES DRAINAGE STRUCTURE NUMBER

Note: Figures in brackets and dot-dashed lines denote Permanent Easements.
 V Denotes variable easement required for Verizon Virginia
 ○ Denotes variable easement required for Dominion Virginia Power

Note: Figures in parentheses and dot-dashed lines denote Temporary Easements.

--- Denotes Construction Limits in Cuts
 --- Denotes Construction Limits in Fills

▲ ST'D. CG-7 RECD.
 ▲ ST'D. MS-2 RECD.

SCALE
 0 25' 50'

PLAN NO.	PROJECT	FILE NO.	SHEET NO.
	6017-099-129		11

State Highway Plat Book No. 10 Page 154

2/20/2007 10:57:43