

THESE PLANS ARE UNFINISHED AND ARE NOT TO BE USED FOR ANY TYPE OF CONSTRUCTION.

SURVEYED BY: BOB HARMON (757) 253-9371
 SUPERVISED BY: P.H. BURM (757) 925-2557
 DESIGNED BY: M.D. WINSTEAD (757) 925-2556
 HAMPTON ROADS DISTRICT DESIGN UNIT

DESIGN FEATURES RELATING TO CONSTRUCTION OR TO REGULATION AND CONTROL OF TRAFFIC MAY BE SUBJECT TO CHANGE AS DEEMED NECESSARY BY THE DEPARTMENT

REVISED	STATE	FEDERAL AID PROJECT	ROUTE	STATE PROJECT	SHEET NO.
12/09/05 02/06/06 03/23/06 06/08/06 05/29/07 09/13/07	VA.		17	6017-099-129, RW-201, C-501	13

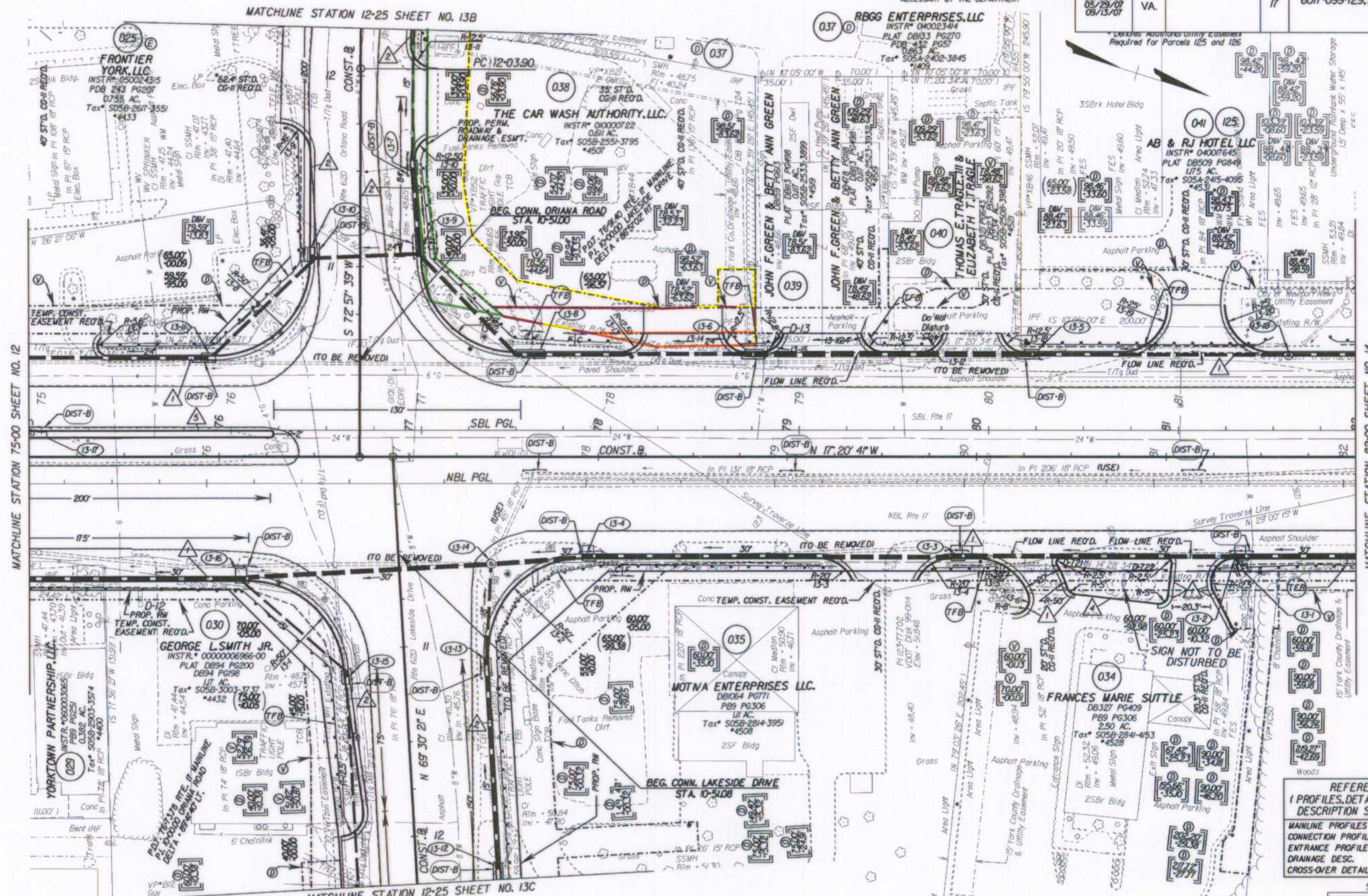

REFERENCES
 (PROFILES, DETAIL & DRAINAGE DESCRIPTION SHEETS, ETC.)

MAINLINE PROFILES	13A
CONNECTION PROFILES	13D
ENTRANCE PROFILES	24D, E, I, J
DRAINAGE DESC.	2H11 - 2H71
CROSS-OVER DETAIL	2E

NOTE: PGL DENOTES PROFILE GRADE LINE
 NOTE: SEE GENERAL NOTES FOR E&S LEGEND
 DENOTES DRAINAGE STRUCTURE NUMBER

NOTE: Figures in brackets and dot-dashed lines denote Permanent Easements.
 Denotes variable easement required for Verizon Virginia
 Denotes variable easement required for Dominion Virginia Power

NOTE: Figures in parenthesis and dot-dot-dashed lines denote Temporary Easements.

Denotes Construction Limits in Cuts
 Denotes Construction Limits in Fills

1 ST'D. CG-7 REQ'D.
 2 ST'D. CG-6 REQ'D.
 3 ST'D. MS-1A REQ'D.
 4 ST'D. CG-3 REQ'D.

PLAN NO. 6017-099-129 PROJECT FILE NO. SHEET NO. 13

State Hwy Plat Book # 10 P# 186
 L R 070025793

9/14/2007 08:56:5