

① NOW OR FORMERLY
LEBANON CHRISTIAN CHURCH
(INST. #0000170241) NN
(DB. 17, PG. 241) CITY OF WARWICK-NN
(DB. 61, PG. 131) WARWICK COUNTY-NN
(INST. #09000860) NN (PLAT)
TAX PARCEL 005000101, 005000158
& 005000159

② NOW OR FORMERLY
RUNNYMEDE CORP.
(INST. #0010301717) NN
(D.B. 1165, PG. 614) NN
(D.B. 1030, PG. 1717)
(D.B. 677, PG. 90)
TAX PARCEL 008000202

③ NOW OR FORMERLY ECONOMIC DEVELOPMENT
AUTHORITY OF THE CITY OF NEWPORT NEWS
(D.B. 1405, PG. 695) NN
(D.B. 1458, PG. 1665) NN
(D.B. 1048, PG. 1774) NN
TAX PARCEL 005000136

④ NOW OR FORMERLY
ECONOMIC DEVELOPMENT AUTHORITY OF THE
CITY OF NEWPORT NEWS
(INST. #0014581665) NN
TAX PARCEL 005000136

⑤ NOW OR FORMERLY
CITY OF NEWPORT NEWS
(INST. #0015120473) NN
TAX PARCEL 005000134

MATCH LINE SEE SHEET 6

MATCH LINE SEE SHEET 23

ENLARGED VIEW 'B'
SEE SHEET 25

PROPERTY OF THE
UNITED STATES OF AMERICA
NAVAL WEAPONS STATION YORKTOWN
(D.B. 76, PG. 245) Y

ENLARGED VIEW
THIS SHEET

END FENCE
1.6' INSIDE

VIRGINIA STATE PLANE COORDINATE SYSTEM
SOUTH ZONE (NAD 1983/2011)

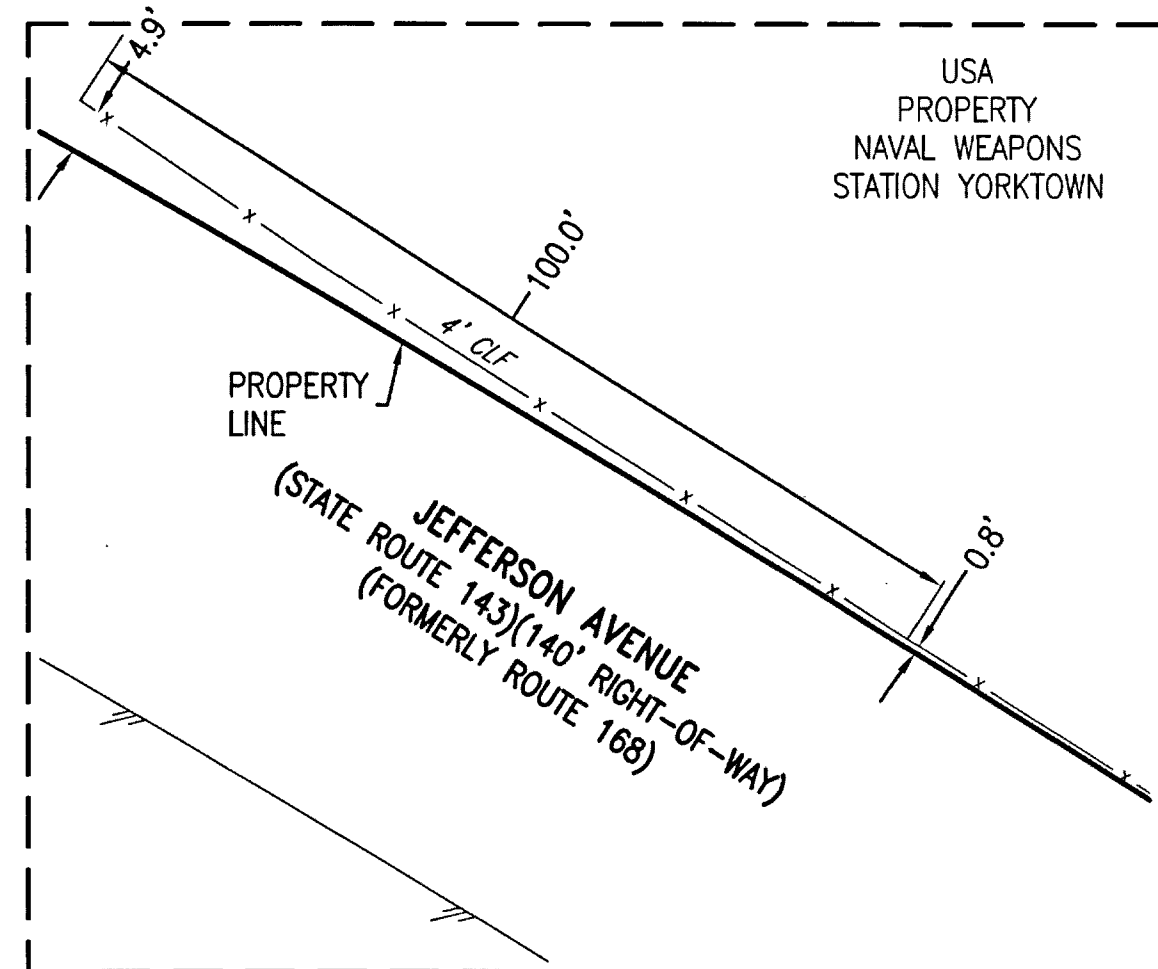

- CONCRETE MONUMENT FOUND (FND.) UNLESS OTHERWISE NOTED
- IRON PIN FOUND (FND.) UNLESS OTHERWISE NOTED
- MONUMENT (NOT SET)
- SET MONUMENT (S) (REFER TO SURVEY NOTE 6)

170021343

VIRGINIA:
IN THE CLERK'S OFFICE OF THE CIRCUIT COURT OF THE COUNTY OF,
ON THE 10th DAY OF November, 2017, THIS PLAT WAS RECEIVED AND
ADMITTED TO RECORD IN MAP BOOK _____ AT PAGE _____

TESTE: KRISTEN H. NELSON, CLERK
CLERK OF THE CIRCUIT COURT

Sammy Aguirre

GRAPHIC SCALE

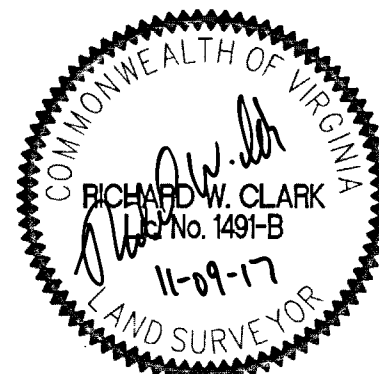
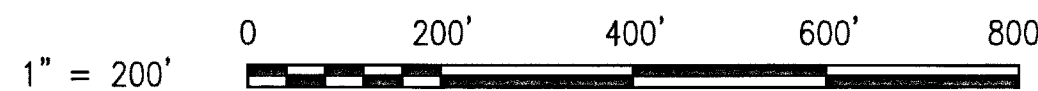

BAMFORTH
ENGINEERS + SURVEYORS, INC.
2207 HAMPTON BLVD.
NORFOLK, VIRGINIA 23517
(757) 627-7079



DEPARTMENT OF THE NAVY
NAVAL FACILITIES ENGINEERING COMMAND
9324 VIRGINIA AVENUE, ROOM #217
NORFOLK, VIRGINIA 23511-3095

CONTRACT No: N40085-10-D-5304-0035
RPSUID No.: 215
ePROJ. MASTER W.O. No: 1297187
ePROJ. W.O. No: 1592409
ePROJ. FILE SEQ. No: 10193

BY: CAD	FIELD BK: N69212	UIC: N69212	SA:	BL: AM1	PL: AM12	DWG DATE: NOVEMBER 9, 2017
CHECKED: REC	FIELD SURVEY DATE: MARCH 2014	NAVFAC DRAW No: 12760298	SCALE: 1" = 200'	SHEET 5 OF 30		REV:
APPROVED: CAB	DIGITAL DWG FILE: D-N69212-CAD-10139-05	DWG FILE NO: D-N69212-CAD-10139-05				

- A ROAD EASEMENT (D.B. 1108, P.340) NN
- B 10' C&P EASEMENT (D.B. 1046, P. 403) NN
- C 30' VEPCO EASEMENT (D.B. 1051, P.403) NN
- D VARIABLE WIDTH CITY OF NEWPORT NEWS WATERLINE EASEMENT (NO RECORDATION DATA AVAILABLE)
- E ROAD EASEMENT (D.B. 441, P.376) NN (DPWD DWG. #NO. 59317) STATE HWY PROJECT NO. 1289F
- F NAVY MINE DEPOT RAILROAD RIGHT-OF-WAY (200' R) (DPWD DRAWING #NO. 30736) (DPWD DRAWING #NO. 27909)
- G RIGHT-OF-WAY AS INDICATED ON PLAT (D.B. 1048, P. 1774)
- H NAVY MINE DEPOT RAILROAD RIGHT OF WAY (100' R/W)