

Instrument # 200012743

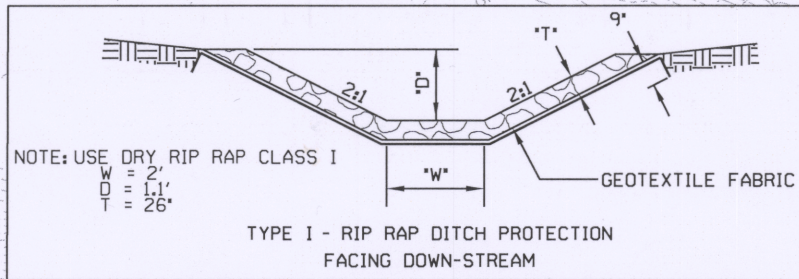

PROJECT MANAGER Janet Hedrick, P.E. - VDOT Hampton Roads District - (757)494-5478
SURVEYED BY, Dewberry Engineers Inc., 2/18
DESIGNED BY Dewberry Engineers Inc. - (703) 289-4796
SUBSURFACE UTILITY BY, Accumark, Inc., 3/18

BILLY J SR & JOYCE D BOUTWELL
INST #100017308
GPIN B21d-3510-1020
11.62 AC.



		REVISION	STATE	ROUTE	STATE PROJECT	SHEET NO.
		Steven Kuntz 2018.11.25 17:32:43 -05'00' Dewberry Engineers Inc. Fairfax, Virginia HYDRAULIC ENGINEER	Steven Kuntz 2018.11.25 17:32:50 -05'00' Dewberry Engineers Inc. Fairfax, Virginia ROADWAY ENGINEER	VA.	64	0064-965-229 R-201,C-501

DESIGN FEATURES RELATING TO CONSTRUCTION OR TO REGULATION AND CONTROL OF TRAFFIC MAY BE SUBJECT TO CHANGE AS DEEMED NECESSARY BY THE DEPARTMENT

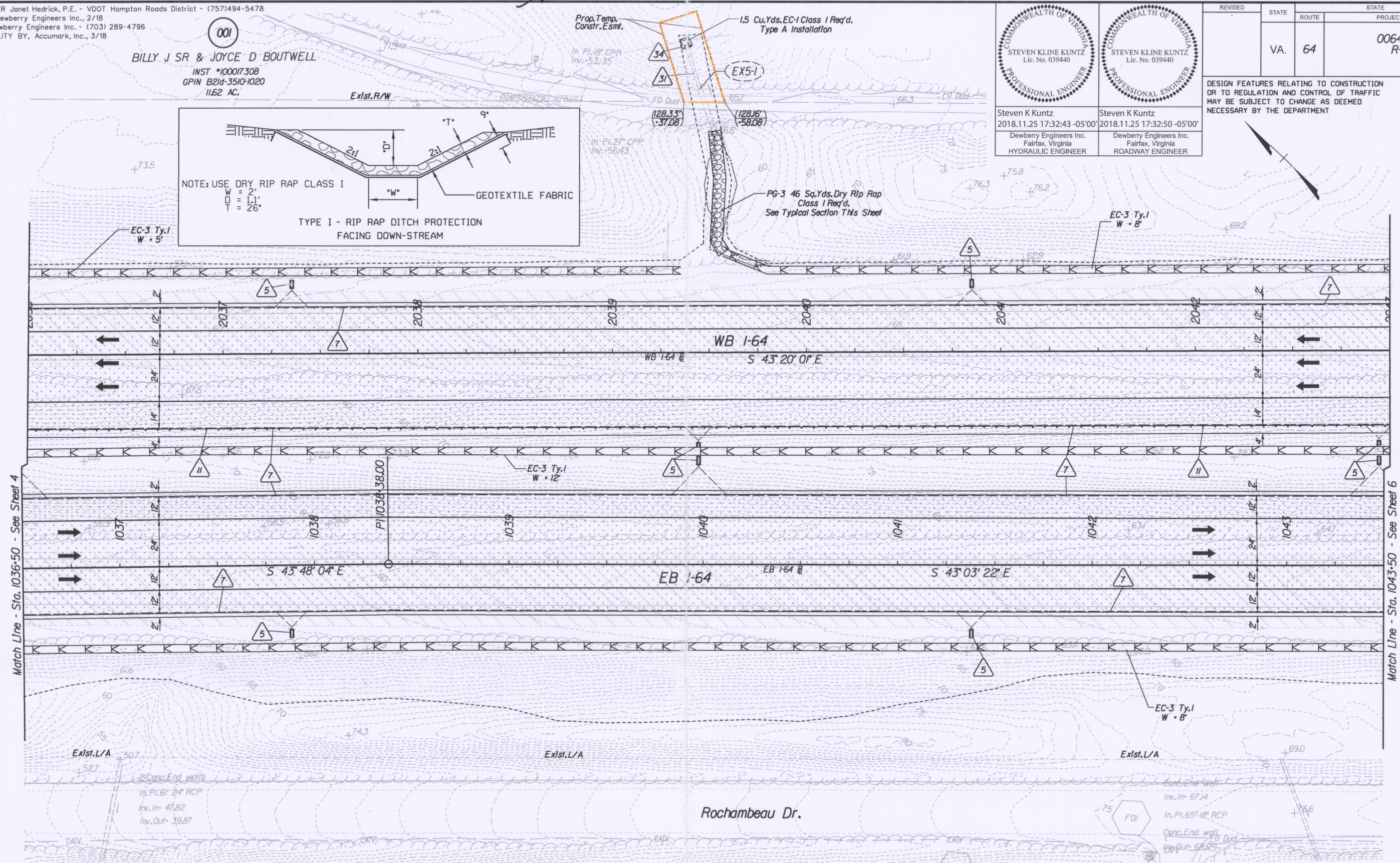

Key Legend

- | | | | |
|--|---|---|---|
| 1 4' Curb, S'd, CG-3 Req'd. | 13 Guardrail Terminal, S'd, GR-MGS2 Req'd. | 26 Remove Exist. Structure | 38 Fixed Object Alt., S'd, GR-FOA-I Ty. I Req'd. |
| 2 Conc. Raised Median, S'd, MS-1A Req'd. | 14 Guardrail, S'd, GR-10, Type I Req'd. | 27 Remove Exist. Pipe | 39 Fixed Object Alt., S'd, GR-FOA-I Ty. II Req'd. |
| 3 Conc. Raised Median, S'd, MS-1A Req'd. | 15 Guardrail, S'd, GR-10, Type II Req'd. | 28 Remove Exist. Pole | |
| 4 Asphalt Concrete Curb, S'd, MC-3B Req'd. | 16 Guardrail, S'd, GR-10, Type III Req'd. | 29 Adj. Exist. Structure | |
| 5 Underdrain Endwall, S'd, EW-12 Req'd. | 17 Trailing End Terminal, S'd, GR-MGS3 Req'd. | 30 Clean Out Exist. Structure | |
| 6 Median Underdrain, S'd, UD-2 Req'd. | 18 Fixed Object Alt., S'd, GR-FOA-2 Ty. I Req'd. | 31 Clean Out Existing Pipe | |
| 7 Pavement Underdrain, S'd, UD-4 Req'd. | 19 Fixed Object Alt., S'd, GR-FOA-2 Ty. II Req'd. | 32 Pipe To Be Removed | |
| 8 Crossdrain, S'd, CD-1 Req'd. | 20 Guardrail, S'd, GR-MGS4 Req'd. | 33 Pipe To Be Abandoned and Plugged | |
| 9 Crossdrain, S'd, CD-2 Req'd. | 21 Conc. Median Barrier, S'd, MB-7D Req'd. | 34 Stone For Erosion Control, S'd, EC-I Class I Req'd. | |
| 10 VDOT Fence, S'd, FE-W2 Req'd. | 22 Conc. Median Barrier, S'd, MB-7F Req'd. | 35 Stone For Erosion Control, S'd, EC-I Class II Req'd. | |
| 11 Guardrail, S'd, GR-MGS1 Req'd. | 23 Bridge Piler Protection, BPPS-1 Req'd. | 36 Stone For Erosion Control, S'd, EC-I Class A Req'd. | |
| 12 Guardrail, S'd, GR-MGS1A Req'd. | 24 Remove Exist. Guardrail | 37 S'd, EC-3 Type B Outlet Protection Req'd. | |

- | | |
|--|-----------------------------|
| | Denotes Full Depth Pavement |
| | Denotes Pavement Demolition |
| | Denotes Pavement Overlay |
| | Denotes Milling and Overlay |
| | Denotes Gravel |

- | | |
|--|--------------------------------------|
| | Denotes Construction Limits In Cuts |
| | Denotes Construction Limits In Fills |

REFERENCES
(PROFILES, DETAIL & DRAINAGE DESCRIPTION SHEETS, ETC.)

Alignment Data	1G
Erosion & Sediment Control	2D
I-64 Profiles	5A
Drainage Descriptions	67
Storm Sewer Profiles	68
Ditch Tabulations	69

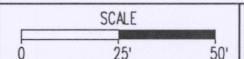

PROJECT	0064-965-229
SHEET NO.	5