

CONDOMINIUM PLAT  
**BUILDING #3**  
**NELSON'S GRANT**  
**PHASE SEVEN-B**  
**UNITS 3-3A, 3-3B & 3-4B**

NELSON MAGISTERIAL DISTRICT  
 COUNTY OF YORK, VIRGINIA  
 SCALE: 1"=20' DATE: MARCH 25, 2021  
 SHEET 5 OF 5

**DAVIS & ASSOCIATES, P.C.**  
 LAND SURVEYORS AND PLANNERS  
 3630 GEORGE WASHINGTON MEMORIAL HIGHWAY  
 YORKTOWN, VIRGINIA 23693  
 (757)867-8583



GRAPHIC SCALE  
 1"=20'

- S Y M B O L S -

- DENOTES MINIMUM BUILDING SETBACK LINES
- DENOTES PROPERTY LINE
- DENOTES IRON PIPE FOUND
- DENOTES IRON ROD FOUND
- DENOTES IRON ROD TO BE SET AT ALL PROPERTY LINE JUNCTURES
- DENOTES CONCRETE MONUMENT FOUND
- DENOTES CONCRETE MONUMENT TO BE SET
- DENOTES PHASE LINE
- DENOTES HANDICAP PARKING SPACE

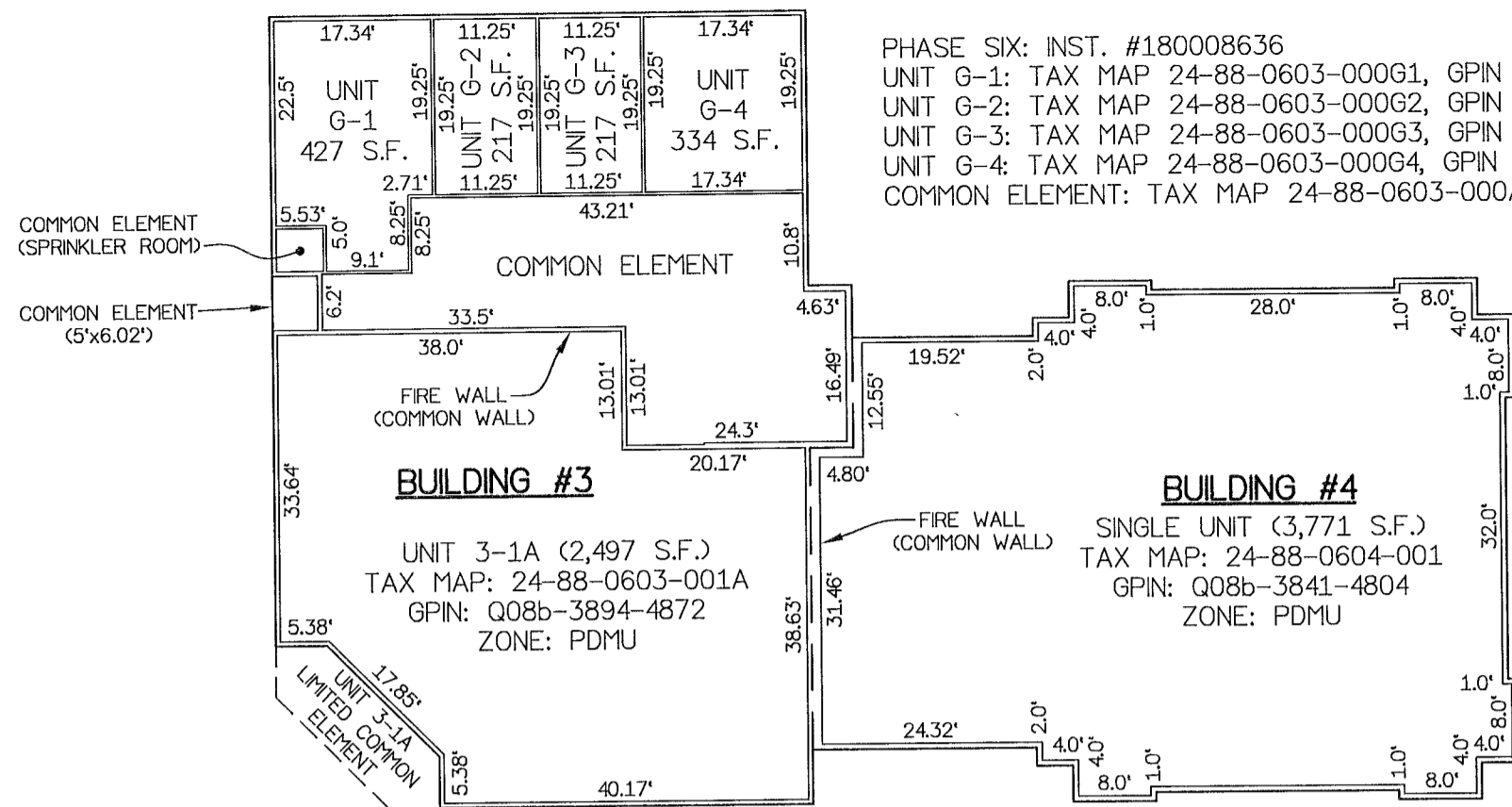

**BUILDINGS #3 & #4 - FIRST FLOOR PLAN - PHASE SIX**  
 DIMENSIONS DEPICTED ABOVE ARE TO INTERIOR FRAME WALL

PHASE SEVEN-A: INST. #200021550  
 UNIT G-5: TAX MAP 24-88-0603-000G5, GPIN Q08b-3945-4754, ZONE: PDMU  
 UNIT G-6: TAX MAP 24-88-0603-000G6, GPIN Q08b-3954-4762, ZONE: PDMU  
 UNIT G-7: TAX MAP 24-88-0603-000G7, GPIN Q08b-3963-4769, ZONE: PDMU  
 UNIT G-8: TAX MAP 24-88-0603-000G8, GPIN Q08b-3972-4776, ZONE: PDMU  
 UNIT G-9: TAX MAP 24-88-0603-000G9, GPIN Q08b-3981-4784, ZONE: PDMU

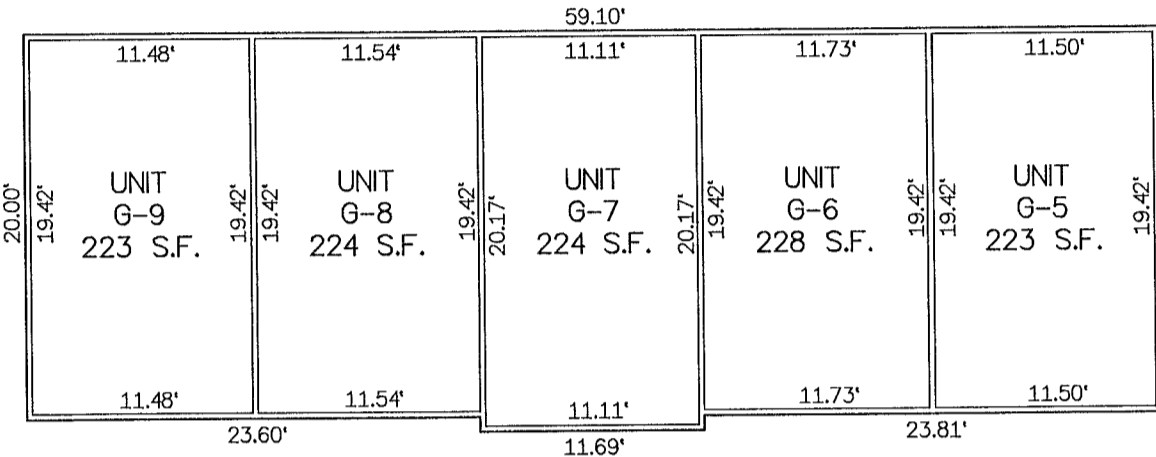

**DETACHED GARAGE - PHASE SEVEN-A - UNITS G5-G9**  
 SCALE: 1"=10'

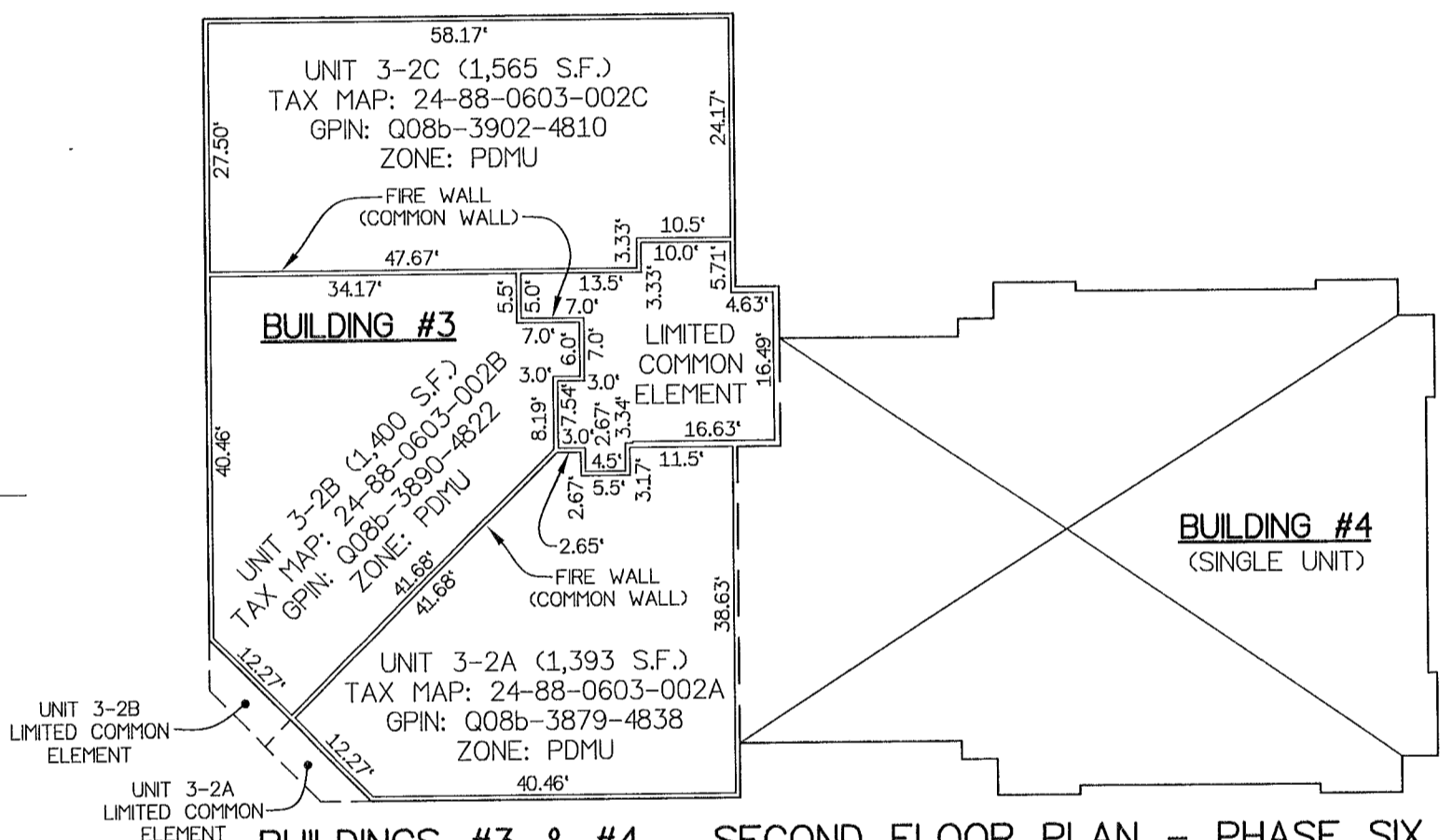

**BUILDINGS #3 & #4 - SECOND FLOOR PLAN - PHASE SIX**  
 DIMENSIONS DEPICTED ABOVE ARE TO INTERIOR FRAME WALL

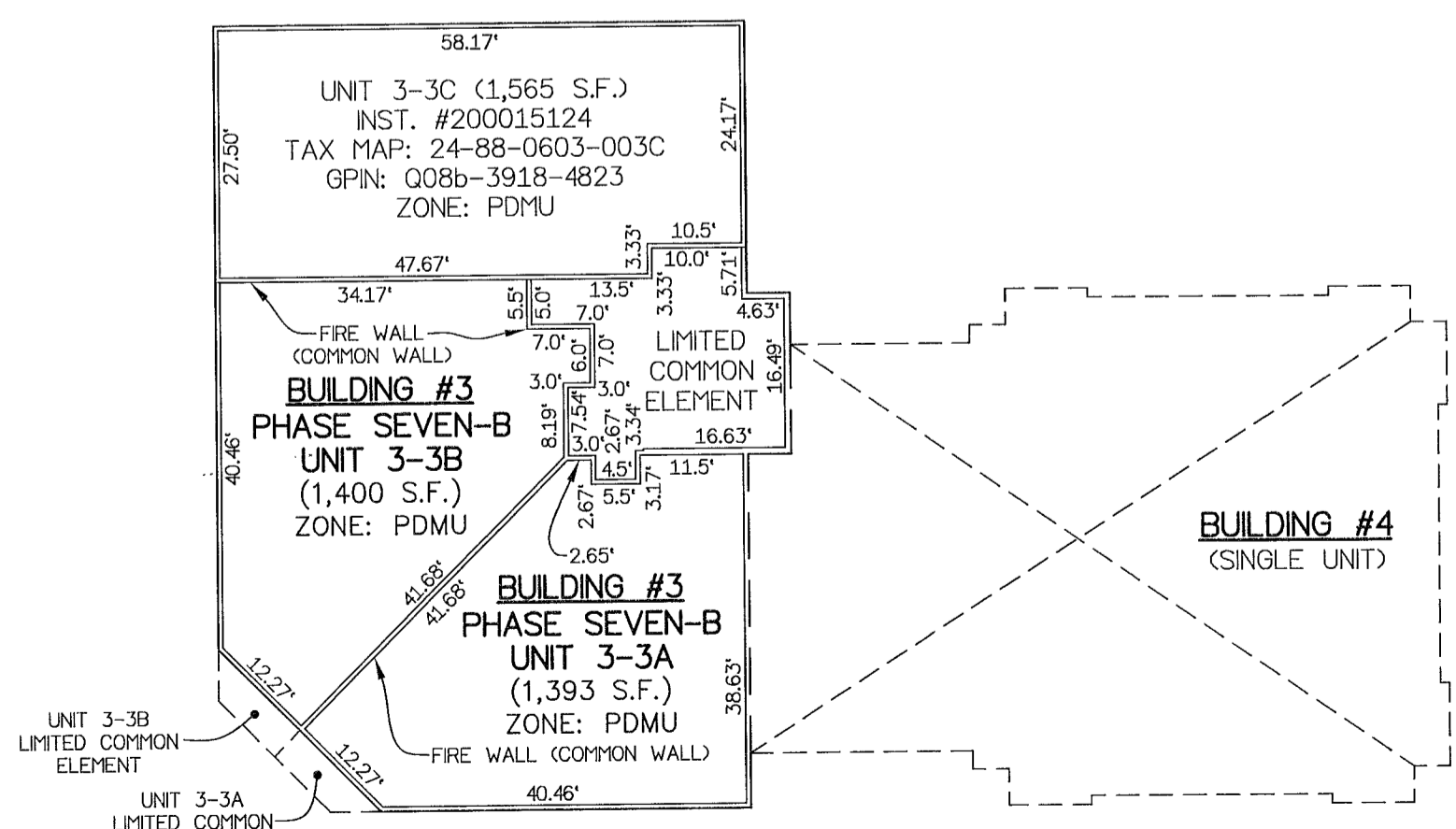

**BUILDING #3 - THIRD FLOOR PLAN - PHASE SIX-A & SEVEN-B**  
 DIMENSIONS DEPICTED ABOVE ARE TO INTERIOR FRAME WALL

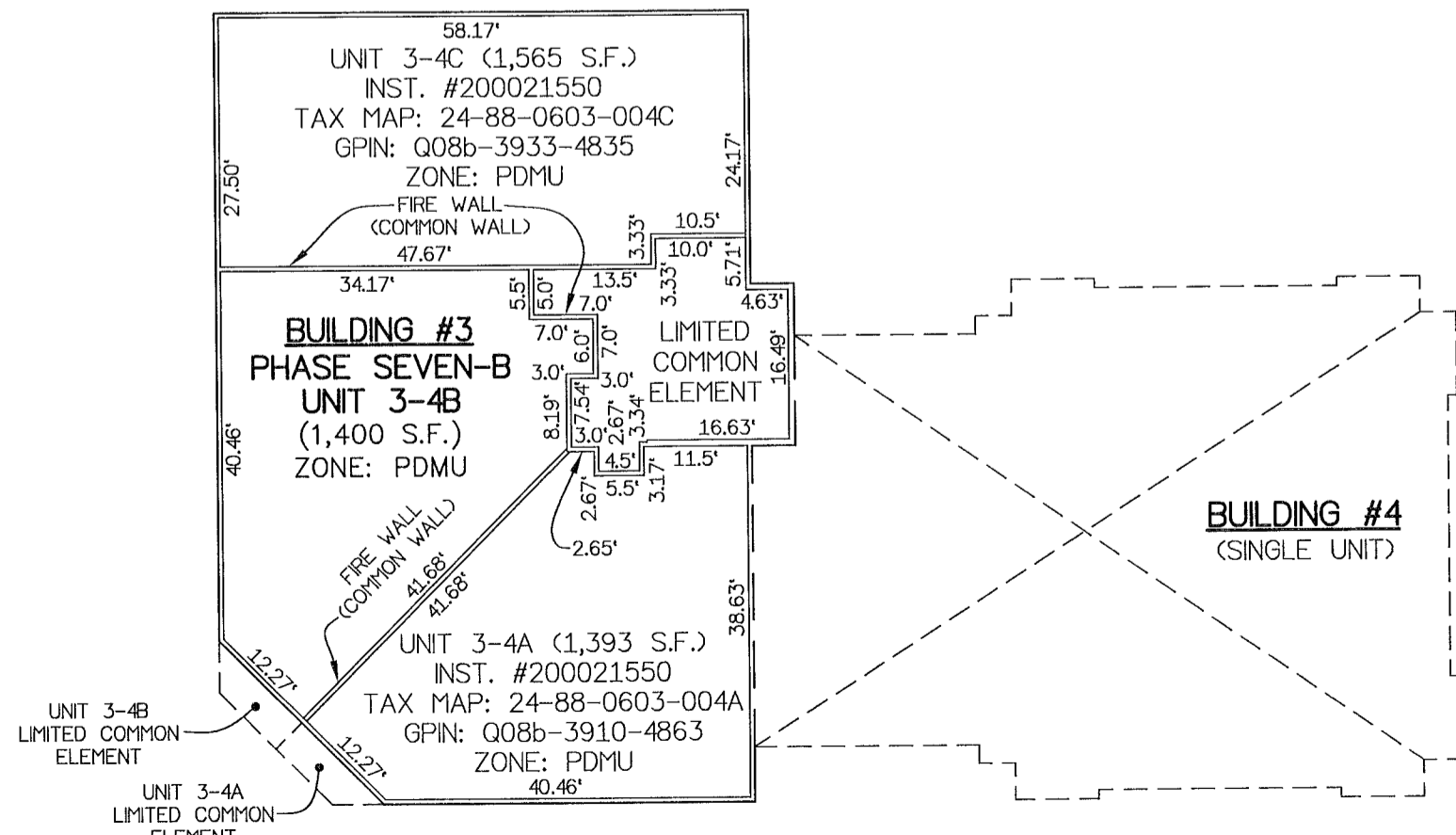

**BUILDING #3 - FOURTH FLOOR PLAN - PHASE SEVEN-A & SEVEN-B**  
 DIMENSIONS DEPICTED ABOVE ARE TO INTERIOR FRAME WALL

**A P P R O V E D**  
 YORK COUNTY BOARD OF SUPERVISORS  
 BY: Susan D. Kassel  
 CLERK APPROVING AGENT  
 DATE: 4/23/21

STATE OF VIRGINIA  
 COUNTY OF YORK  
 IN THE CLERK'S OFFICE OF THE YORK -  
 POQUOSON CIRCUIT COURT THIS 23  
 DAY OF April 2021, THIS MAP WAS  
 PRESENTED AND ADMITTED TO RECORD, AS  
 THE LAW DIRECTS AS INSTRUMENT # 210008034

TESTE: KRISTEN N. NELSON, CLERK  
 CLERK  
 BY: Leah Muz DC