

EASEMENT LEGEND

- 1 - EXISTING PRIVATE 25' DRAINAGE AND UTILITY EASEMENT FOR THE BENEFIT OF TAX PARCELS #36-00-00-022 & #36-01-00-000A [INST. # 100021723]
- 2 - EXISTING VARIABLE WIDTH PRIVATE DRAINAGE AND UTILITY EASEMENT FOR THE BENEFIT OF TAX PARCELS #36-00-00-022 & #36-01-00-000A [INST. # 140021262]
- 3 - EXISTING 35' PRIVATE INGRESS/EGRESS, DRAINAGE AND UTILITIES EASEMENT [INST. # 170020100]
- 4 - EXISTING VARIABLE WIDTH DRAINAGE EASEMENT (OVER AND THROUGH STORMWATER BASIN, BMP #'s 3 & 4) [INST. # 170020100]
- 5 - EXISTING 10' DRAINAGE EASEMENT (CENTERED ON STORM DRAIN) [INST. # 170020100]
- 6 - EXISTING VARIABLE WIDTH YORK COUNTY WETLANDS CONSERVATION EASEMENT (OVER AND ACROSS JURISDICTIONAL WETLANDS) [INST. # 170019369]
- 7 - EXISTING VARIABLE WIDTH YORK COUNTY SIGHT EASEMENT [INST. # 170020100]
- 8 - EXISTING PRIVATE VARIABLE WIDTH PEDESTRIAN ACCESS ESMT. (ENCOMPASSING SIDEWALKS AND CROSSWALKS ADJACENT TO PUBLIC RIGHT-OF-WAYS) [INST. # 170020100]
- 9 - EXISTING 20' YORK COUNTY UTILITY EASEMENT [INST. # 170020100]
- 10 - 35' PRIVATE INGRESS/EGRESS, DRAINAGE AND UTILITIES EASEMENT [INST. # 200004253]
- 11 - 10' DRAINAGE EASEMENT [INST. # 200004253]
- 12 - TEMPORARY TURNAROUND EASEMENT TO BE VACATED UPON THE EXTENSION OF KEENER WAY (50' PUBLIC R/W) AND FUTURE JEANETTE DRIVE (50' PUBLIC R/W) [INST. # 200004253]
- 13 - VARIABLE WIDTH SIGHT EASEMENT [INST. # 200004253]
- 14 - VARIABLE WIDTH PRIVATE PEDESTRIAN ACCESS EASEMENT (ENCOMPASSING SIDEWALKS AND CROSSWALKS ADJACENT TO PUBLIC) RIGHT-OF-WAYS) [INST. # 200004253]

LINE DATA TABLE

LINE	BEARING	DISTANCE	LINE	BEARING	DISTANCE	LINE	BEARING	DISTANCE
L1	S 72°39'25" E	133.70'	L21	N 53°35'16" W	31.67'	L41	S 24°02'52" W	51.98'
L2	S 72°48'23" E	84.27'	L22	N 58°09'12" W	16.43'	L42	S 17°22'50" W	77.64'
L3	S 80°15'53" E	47.00'	L23	N 70°19'10" W	45.15'	L43	N 74°32'39" E	12.81'
L4	S 09°44'07" W	21.36'	L24	N 53°41'27" W	20.92'	L44	S 17°22'50" W	63.00'
L5	N 80°15'53" W	137.70'	L25	N 37°32'44" W	29.12'	L45	S 17°22'50" W	135.50'
L6	S 89°53'33" W	18.04'	L26	N 30°58'10" W	41.09'	L46	N 17°22'50" E	180.50'
L7	N 77°59'33" W	25.81'	L27	N 45°44'26" W	31.02'	L47	S 17°22'50" W	186.02'
L8	S 87°56'28" W	30.36'	L28	N 66°46'38" W	27.01'	L48	N 17°22'50" E	187.27'
L9	N 65°46'22" W	18.49'	L29	N 82°01'05" W	18.77'			
L10	N 05°40'01" W	15.07'	L30	S 81°06'07" W	14.28'			
L11	N 74°07'36" W	18.60'	L31	N 15°51'41" W	18.60'			
L12	N 03°25'42" W	25.44'	L32	N 48°14'33" E	15.30'			
L13	S 81°10'18" W	28.53'	L33	N 44°00'20" W	33.55'			
L14	S 75°00'14" W	18.28'	L34	N 04°25'12" W	15.99'			
L15	S 86°30'42" W	32.79'	L35	N 35°13'01" E	34.53'			
L16	S 60°36'03" W	22.47'	L36	N 36°58'28" W	22.16'			
L17	S 31°51'48" W	29.55'	L37	N 03°24'00" E	27.42'			
L18	S 31°37'48" W	27.80'	L38	N 14°01'34" E	7.71'			
L19	S 43°12'44" W	28.96'	L39	N 72°37'10" W	80.00'			
L20	S 80°46'12" W	28.58'	L40	S 78°14'24" W	24.16'			

CURVE DATA TABLE

NUMBER	DELTA ANGLE	RADIUS	ARC LENGTH	CHORD LENGTH	CHORD DIRECTION
C1	57°09'49"	54.50'	54.37'	52.15'	S 44°02'15" E
C2	47°16'53"	24.50'	20.22'	19.65'	S 41°01'17" W
C3	90°00'00"	24.00'	37.70'	33.94'	S 27°37'10" E
C4	90°00'00"	24.00'	37.70'	33.94'	N 62°22'50" E
C5	47°16'53"	24.50'	20.22'	19.65'	N 06°15'36" W
C6	47°16'53"	24.50'	20.22'	19.65'	S 41°01'17" W
C7	90°00'00"	50.00'	78.54'	70.71'	S 62°22'50" W

CONDOMINIUM PLAT  
OF  
PHASE TWENTY EIGHT  
AND  
PHASE TWENTY NINE  
MAINSTAY AT  
COMMONWEALTH GREEN  
SECTION TWO

BETHEL MAGISTERIAL DISTRICT  
COUNTY OF YORK, VIRGINIA  
SCALE: 1"=40' DATE: SEPTEMBER 22, 2021  
SHEET 5 OF 6

DAVIS & ASSOCIATES, P.C.  
LAND SURVEYORS AND PLANNERS  
3630 GEORGE WASHINGTON MEMORIAL HIGHWAY  
YORKTOWN, VIRGINIA 23693  
(757)867-8583

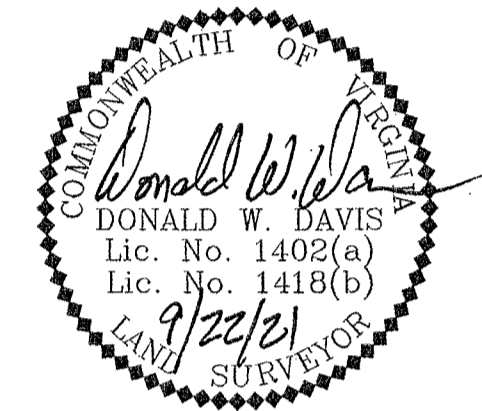
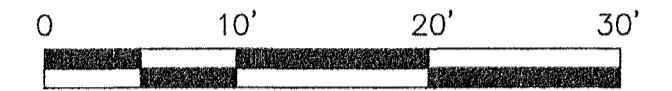

PHASE TWENTY EIGHT - BUILDING TWENTY ONE (UNITS 55 & 56)  
PHASE TWENTY NINE - BUILDING TWENTY TWO DETAIL (UNITS 57 & 58)

DIMENSIONS REFLECT INTERIOR FRAME LINE

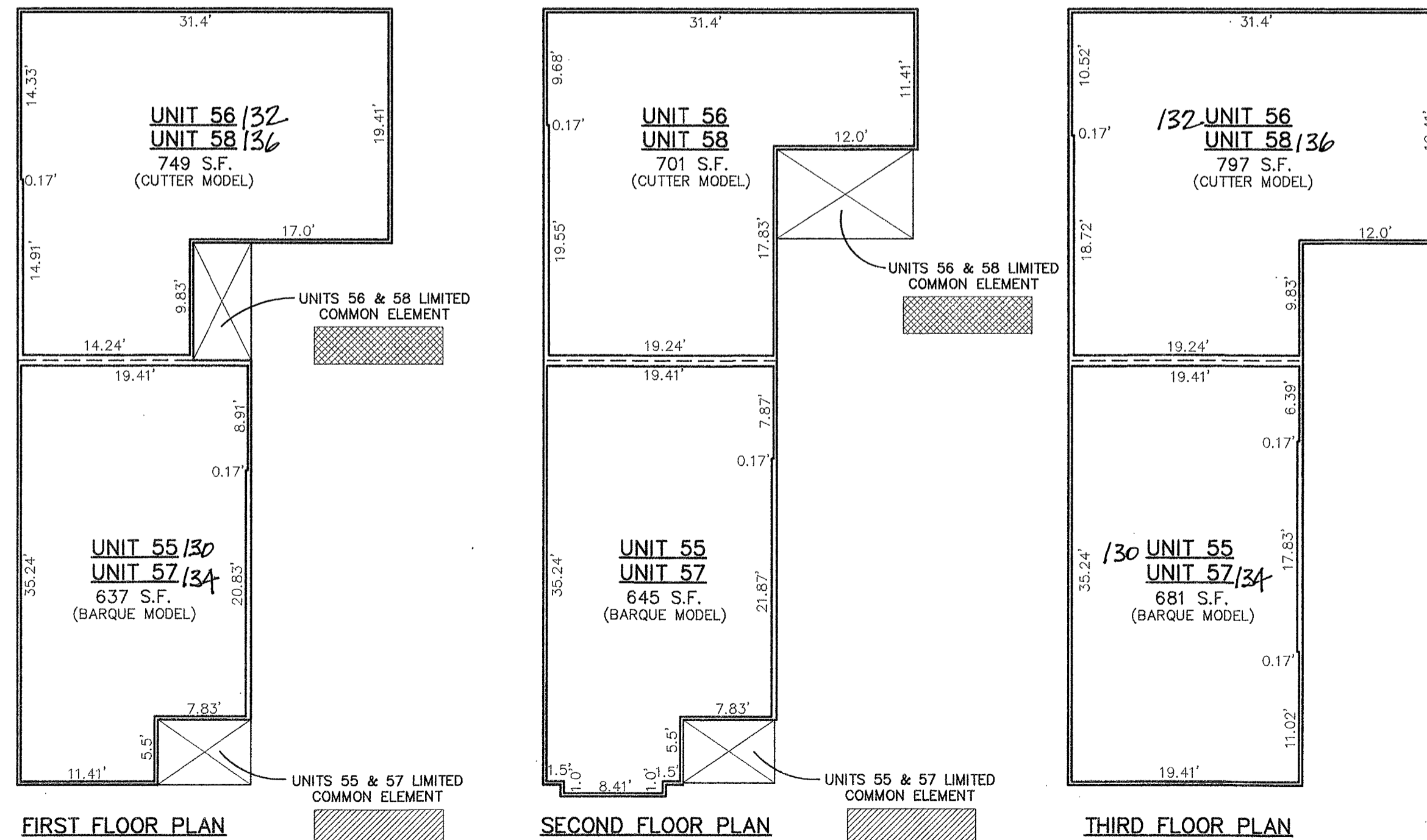

- SYMBOLS -

- DENOTES LIMITED COMMON ELEMENT - UNITS 55 & 57
- DENOTES LIMITED COMMON ELEMENT - UNITS 56 & 58

**APPROVED**  
YORK COUNTY BOARD OF SUPERVISORS

BY: *Simon Kassel*  
PLAT APPROVING AGENT

DATE: NOVEMBER 8, 2021

STATE OF VIRGINIA  
COUNTY OF YORK  
IN THE CLERK'S OFFICE OF THE YORK -  
POQUOSON CIRCUIT COURT THIS 9th  
DAY OF November 2021, THIS MAP WAS  
PRESENTED AND ADMITTED TO RECORD AS  
THE LAW DIRECTS AS INSTRUMENT # 210058655

TESTE: Kristen N. Nelson  
CLERK

BY: Naelene M. Holt, DC