

CONDOMINIUM PLAT OF PHASE THIRTY TWO AND PHASE THIRTY THREE MAINSTAY AT COMMONWEALTH GREEN SECTION ONE - PARCEL 'D'

BETHEL MAGISTERIAL DISTRICT COUNTY OF YORK, VIRGINIA SCALE: 1"=40' DATE: FEBRUARY 28, 2022 SHEET 3 OF 7

DAVIS & ASSOCIATES, P.C. LAND SURVEYORS AND PLANNERS 3630 GEORGE WASHINGTON MEMORIAL HIGHWAY YORKTOWN, VIRGINIA 23693 (757)867-8583



SYMBOLS

- Denotes iron pipe found, iron rod found, iron rod to be set, concrete monument found, concrete monument to be set, jurisdictional wetlands, and additional/withdrawable land.

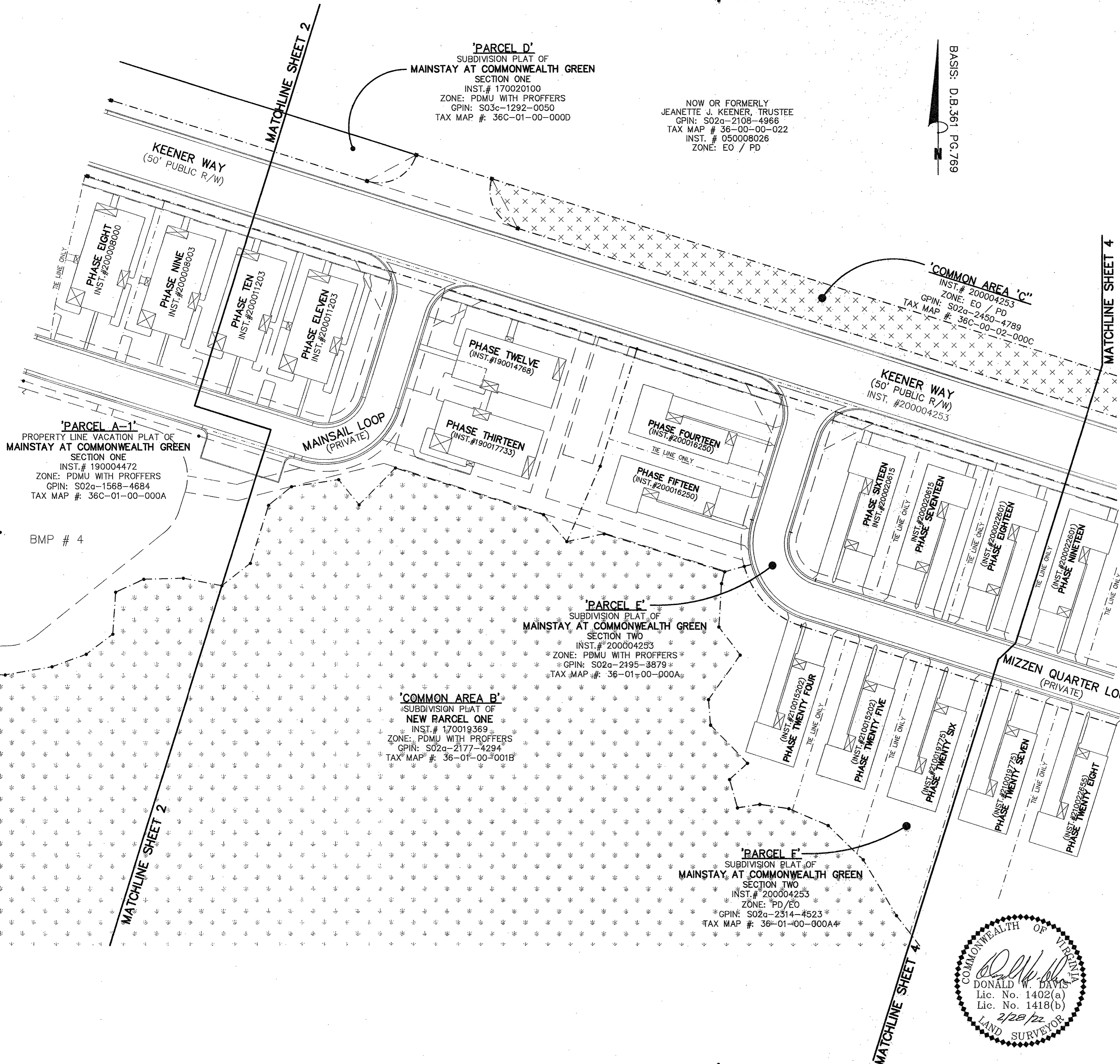

'PARCEL D' SUBDIVISION PLAT OF MAINSTAY AT COMMONWEALTH GREEN SECTION ONE INST. # 170020100

NOW OR FORMERLY JEANETTE J. KEENER, TRUSTEE GPIN: S02a-2108-4966 TAX MAP # 36-00-00-022

BASIS: D.B.361 PG.769

'COMMON AREA C' INST. # 200004253 ZONE: EO / PD GPIN: S02a-2450-4789 TAX MAP # 36C-00-02-000C

'PARCEL A-1' PROPERTY LINE VACATION PLAT OF MAINSTAY AT COMMONWEALTH GREEN SECTION ONE INST. # 190004472

BMP # 4

'PARCEL E' SUBDIVISION PLAT OF MAINSTAY AT COMMONWEALTH GREEN SECTION TWO INST. # 200004253

'COMMON AREA B' SUBDIVISION PLAT OF NEW PARCEL ONE INST. # 170019369

'PARCEL E' SUBDIVISION PLAT OF MAINSTAY AT COMMONWEALTH GREEN SECTION TWO INST. # 200004253

APPROVED YORK COUNTY BOARD OF SUPERVISORS BY: Susan Kassel PLAT APPROVING AGENT DATE: MAY 19, 2022

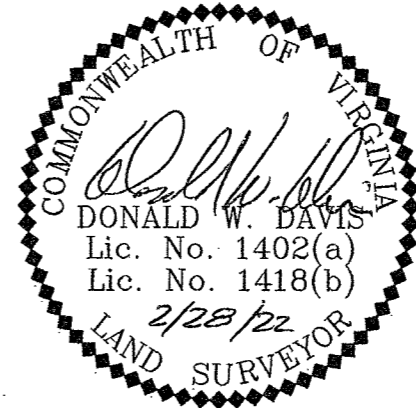

STATE OF VIRGINIA COUNTY OF YORK IN THE CLERK'S OFFICE OF THE YORK, POQUOSON CIRCUIT COURT THIS 20th DAY OF May 2022, THIS MAP WAS PRESENTED AND ADMITTED TO RECORD AS THE LAW DIRECTS AS INSTRUMENT # 220008585