

MATCH LINE SEE SHEET 6

MATCH LINE SEE SHEET 7

PLAT OF
BOUNDARY LINE ADJUSTMENT AND PROPERTY LINE VACATION
PART OF PARCEL 1A AND PART OF PARCEL 2

PROPERTY OWNED BY

PENINSULA AIRPORT COMMISSION

LOCATED IN
GRAFTON DISTRICT
YORK COUNTY, VIRGINIA

SCALE: 1" = 100' DATE: JULY 20, 2022
(SHEET 8 OF 12)

PRECISION MEASUREMENTS, INC.

SURVEYORS • GPS • 3-D SCANNING • GIS • MAPPERS
VIRGINIA BEACH-RICHMOND-NEWPORT NEWS-CHANTILLY, VIRGINIA
11835 CANON BLVD, SUITE B-103
NEWPORT NEWS, VIRGINIA 23606
TEL: (757) 595-7570

MONUMENTS LEGEND	
●	#5 REBAR SET UNLESS OTHERWISE NOTED
○	#5 REBAR FOUND UNLESS OTHERWISE NOTED
■	MON(F) CONCRETE MONUMENT FOUND
■	VDOT(F) VDOT MONUMENT FOUND

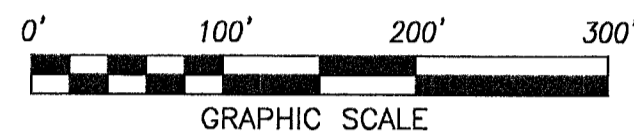

190 --- DENOTES PART 77 SURFACE HEIGHT MSL'

NOW OR FORMERLY
McMURRAN FAMILY - YORK
COUNTY PROPERTY, LLC
INST# 100007401
P.B. 8, PG. 489
GPIN: Q06c-1196-1148
ZONED: IL

PARCEL 1A-1

8,611,995 SQ. FEET
197.704 ACRES

FORMER
PARCEL 2
6,145,814 S.F./141.0885 AC.

PART 77 SURFACE
HEIGHT = 194' MSL'
(150' AGL)
GROUND ELEVATION = 44'+/-

AVIGATION ESMT.
ESMT.ELEV=149.10
GROUND=53.1

EXIST. 200' POWER EASEMENT
(P.B. 5, PG. 8)
(D.B. 74, PG. 83)
542.62'

N= 3,584,955.070
E=12,066,813.744

S 88°05'27" W 2,840.90' TOTAL
NEW P. HEREBY ESTABLISHED
819.96'

Q RUNWAY
ESMT.ELEV=154.73
GROUND=47.4

(N 73°04'39" E 430.05')
P. HEREBY VACATED

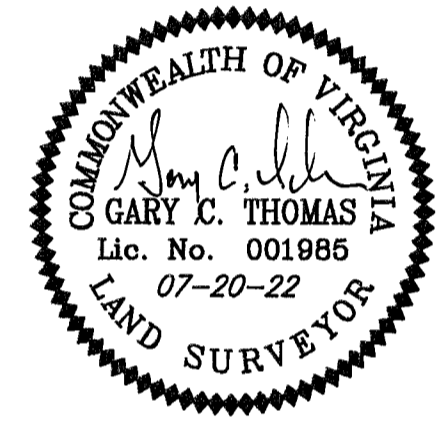

APPROVED

YORK COUNTY BOARD OF SUPERVISORS

BY: *Susan Kassel* for **SUSAN KASSEL**
PLAT APPROVING AGENT

DATE: 9/23/22

STATE OF VIRGINIA:
COUNTY OF YORK
IN THE CLERK'S OFFICE OF THE CIRCUIT COURT FOR
THE COUNTY OF YORK-POQUOSON, ON THIS
23rd DAY OF September, 2022,
THIS PLAT WAS PRESENTED AND ADMITTED TO RECORD
AS THE LAW DIRECTS, AS INSTRUMENT NUMBER

220016710

TESTE **KRISTEN N. NELSON, CLERK**
CLERK

BY: *Barbara Hutcherson*
DEPUTY CLERK

FOR ADJOINING OWNERS
SEE PAGE 4.

MATCH LINE SEE SHEET 10