

"CONDOMINIUM PLAT AND PLANS"
OF
PHASE FORTY THREE
AND
PHASE FORTY FOUR
MAINSTAY AT
"COMMONWEALTH GREEN CONDOMINIUM"
SECTION ONE - PARCEL 'C'
BETHEL MAGISTERIAL DISTRICT
COUNTY OF YORK, VIRGINIA
SCALE: 1" = 40' DATE: MAY 26, 2023
SHEET 5 OF 7

DAVIS & ASSOCIATES, P.C.
LAND SURVEYORS AND PLANNERS
3630 GEORGE WASHINGTON MEMORIAL HIGHWAY
YORKTOWN, VIRGINIA 23693
(757) 867-8583

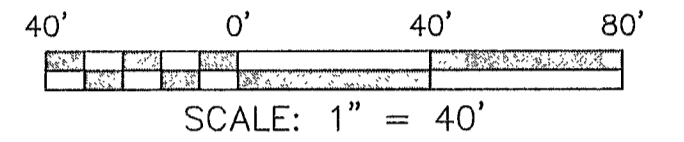

- S Y M B O L S —
- DENOTES IRON PIPE FOUND
 - DENOTES IRON ROD FOUND
 - DENOTES IRON ROD TO BE SET AT ALL PROPERTY LINE JUNCTURES
 - DENOTES CONCRETE MONUMENT FOUND
 - DENOTES CONCRETE MONUMENT TO BE SET

DENOTES JURISDICTIONAL WETLANDS MARKED BY WOLFE ENVIRONMENTAL & ENGINEERING CONSULTANTS AND FIELD LOCATED BY DAVIS AND ASSOCIATES, P.C. ON DECEMBER 30, 2005 USCOE PROJECT # 05-R2629 USCOE PROJECT # 95-5485

DENOTES ADDITIONAL AND WITHDRAWABLE LAND "A"

DENOTES LIMITED COMMON ELEMENT - UNITS 86 & 88

DENOTES LIMITED COMMON ELEMENT - UNITS 85 & 87

NOW OR FORMERLY
YORKTOWN HOTEL, LLC
GPIN: S03c-0949-0074
TAX MAP # 36-00-00-023
INST. # 130014202
ZONE: GB

NOW OR FORMERLY
VILLAGES OF KILN CREEK PROFESSIONAL & BUSINESS
GPIN: S03c-1111-0506
TAX MAP # 36-02-16-000D
D.B. 1038, PG. 762
ZONE: GB

BASIS: D.B. 361 PG. 769

NOW OR FORMERLY
JEANETTE J. KEENER, TRUSTEE
GPIN: S02a-2108-4966
TAX MAP # 36-00-00-022
INST. # 050008026
ZONE: EO/PD

PARCEL D
NOW OR FORMERLY
MAINSTAY, LLC
GPIN: S03c-1292-0050
TAX MAP # 36C-01-00-000D
INST. # 170020100
ZONE: PDMU WITH PROFFERS

PARCEL C
NOW OR FORMERLY
MAINSTAY, LLC
GPIN: S02a-1220-4864
TAX MAP # 36C-01-00-000C
INST. # 170020100
ZONE: PDMU WITH PROFFERS

PARCEL ONE-B
NOW OR FORMERLY
COMMONWEALTH GREEN, LLLP
GPIN: S02a-1120-4700
TAX MAP # 36-01-00-000A2
INST. # 130005619
ZONE: PDMU WITH PROFFERS

PARCEL A-1
SECTION ONE
NOW OR FORMERLY
MAINSTAY, LLC
GPIN: S02a-1568-4684
TAX MAP # 36C-01-00-000A
INST. # 190004472
ZONE: PDMU WITH PROFFERS

APPROVED
YORK COUNTY BOARD OF SUPERVISORS
BY: Eileen Kussel
PLAT APPROVING AGENT
DATE: July 12, 2023

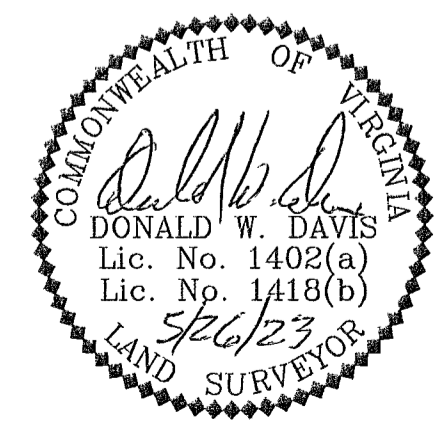

STATE OF VIRGINIA
COUNTY OF YORK
IN THE CLERK'S OFFICE OF THE YORK -
POQUOSON CIRCUIT COURT THIS 12th
DAY OF July, 2023, THIS MAP WAS
PRESENTED AND ADMITTED TO RECORD AS
THE LAW DIRECTS AS INSTRUMENT # 230010043

TESTE: KRISTEN N. NELSON, CLERK
CLERK
BY: Walne H. Hett, Jr.