

85 90 95

SUFFOLK DISTRICT DESIGN UNIT

SUPERVISED BY: E. N. HOLLOWELL  
 DESIGNED BY: D. B. WINSLOW  
 CAD OPERATOR: M. J. WOOD  
 REVISIONS BY: [ ]

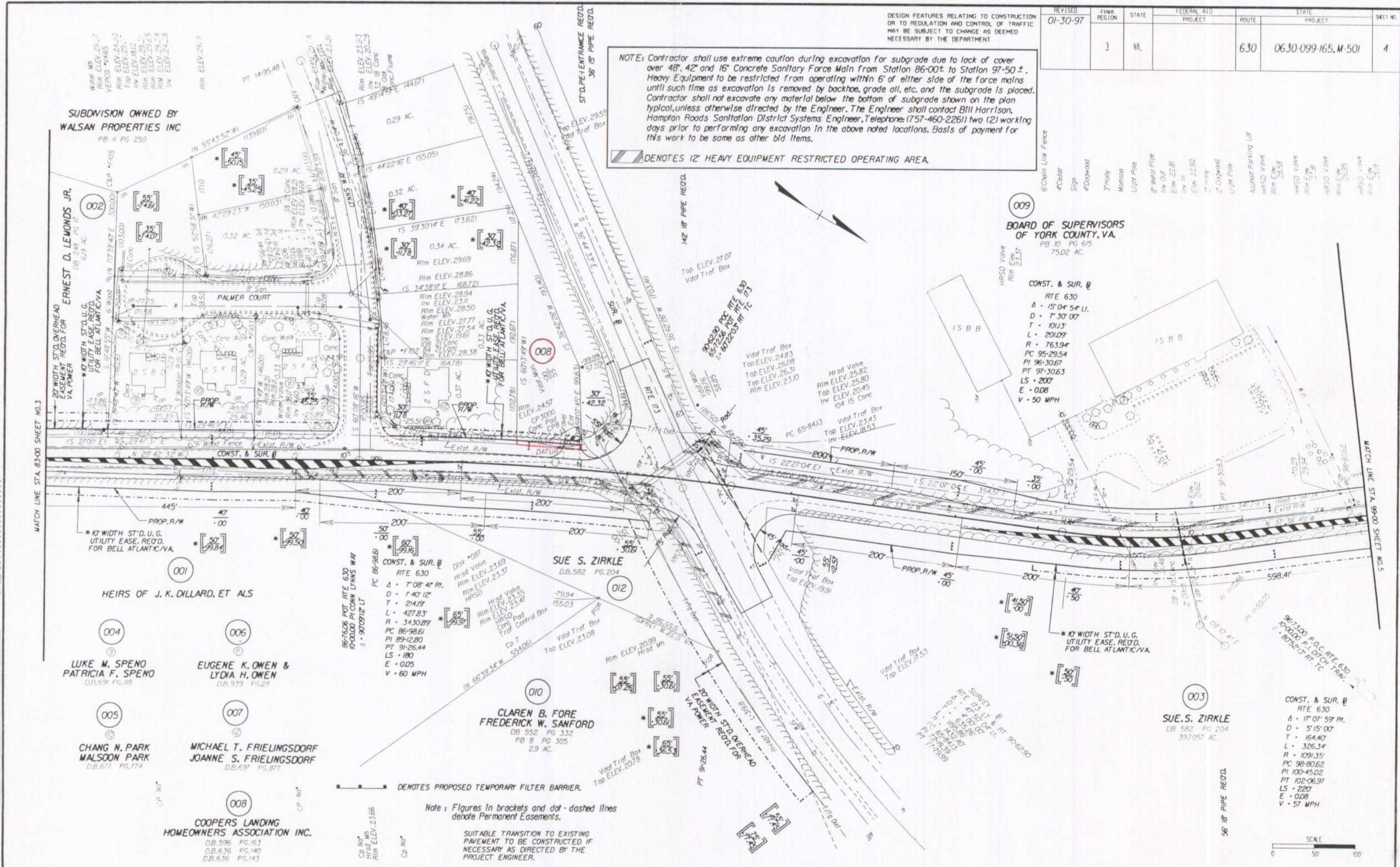

REVISED	FHWA REGION	STATE	FEDERAL AID PROJECT	ROUTE	STATE PROJECT	SHEET NO.
01-30-97	3	VA.		630	0630-099-165, M-501	4

- 6" Chain Link Fence
- 4" Cedar Sign
- 4" Dogwood
- 3" Holly
- Mombasa
- Light Pole
- 6" Metal Pipe In/Out Elev. 22.81
- In/In Elev. 22.92
- 2" Holly
- 2" Dogwood
- Light Pole
- Asphalt Parking Lot
- HPSD Valve Rim Elev. 23.58
- HPSD Valve Rim Elev. 23.58
- HPSD Valve Rim Elev. 23.58
- HPSD Valve Rim Elev. 23.58
- HPSD Valve Rim Elev. 23.58
- HPSD Valve Rim Elev. 23.58

