

SUFFOLK DISTRICT DESIGN UNIT

DESIGN FEATURES RELATING TO CONSTRUCTION OF TO REGULAR AND CONTROL OF TRAFFIC MAY BE SUBJECT TO CHANGE AS DEEMED NECESSARY BY THE DEPARTMENT.

REVISED	FHWA REGION	STATE	FEDERAL AID PROJECT	ROUTE	STATE PROJECT	SHEET NO.
12-02-96	3	VA		603	0603-099-127, M-501	5
12-20-96						
01-28-97						
08-27-97						

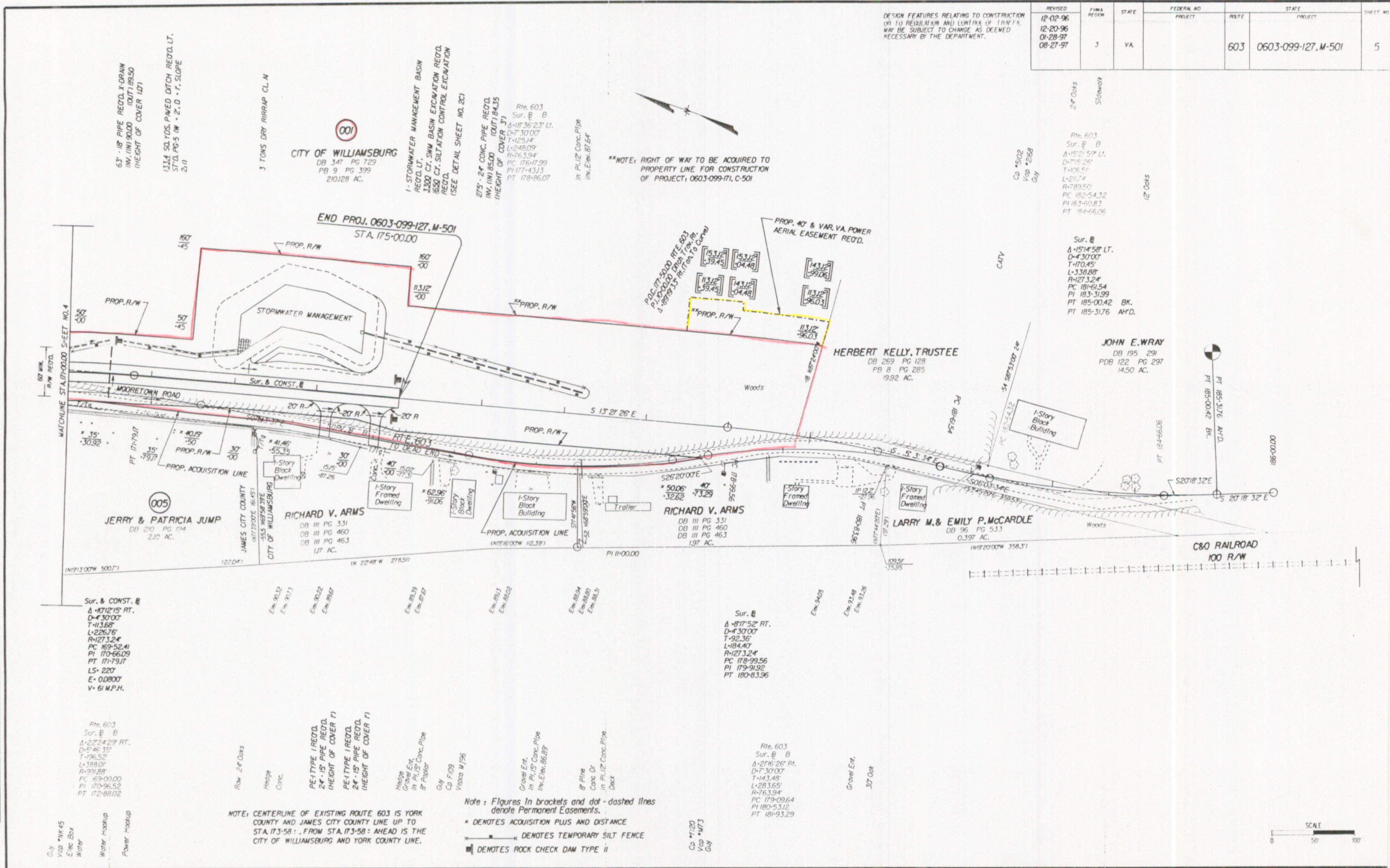

SUPERVISED BY E. N. HOLLOWELL
 DESIGNED BY D. B. WINSLOW
 CAD OPERATOR T. H. ...
 REVISED BY ...

PLAT	DATE	BY

NOTE: CENTERLINE OF EXISTING ROUTE 603 IS YORK COUNTY AND JAMES CITY COUNTY LINE UP TO STA. 173+58. FROM STA. 173+58: AHEAD IS THE CITY OF WILLIAMSBURG AND YORK COUNTY LINE.

Note: Figures in brackets and dot-dashed lines denote Permanent Easements.

* DENOTES ACQUISITION PLUS AND DISTANCE

--- DENOTES TEMPORARY SILT FENCE

■ DENOTES ROCK CHECK DAM TYPE II

