

Design File - c:\pwork\1470106\1470106.dwg Ref File - p:\pwork\1470106.dwg Ref File - p:\pwork\1470106.dwg Ref File - p:\pwork\1470106.dwg Ref File - p:\pwork\1470106.dwg Ref File - p:\pwork\1470106.dwg Ref File - p:\pwork\1470106.dwg Ref File - p:\pwork\1470106.dwg Ref File - p:\pwork\1470106.dwg Ref File - p:\pwork\1470106.dwg Ref File - p:\pwork\1470106.dwg

SUFFOLK DISTRICT DESIGN UNIT

REVISED	FHWA REGION	STATE	FEDERAL AID PROJECT	ROUTE	STATE PROJECT	SHEET NO.
02-22-99 05-04-99 07-14-99	3	VA.		17	6017-099-122, PE-101, RW-201, C-501	6

DESIGN FEATURES RELATING TO CONSTRUCTION OR TO REGULATION AND CONTROL OF TRAFFIC MAY BE SUBJECT TO CHANGE AS DEEMED NECESSARY BY THE DEPARTMENT

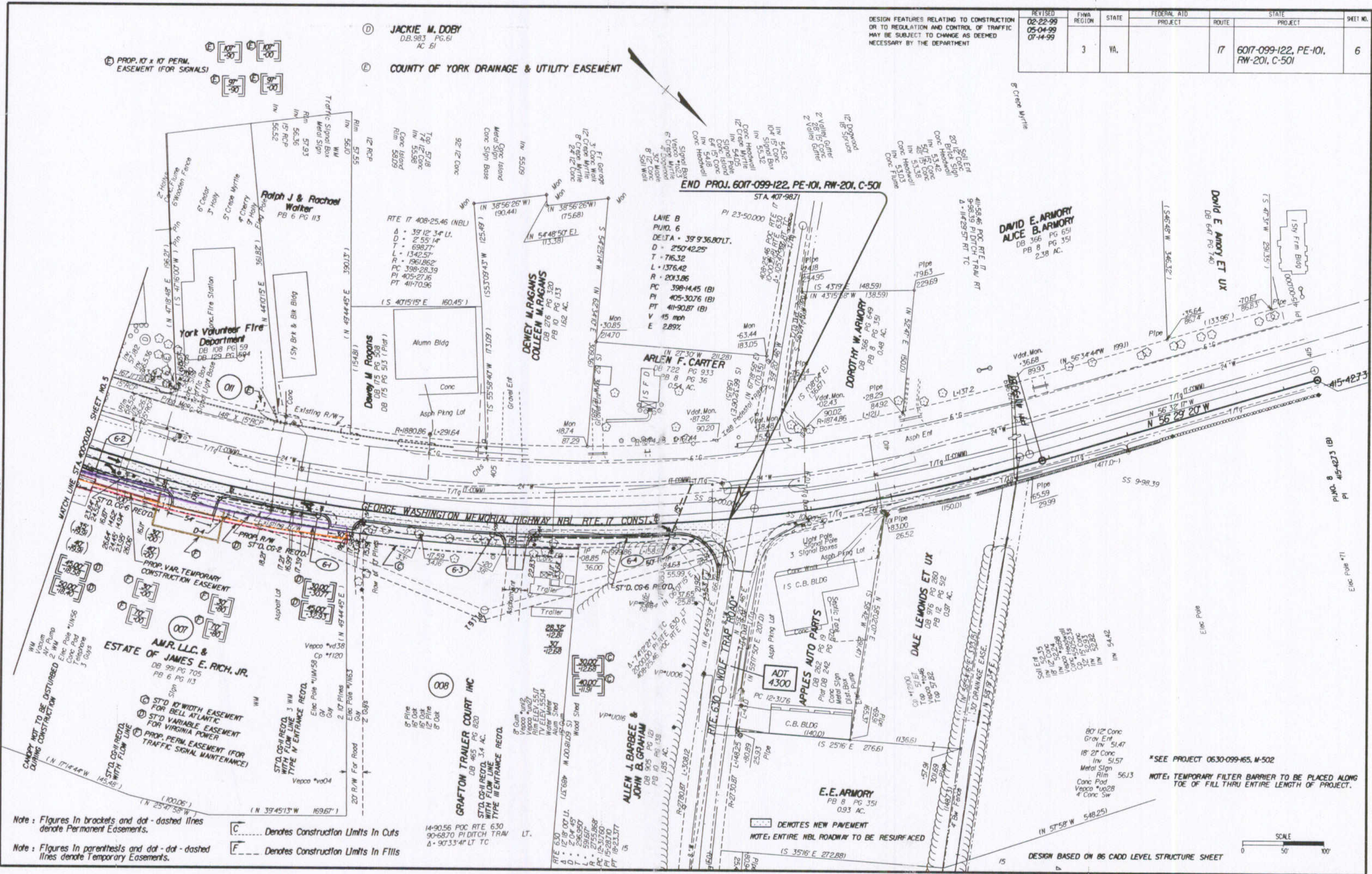

Note: Figures in brackets and dot-dashed lines denote Permanent Easements.  
 Note: Figures in parenthesis and dot-dot-dashed lines denote Temporary Easements.

C..... Denotes Construction Limits In Cuts  
 F..... Denotes Construction Limits In Fills

\*SEE PROJECT 0630-099-165, M-502  
 NOTE: TEMPORARY FILTER BARRIER TO BE PLACED ALONG TOE OF FILL THRU ENTIRE LENGTH OF PROJECT.

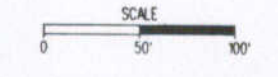

PLAN NO.	PROJECT	FILE NO.	SHEET NO.
A	6017-099-122		6