

385			390		395		400
-----	--	--	-----	--	-----	--	-----

SUFFOLK DISTRICT DESIGN UNIT

DESIGN FEATURES RELATING TO CONSTRUCTION OR TO REGULATION AND CONTROL OF TRAFFIC MAY BE SUBJECT TO CHANGE AS DEEMED NECESSARY BY THE DEPARTMENT

REVISED	FHWA REGION	STATE	FEDERAL AID PROJECT	ROUTE	STATE PROJECT	SHEET NO.
02-22-99 04-26-99 05-04-99 06-23-99	3	VA.		17	6017-099-122, PE-101, RW-201, C-501	5

- (A) DONALD J. REICHLÉ
CAROL A. REICHLÉ
D.B. 906 PG. 552
AC 38
- (B) HARRY BYRD ROBINSON
JUNE S. ROBINSON
D.B. 286 PG. 271
AC 60
- (C) TERRY H. HAKE
RACHEL A. HAKE
D.B. 877 PG. 001
P.B. 12 PG. 326
AC 56
- (D) JACKIE M. DOBY
D.B. 983 PG. 61
AC 61

LANE B
P.I.M.O. 6
DELTA - 39' 9" 36.80' LT.
D - 2' 50" 42.25'
T - 716.32
L - 1376.42
R - 2013.86
PC 398+44.45 (B)
PI 405+30.76 (B)
PT 411+90.87 (B)
V 45 mph
E 2.89% Sign

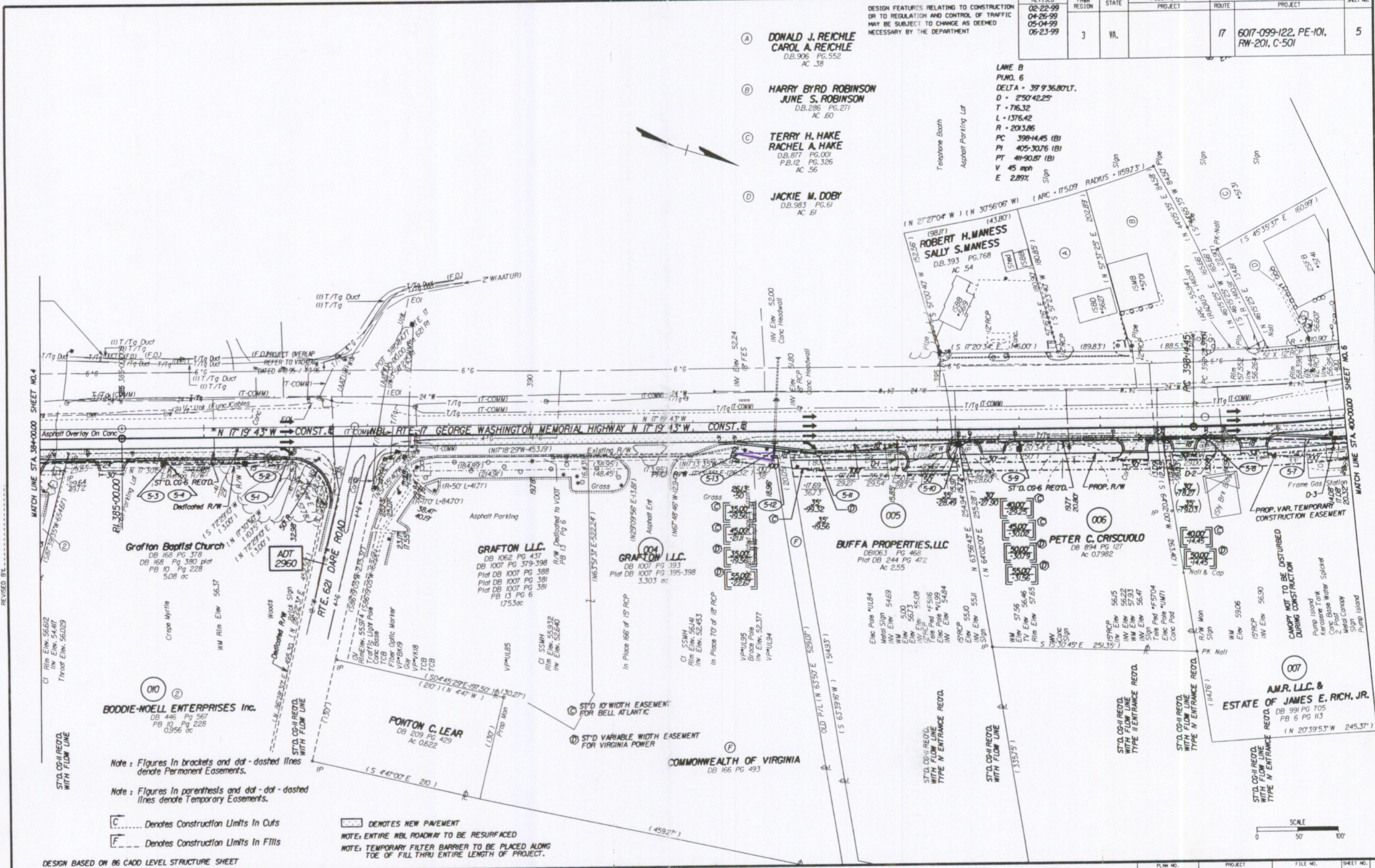

SURVEYED BY: R.D. HANSON / D.B. HARRIS III
SUPERVISED BY: R.W. HARRIS (1757-395-2660)
DESIGNED BY: A.A. HARRIS (1757-395-2620)
CADD OPERATOR: JAMES E. RICH, JR. (1757-395-2620)
REVISED BY:

DESIGN BASED ON 86 CADD LEVEL STRUCTURE SHEET

Note: Figures in brackets and dot-dashed lines denote Permanent Easements.
Note: Figures in parenthesis and dot-dot-dashed lines denote Temporary Easements.
[C] Denotes Construction Limits In Cuts
[F] Denotes Construction Limits In Fills

■ DENOTES NEW PAVEMENT
NOTE: ENTIRE NBL ROADWAY TO BE RESURFACED
NOTE: TEMPORARY FILTER BARRIER TO BE PLACED ALONG TOE OF FILL THRU ENTIRE LENGTH OF PROJECT.

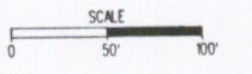

PLAN NO.	PROJECT	FILE NO.	SHEET NO.
A	6017-099-122		5