

REVISED	FINA REGION	STATE	FEDERAL AID PROJECT	ROUTE	STATE PROJECT	SHEET NO.
04/18/96	3	VA		64	0064-099-106, RW-201 C-501	4

DESIGN FEATURES RELATING TO CONSTRUCTION OR TO REGULATION AND CONTROL OF TRAFFIC MAY BE SUBJECT TO CHANGE AS DEEMED NECESSARY BY THE DEPARTMENT

Gannett Fleming
 ENGINEERS AND PLANNERS

POWER POLES PROPERTY OF VIRGINIA POWER
 P.O. BOX 329, NORFOLK, VA 23502

WATER LINES PROPERTY OF CITY OF NEWPORT NEWS,
 DEPARTMENT OF PUBLIC UTILITIES, 600 WARWICK BLVD.,
 NEWPORT NEWS, VA 23605

GAS LINES PROPERTY OF VIRGINIA NATURAL GAS COMPANY
 500 EAST VIRGINIA BEACH BLVD., NORFOLK, VA 23502

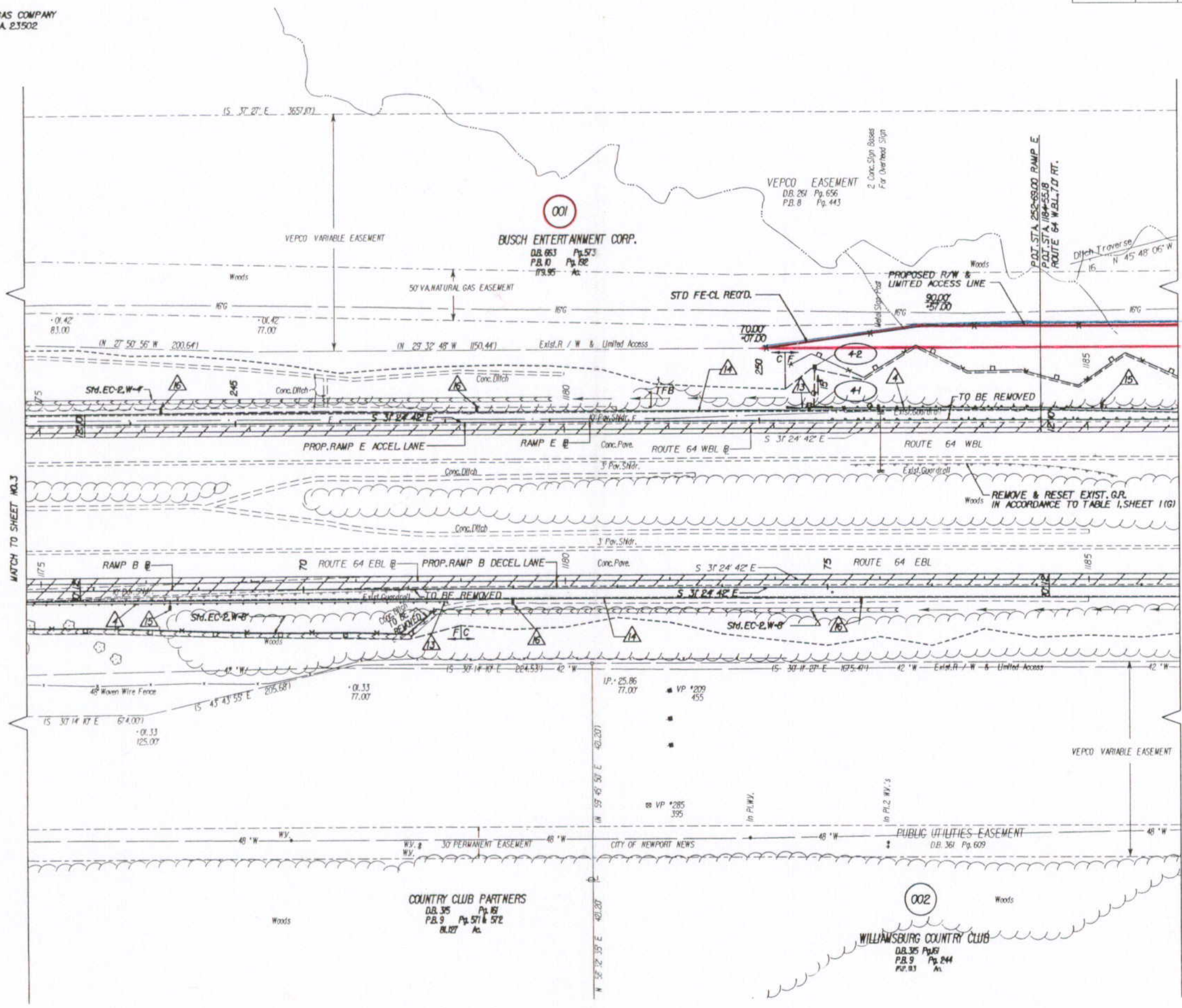

MATCH TO SHEET NO. 5

MATCH TO SHEET NO. 3

- DEMOTES ST'D. GR-2 REQ'D.
- DEMOTES ST'D. GR-HOW TERMINAL END SECTION
- DEMOTES ST'D. UD-4
- DEMOTES ST'D. EW-12 (2:1 SLOPE)
- DEMOTES ST'D. EW-12 (4:1 SLOPE)
- TFB DEMOTES TEMPORARY FILTER BARRIER
- TSF DEMOTES TEMPORARY SILT FENCE

C --- Denotes Construction Limits In Cuts
 E --- Denotes Construction Limits In Fills

INDEX	
	ALIGNMENT 1E
	PROFILES 1
	RAMP E 3A
	RAMP B 3B, 4A
	DRAINAGE
	ULSCH. 8B

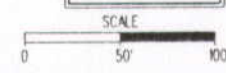

SUPERVISED BY: _____
 DESIGNED BY: _____
 CAD OPERATOR: _____
 REVISED BY: _____

NO.	DATE	BY	REVISION