

SUFFOLK DISTRICT DESIGN UNIT

SUPERVISED BY: E. N. HOLLOWELL
 DESIGNED BY: D. B. WINSLOW
 CADD OPERATOR: J. G. WILSON
 REVISED BY:

PLN NO.	PROJECT	FILE NO.	SHEET NO.
06/27/97 102607	0630-099-165	0630-099-165	4

DESIGN FEATURES RELATING TO CONSTRUCTION OR TO REGULATION AND CONTROL OF TRAFFIC MAY BE SUBJECT TO CHANGE AS DEEMED NECESSARY BY THE DEPARTMENT

REVISED	FHWA REGION	STATE	FEDERAL AID PROJECT	ROUTE	STATE PROJECT	SHEET NO.
01-30-97	3	VA.		630	0630-099-165, M-501	4

NOTE: Contractor shall use extreme caution during excavation for subgrade due to lack of cover over 48", 42" and 16" Concrete Sanitary Force Main from Station 86+00± to Station 97+50±. Heavy Equipment to be restricted from operating within 6' of either side of the force mains until such time as excavation is removed by backhoe, grade all, etc. and the subgrade is placed. Contractor shall not excavate any material below the bottom of subgrade shown on the plan typical, unless otherwise directed by the Engineer. The Engineer shall contact Bill Harrison, Hampton Roads Sanitation District Systems Engineer, Telephone: (757-460-2261) two (2) working days prior to performing any excavation in the above noted locations. Basis of payment for this work to be same as other bid items.

■ DENOTES 12' HEAVY EQUIPMENT RESTRICTED OPERATING AREA.

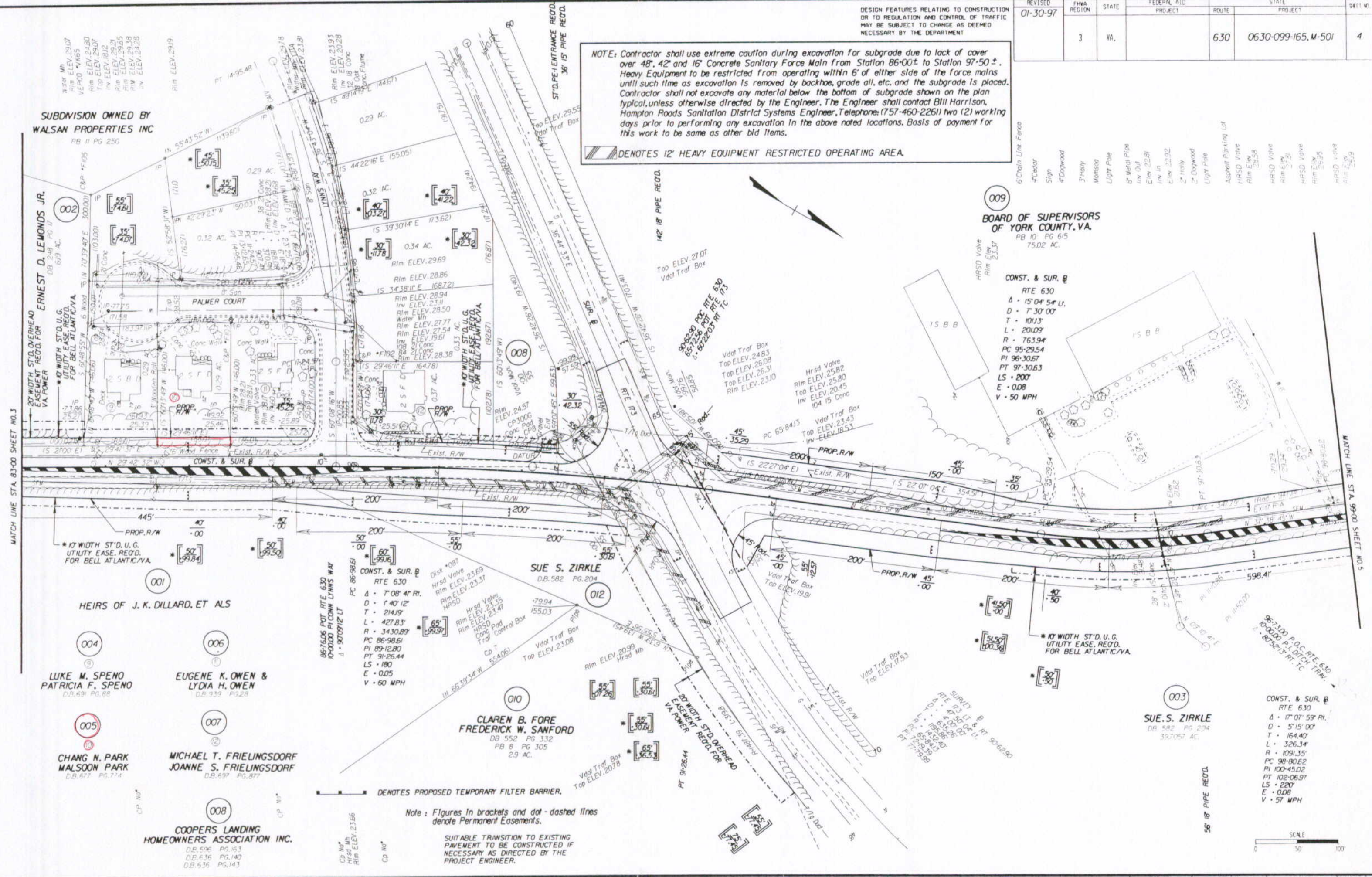

009
 BOARD OF SUPERVISORS
 OF YORK COUNTY, VA.
 PB 10 PG 615
 75.02 AC.

CONST. & SUR. B
 RTE 630
 Δ - 15' 04" 54" U.
 D - 7' 30" 00"
 T - 10113'
 L - 201.09'
 R - 763.94'
 PC 95+29.54
 PI 96+30.67
 PT 97+30.63
 LS - 200'
 E - 0.08
 V - 50 MPH

003
 SUE S. ZIRKLE
 DB 582 PG 204
 39.7057 AC.

CONST. & SUR. B
 RTE 630
 Δ - 17' 07" 59" R.
 D - 5' 15" 00"
 T - 164.40'
 L - 326.34'
 R - 1091.35'
 PC 98+80.62
 PI 100+45.02
 PT 102+06.97
 LS - 220'
 E - 0.08
 V - 57 MPH

001
 HEIRS OF J. K. DILLARD, ET ALS

004
 LUKE M. SPENO
 PATRICIA F. SPENO
 DB 691 PG 88

006
 EUGENE K. OWEN &
 LYDIA H. OWEN
 DB 939 PG 28

005
 CHANG N. PARK
 MALSOON PARK
 DB 677 PG 714

007
 MICHAEL T. FRIELINGS DORF
 JOANNE S. FRIELINGS DORF
 DB 697 PG 877

008
 COOPERS LANDING
 HOMEOWNERS ASSOCIATION INC.
 DB 526 PG 153
 DB 636 PG 140
 DB 636 PG 143

012
 SUE S. ZIRKLE
 DB 582 PG 204

010
 CLAREN B. FORE
 FREDERICK W. SANFORD
 DB 552 PG 332
 PB 8 PG 305
 2.9 AC.

■ DENOTES PROPOSED TEMPORARY FILTER BARRIER.

Note: Figures in brackets and dot-dashed lines denote Permanent Easements.

SUITABLE TRANSITION TO EXISTING PAVEMENT TO BE CONSTRUCTED IF NECESSARY AS DIRECTED BY THE PROJECT ENGINEER.

