

OYSTER PLANTING GROUNDS  
IN  
SOUTHWEST BRANCH, BACK RIVER  
ELISABETH CITY COUNTY,  
VIRGINIA.

UNDER LEASE FROM THE STATE ON MARCH 20<sup>th</sup> 1934.

*Thos. B. Neidiger*  
ENGINEER TO COMMISSION OF FISHERIES OF VIRGINIA.

SCALE 1:5000.

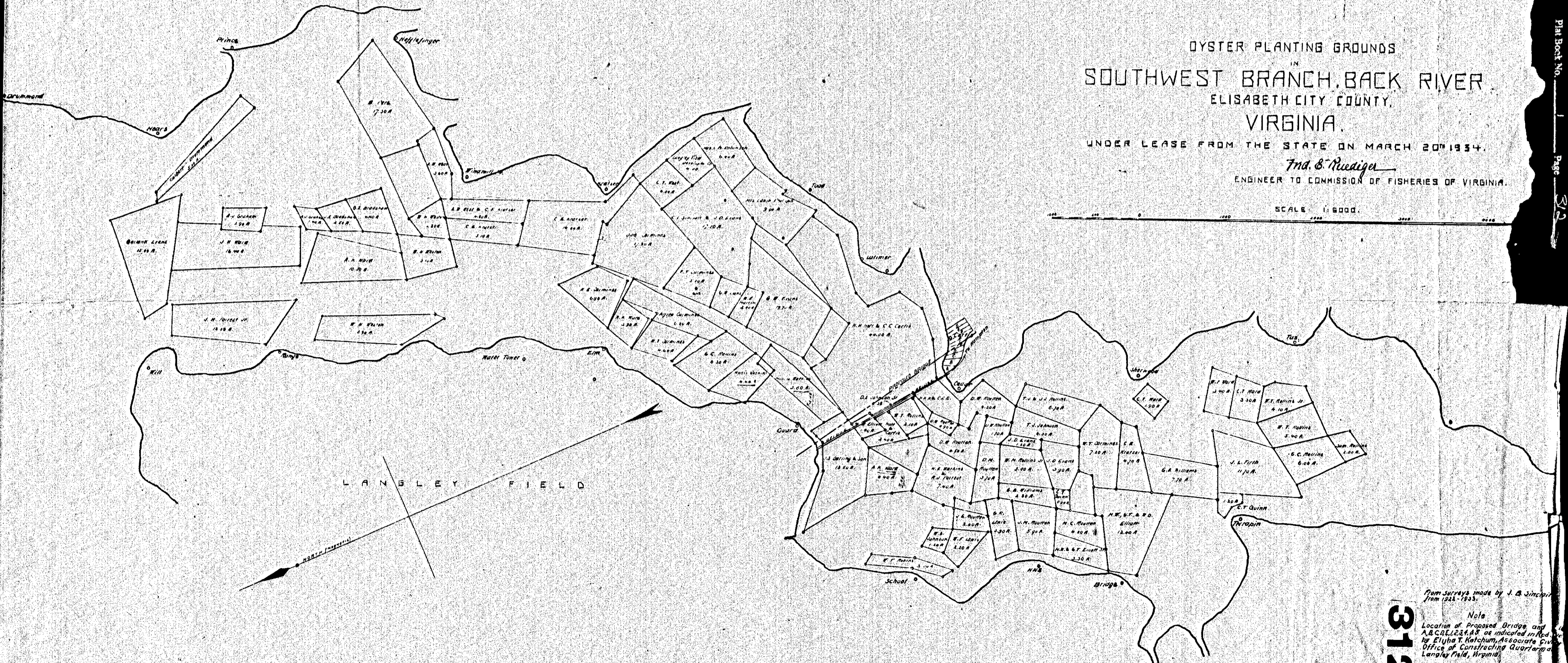

From surveys made by J. B. Simpson  
from 1921-1933.  
Note  
Location of Proposed Bridge and  
A.B.C.R. 1234, 1235 as indicated on Red  
by Elysa T. Ketchum, Associate Engineer  
Office of Constructing Quartermaster  
Langley Field, Virginia.

**312**

Plan Book No. 1 Page 312