

VIRGINIA ELECTRIC & POWER CO.  
WILLIAMSBURG-WALLER SUBSTATION  
DISTRIBUTION LINE  
PLAT TO ACCOMPANY MAP OF WAY AGREEMENT  
MARTHA S HENDERSON  
COUNTY YORK  
STATE VA.  
SCALE 1 INCH = 100 FT  
NO. 5  
SUBMITTED BY

DRAWER NO. SHEET NO.

616

Page 616  
Filed: July 28, 1941  
Deed Recorded: Deed Book No. 56, page 574.  
Shyde Shallenbary, Clerk.

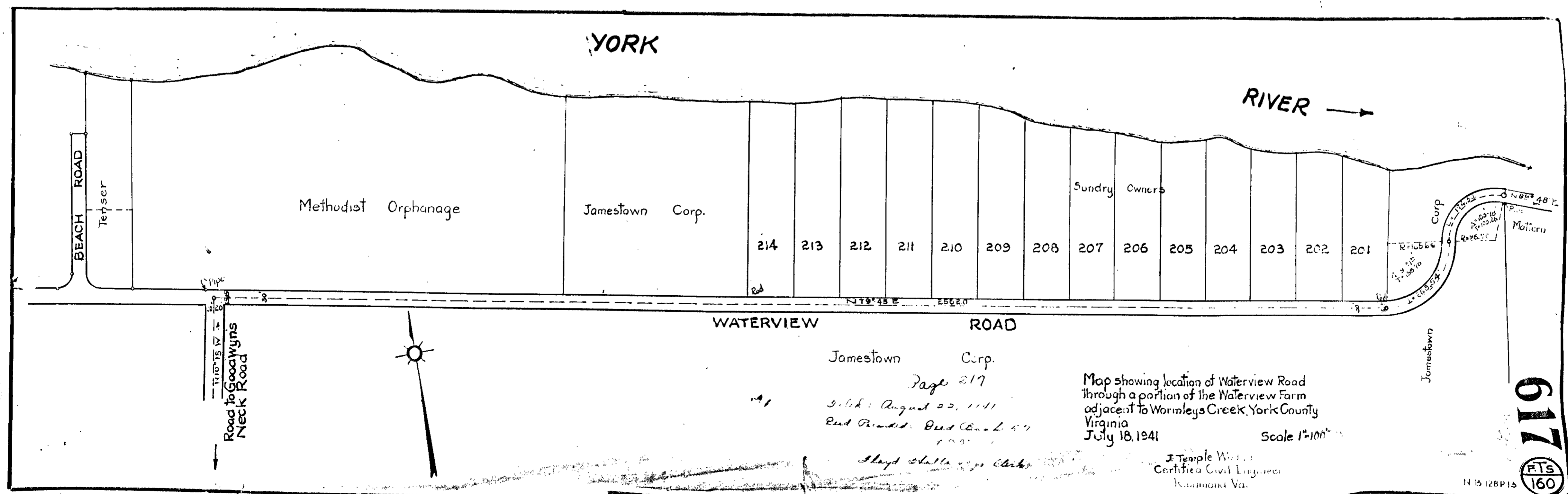

This map was prepared by the Virginia State Surveyor's Office under the direction of the State Surveyor, Richmond, Virginia, and is subject to the provisions of the Virginia Surveying Act of 1928, as amended.