

316X

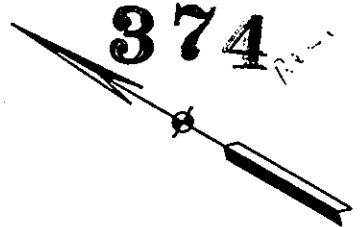

PLEASURAMA/WILLIAMSBURG, INC.

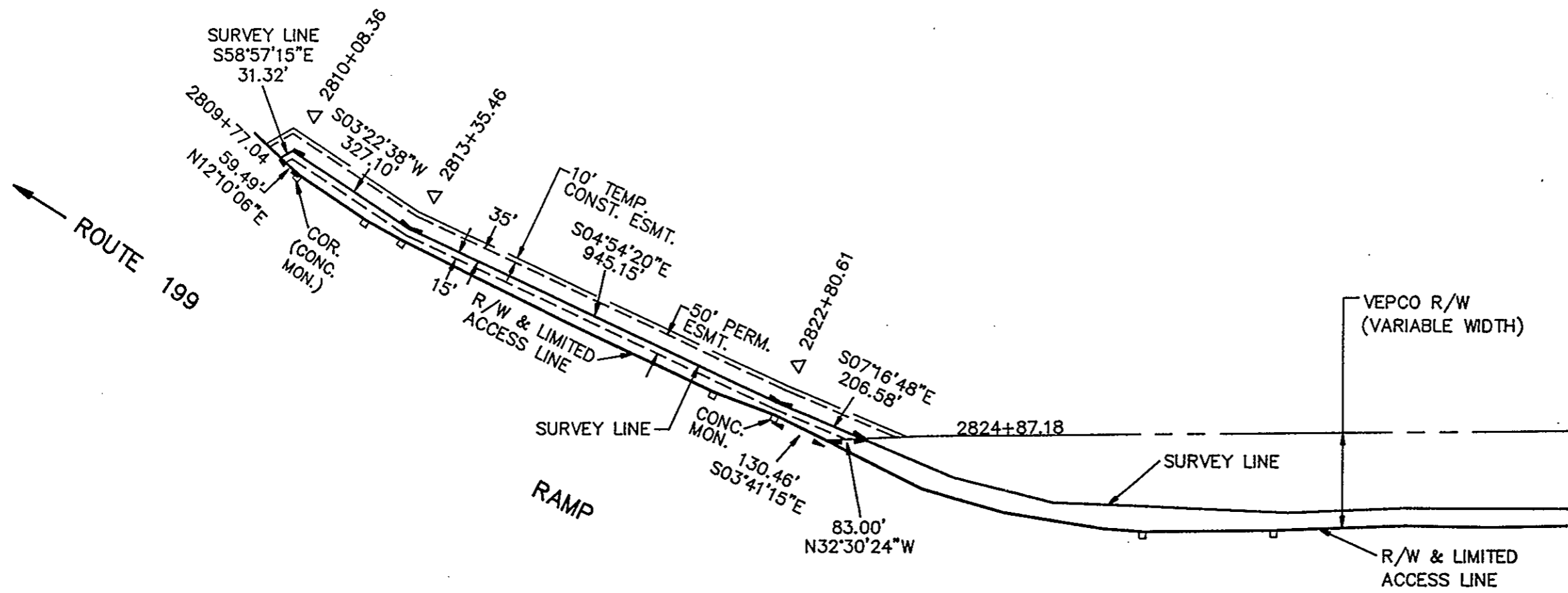

INTERSTATE 64 & ROUTE 168
(VARIABLE WIDTH)

Filed in the Clerk's Office, Circuit Court, York Co., Va.
the 2nd day of December 1991

Teste: 10:42
Nancy B. Kane, Clerk
[Signature] D.C.
Plat Book 1P page 374

PARCEL 316X
AREA OUTSIDE VEPCO R/W:
PERM: 1.77 AC.
TEMP: 0.38 AC.

 **Virginia Natural Gas**
VNG LATERAL

PLAT TO ACCOMPANY RIGHT-OF-WAY
AGREEMENT WITH

PLEASURAMA/WILLIAMSBURG, INC.

DISTRICT/TOWNSHIP BRUTON	COUNTY YORK	STATE VA
-----------------------------	----------------	-------------

SURVEYED BY SCHNEIDER ENGINEERS

4	3	2	1
	AREA OUT-SIDE VEPCO RSA	REVISED ESMT. RSA	REVISED R RSA
	8/26/91	5/06/91	3/30/91

MERIDIAN SOURCE: VIRGINIA COORDINATE SYSTEM OF 1927 (SOUTH ZONE)

SCALE 1"=300'	DATE 7/02/90	NO. 316X
------------------	-----------------	-------------