

YORKSHIRE DOWNS CONDOMINIUM

PHASE XII

COUNTY OF YORK, VIRGINIA

DATE : 7 JUNE 1993

DAVIS & ASSOCIATES

SURVEYORS - PLANNERS

4033 GEORGE WASHINGTON

MEMORIAL HIGHWAY

YORKTOWN, VIRGINIA 23692

(804) 898-9414

SCALE : AS SHOWN

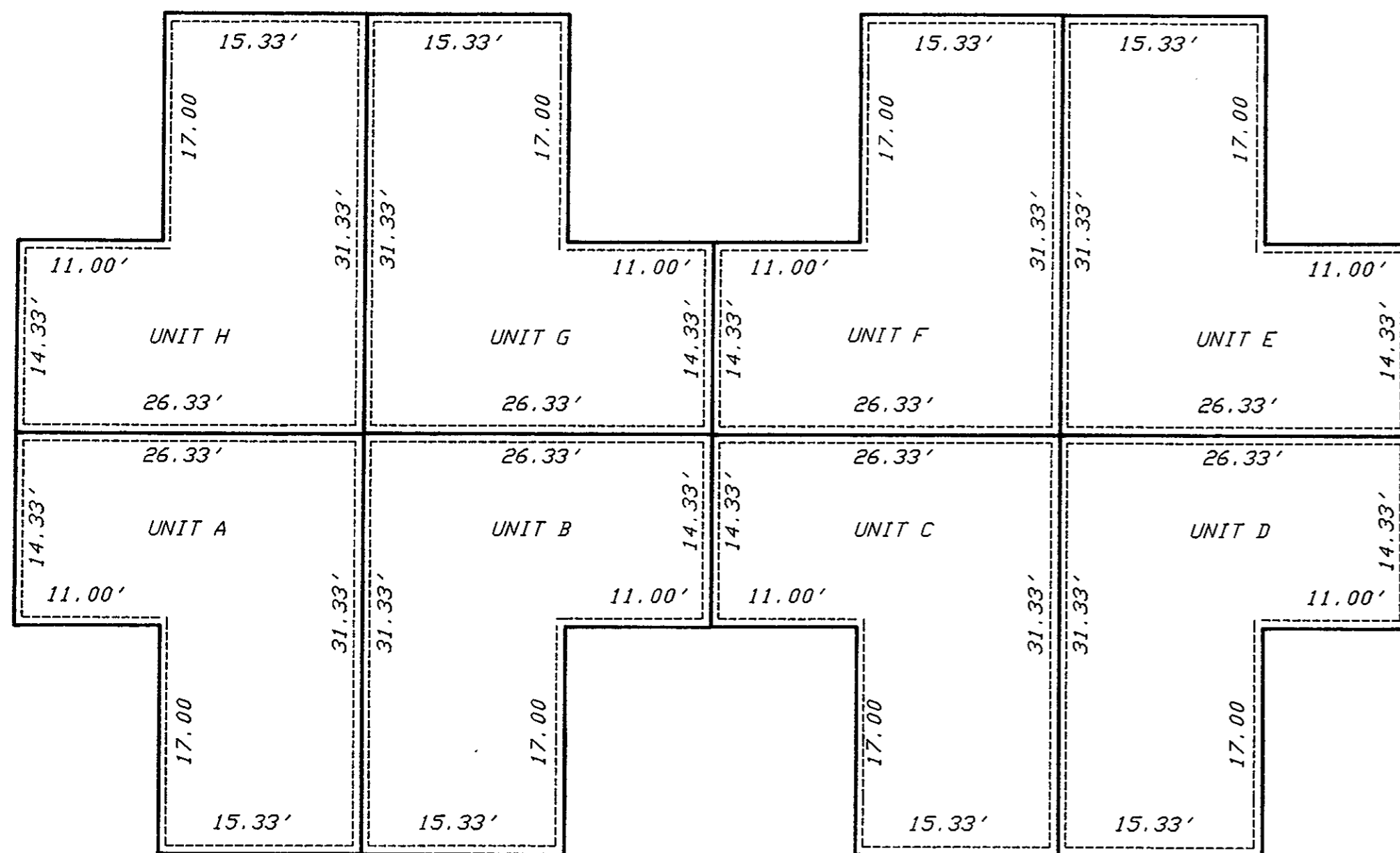

SECOND FLOOR PLAN

SCALE : 1" = 10'

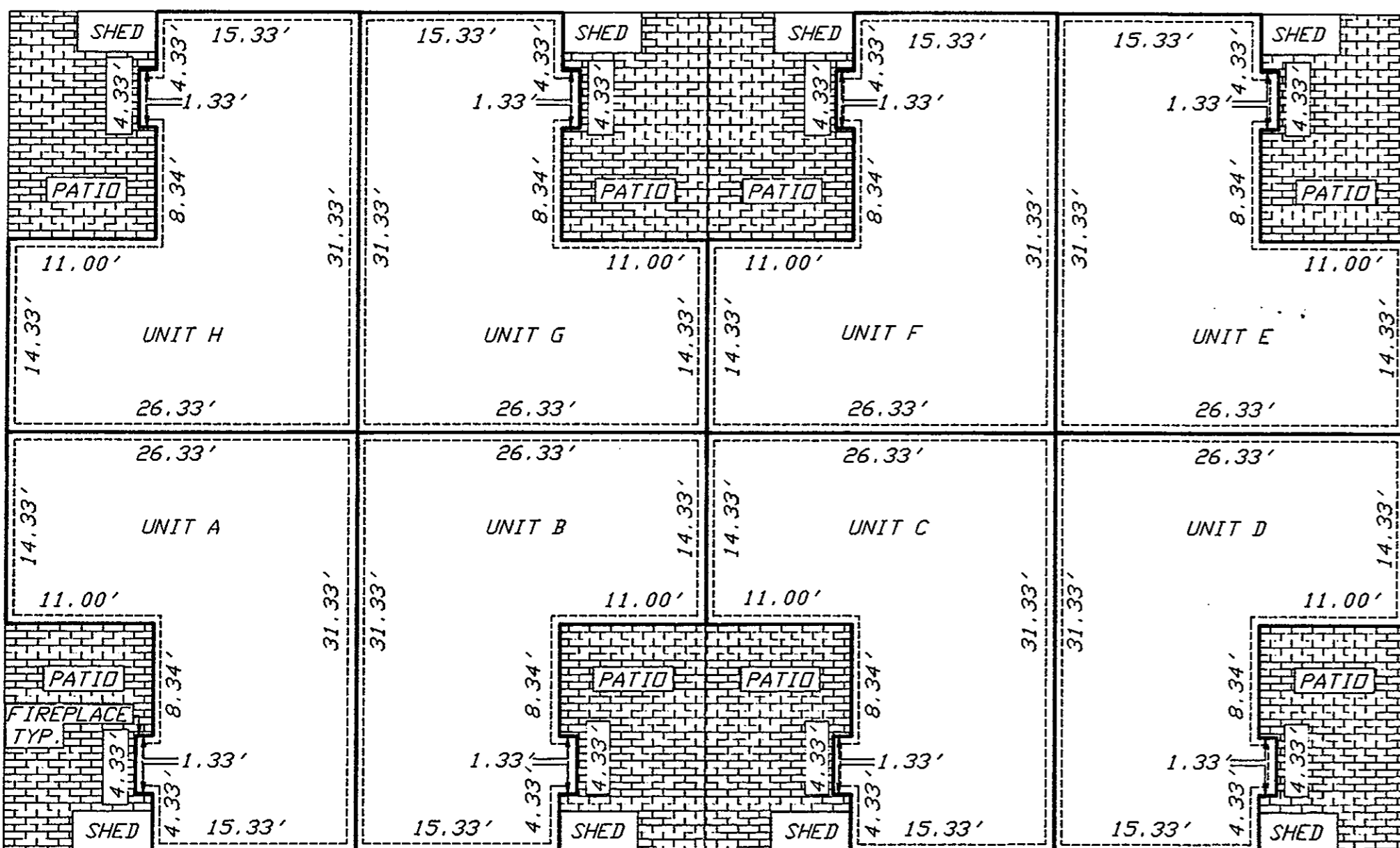

FIRST FLOOR PLAN

SCALE : 1" = 10'
0 5 10 20 30
GRAPHIC SCALE

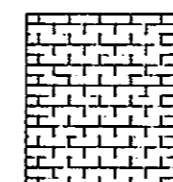

DENOTES LIMITED COMMON ELEMENTS

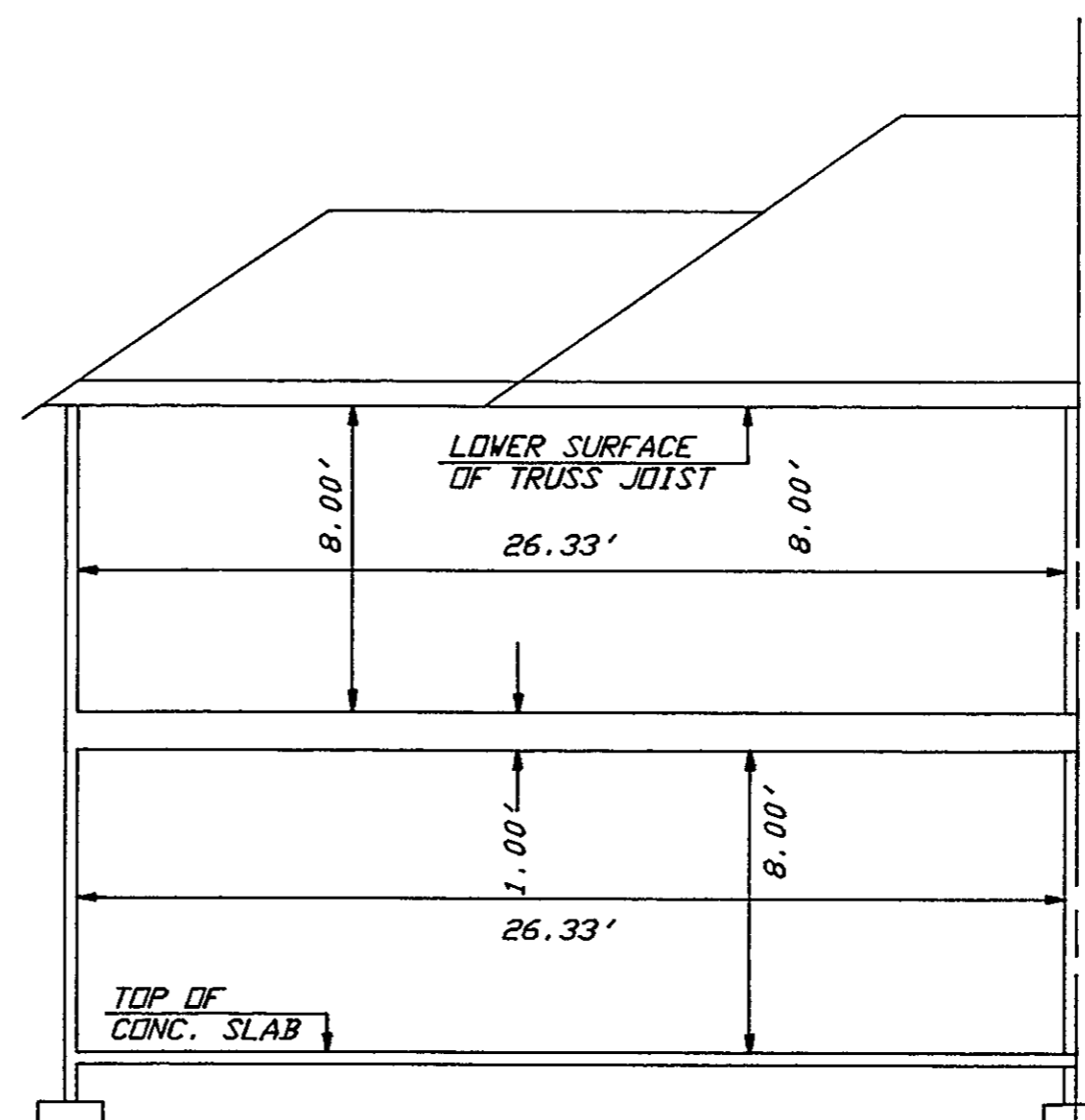

TYPICAL SECTION

SCALE : 1" = 5'
0 2.5 5 10 15
GRAPHIC SCALE

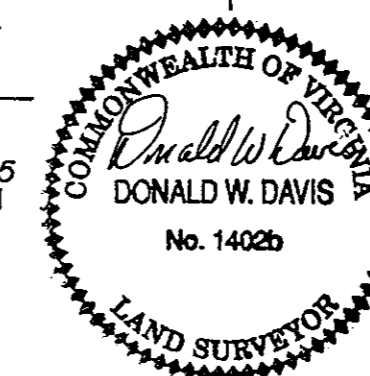

NOTE : SECTIONAL VIEWS OF UNITS AND ALL UNIT DIMENSIONS WERE OBTAINED FROM THE ARCHITECTURAL PLANS OF RICHARD LEE GRIMSTEAD, A REGISTERED ARCHITECT WITH THE COMMONWEALTH OF VIRGINIA.

I, DONALD W. DAVIS, A DULY REGISTERED SURVEYOR, DO HEREBY CERTIFY THAT THIS DRAWING IS ACCURATE (WITHIN NORMAL TOLERANCES) AND COMPLIES WITH SECTION 55-79.58(b) OF THE CONDOMINIUM ACT AND THAT THE UNITS SHOWN HEREON ARE SUBSTANTIALLY COMPLETED IN ACCORDANCE HEREIN.

Donald W. Davis
DONALD W. DAVIS, C.L.S.

7 JUNE 93
DATE

SHEET 2 OF 2

- SYMBOLS -

- DENOTES IRON PIPE FOUND
- DENOTES IRON PIPE TO BE SET AT ALL PROPERTY LINE JUNCTURES
- DENOTES CONCRETE MONUMENTS FOUND
- DENOTES CONCRETE MONUMENTS TO BE SET

Al Maddalena
for 9/9/93

STATE OF VIRGINIA
COUNTY OF YORK
IN THE CLERK'S OFFICE OF THE CIRCUIT COURT FOR THE COUNTY OF YORK THE 9 DAY OF September 1993 THIS MAP WAS PRESENTED AND ADMITTED TO RECORD AS THE LAW DIRECTS IN PLAT BOOK 11 PAGE 657

TESTE : NANCY B. KANE, CLERK
BY : *Richard R. Darouse*