

REVISED  
 SUBDIVISION PLAT OF  
**YORKSHIRE DOWNS**  
 CONDOMINIUM

PHASE XV  
 COUNTY OF YORK, VIRGINIA  
 DATE : 9 FEBRUARY 1994  
 REVISED DATE : 15 APRIL 1994  
**DAVIS & ASSOCIATES**

SURVEYORS - PLANNERS  
 4033 GEORGE WASHINGTON  
 MEMORIAL HIGHWAY  
 YORKTOWN, VIRGINIA 23692  
 (804) 898-9414

SCALE : AS SHOWN

SHEET 2 OF 2

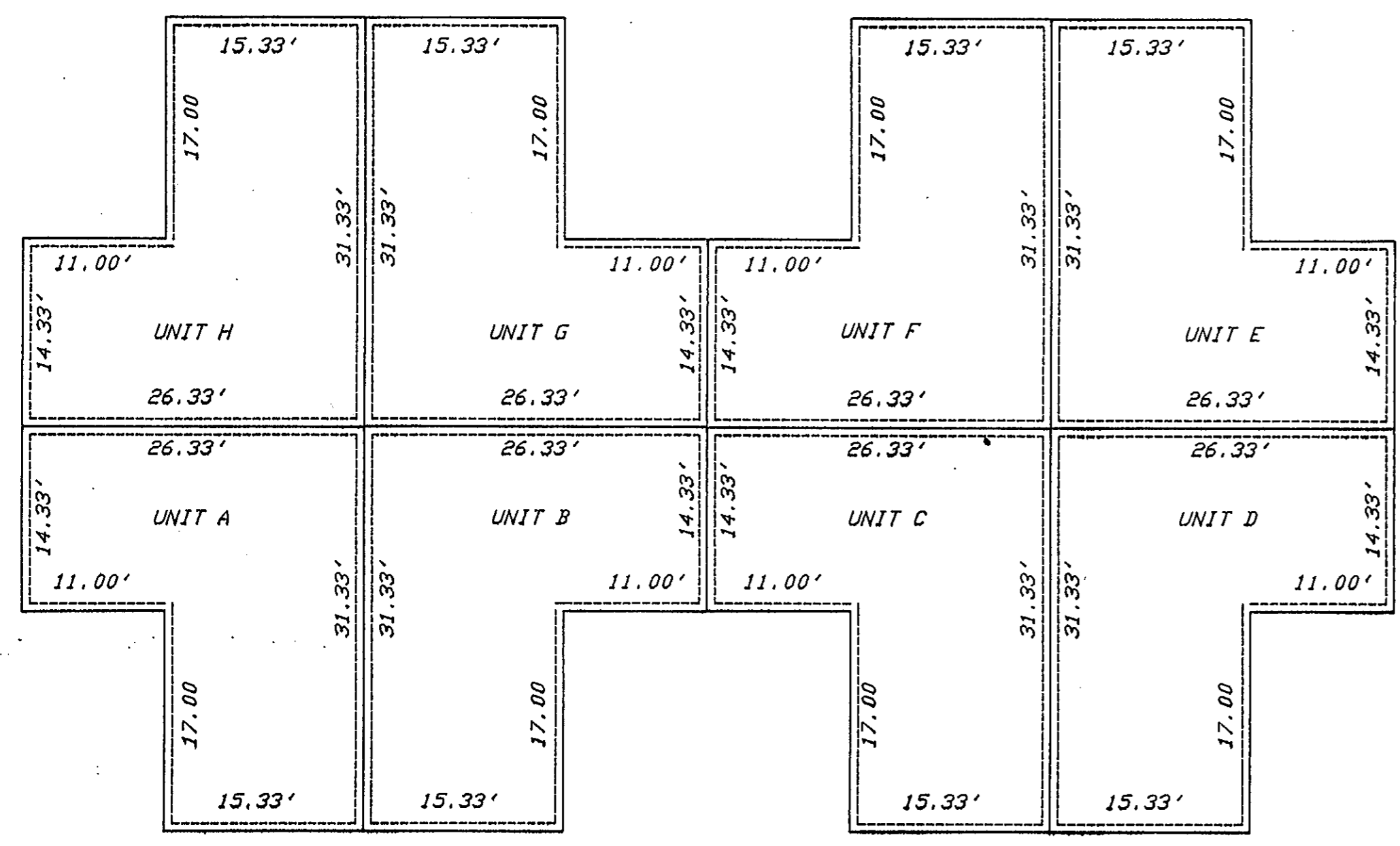

SECOND FLOOR PLAN

SCALE : 1" = 10'

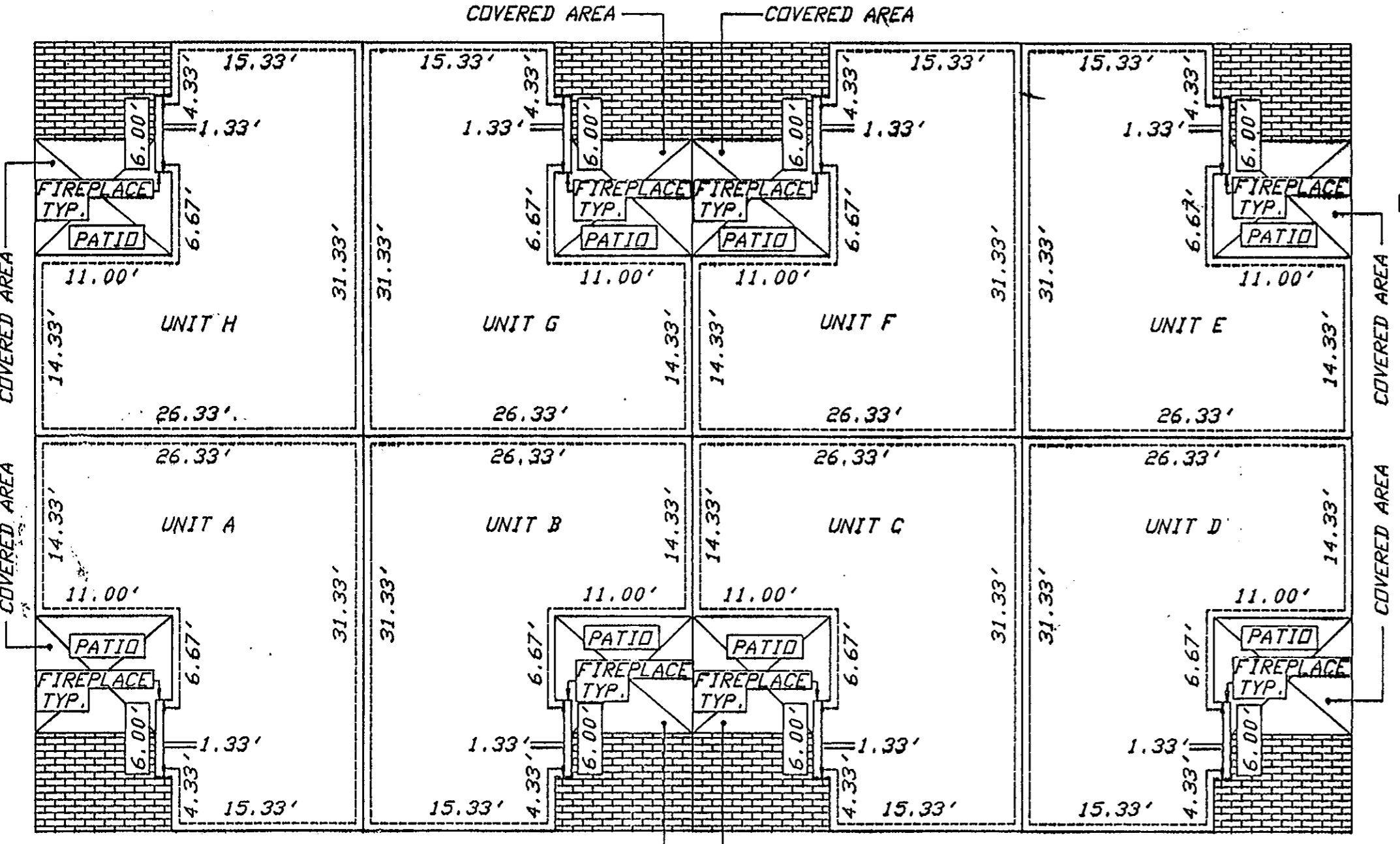

FIRST FLOOR PLAN

SCALE : 1" = 10'

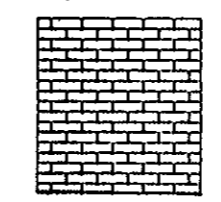
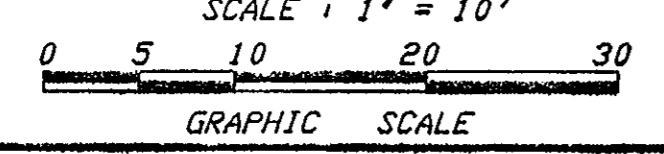

DENOTES LIMITED COMMON ELEMENTS

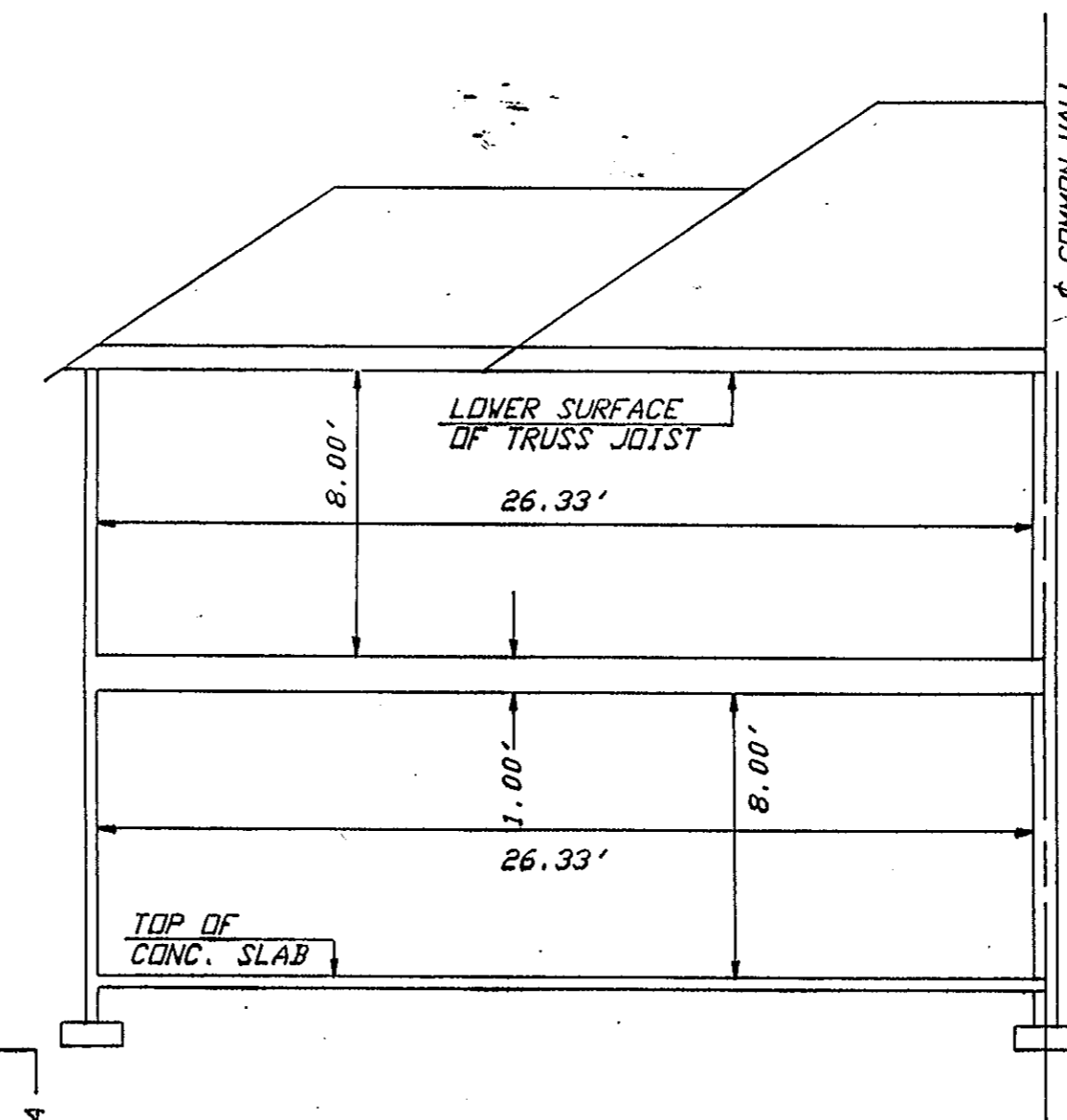

TYPICAL SECTION

SCALE : 1" = 5'

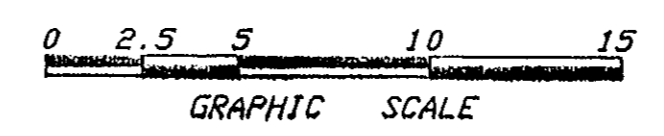

NOTE : SECTIONAL VIEWS OF UNITS AND ALL UNIT DIMENSIONS WERE OBTAINED FROM THE ARCHITECTURAL PLANS OF RICHARD LEE GRINSTEAD, A REGISTERED ARCHITECT WITH THE COMMONWEALTH OF VIRGINIA.

I, DONALD W. DAVIS, A DULY REGISTERED SURVEYOR, DO HEREBY CERTIFY THAT THIS DRAWING IS ACCURATE (WITHIN NORMAL TOLERANCES) AND COMPLIES WITH SECTION 55-79.58(b) OF THE CONDOMINIUM ACT AND THAT THE UNITS SHOWN HEREON ARE SUBSTANTIALLY COMPLETED IN ACCORDANCE HEREIN.

*Donald W. Davis*  
 DONALD W. DAVIS, C.L.S.      9 FEB 94  
 DATE

- SYMBOLS -

- DENOTES IRON PIPE FOUND
- DENOTES IRON PIPE TO BE SET AT ALL PROPERTY LINE JUNCTURES
- DENOTES CONCRETE MONUMENTS FOUND
- DENOTES CONCRETE MONUMENTS TO BE SET

STATE OF VIRGINIA  
 COUNTY OF YORK  
 IN THE CLERK'S OFFICE OF THE CIRCUIT COURT FOR THE COUNTY OF YORK THE 20<sup>th</sup> DAY OF April 1994, THIS MAP WAS PRESENTED AND ADMITTED TO RECORD AS THE LAW DIRECTS IN PLAT BOOK 12 PAGE 38

TESTE : *Nancy B. Kay, Clerk*  
 BY : *R. W. Davis*