

PUB. ROAD DIV. NO.	STATE	FEDERAL AID		STATE		SHEET NO.	TOTAL SHEETS
		ROUTE	PROJECT	ROUTE	PROJECT		
2	VA.	24-04-5(B)	168	4899-01	16	23	

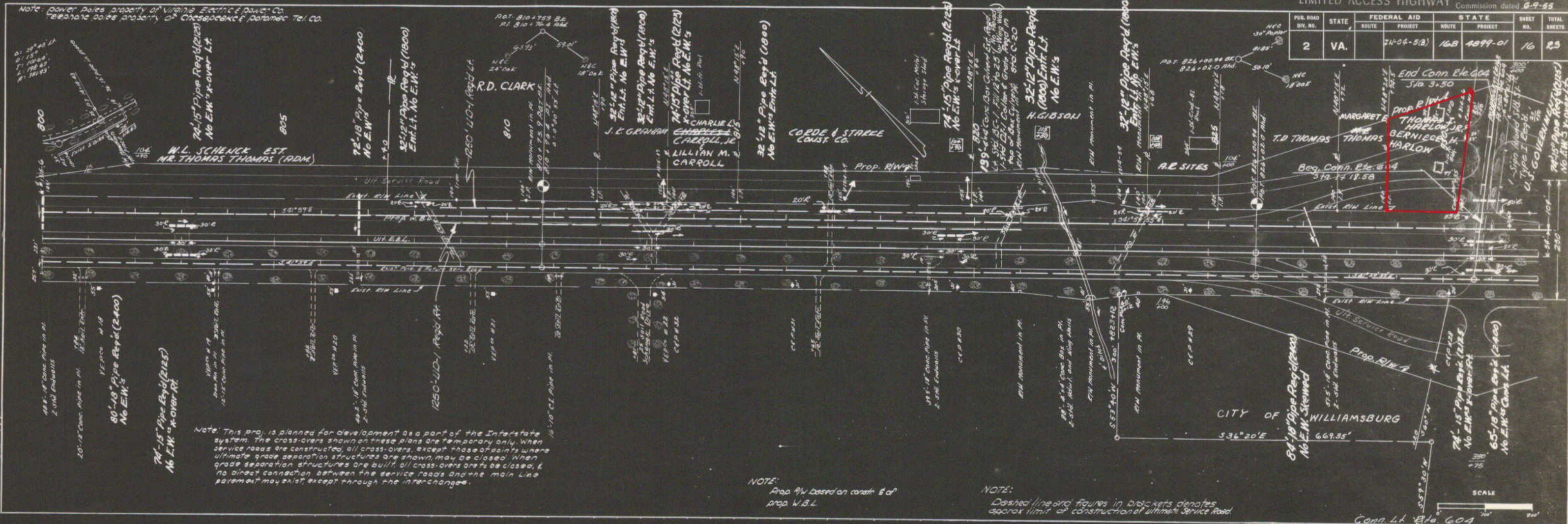

Note: power poles property of Virginia Electric Power Co.
Telephone poles property of Chesapeake Potomac Tel. Co.

Note: This proj. is planned for development as a part of the Interstate system. The cross-overs shown on these plans are temporary only. When service roads are constructed, all cross-overs, except those at points where ultimate grade separation structures are shown, may be closed. When grade separation structures are built, all cross-overs are to be closed, & no direct connection between the service roads and the main line pavement may exist, except through the interchange.

NOTE:
Prop. R/W based on const. § of prop. W.B.L.

NOTE:
Dashed line and figures in brackets denotes approx. limit of construction of ultimate Service Road.

SCALE
1" = 100'

PLAN
SURVEYED BY J.E. GALT
NOTED BY M.E. GANNETT
DATE 1-22-55
NO. 24237
BY OF WAY CHECKED

Conn. Lt. Eto. 604