

FOREST HEIGHTS, INC.

MAGNETIC NORTH OCT. 29, 1950

NEWPORT NEWS WATERWORKS COMMISSION

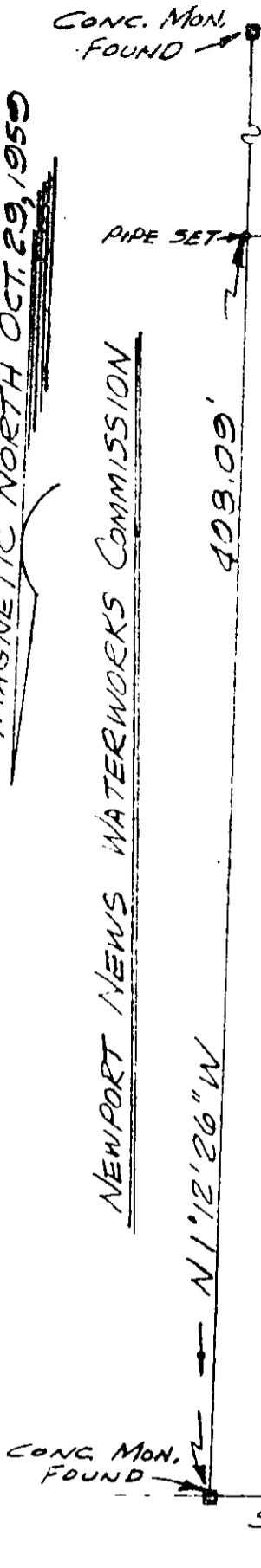

PARCEL "A"  
FOREST HEIGHTS, INC.  
to  
ELVIN R. REED

FOREST HEIGHTS, INC.

100.0' 129.05'  
S87°50'45"W  
ROUTE 173

TO ROUTE 168

PLAT OF THE PROPERTY OF ELVIN R. REED	
PARCEL "A"	1.02 AC.
PART OF THE PROPERTY FORMERLY BELONGING TO FOREST HEIGHTS, INC. YORK COUNTY, VA.	
David G. Cutler	
DAVID G. CUTLER: CERT. LAND SURVEYOR NEWPORT NEWS - VIRGINIA SCALE: 1" = 50' MAY 16, 1960	

FB 119 Pg 3

- CALE REALTY CO. -