

OLIVE GRAY

FOUND  $N44^{\circ}07'30''E$  75.00' SET

RECORD MERIDIAN  
CLOTHES LINE  
POST ENCROACH. ON LOT 12

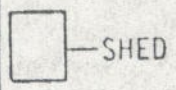

SHED  
124 BATTLE ROAD  
19,012.18 SQ. FT.  
0.436 ACRE

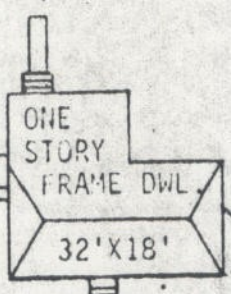

ONE STORY  
FRAME DWL  
32' X 18'

DRIVEWAY  
ENCROACHMENT  
ON LOT 12

LOT 12  
MARLBANK HEIGHTS  
SUBDIVISION



$N38^{\circ}11'00''W$  249.60'

150'

259.64'

$S38^{\circ}19'57''E$

OLIVE GRAY

ELECTRIC &  
PHONE SERVICE

VEPCO EASEMENT

FOUND  $S51^{\circ}49'00''W$  75.00' SET

BATTLE ROAD  
ROUTE 718

TO HORNSBYVILLE

975' TO CONCRETE MONUMENT  
BETWEEN SECT. 1&2 MARLBANK HEIGHTS

\* REF: DB 181/405; 76/355  
DB 69/52  
PB 8/153