

435-11

BOOK 435 PAGE 11

SCALE: 1"=10'

NORTH

N/O
O'HARA

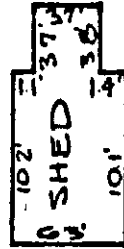

INSET

N44°01'30"E 100.91'

FRAME
SHED. SEE
INSET FOR
DIMENSIONS

175.30'

538.11'E

LOT E

LOT 6

☉ OF DITCH

LOT 7

SCALE: 1"=30'

1"=30'

SATELLITE
DISH
ANTENNA

N38°11'W

108.81'

POWER
POLE

POWER
POLE

CON. POWER
LINE

100.0'

S51°49'W

BATTLE ROAD (Rte. 173)

THIS IS TO CERTIFY THAT ON FEBRUARY 18, 1986, THIS OFFICE SURVEYED THE PROPERTY SHOWN ON THIS PLAT, SUBJECT TO EASEMENTS, SERVITUDES & COVENANTS ON RECORD.



PLAT OF THE PROPERTY OF
PATRICK J. GOODEYON

lot 6

101
Hazel Bank

NEAR THE HILLS HEIGHTS

COUNTY OF YORK, VIRGINIA

REF: PB. 4, PG. 117

J. J. ALFONSO

SURVEYOR - PLANNER

804-595-2513
NEWPORT NEWS, VIRGINIA

SCALE AS SHOWN

JOB NO.

DATE

2/17/86

FD

43 PG 11

A 11

24B ① Lot 6
(Sec. 1)