

SUFFOLK DISTRICT DESIGN UNIT

DESIGN FEATURES RELATING TO CONSTRUCTION OR TO REGULATION AND CONTROL OF TRAFFIC MAY BE SUBJECT TO CHANGE AS DEEMED NECESSARY BY THE DEPARTMENT

| REVISED   | FINA REGION | STATE | FEDERAL AID PROJECT | ROUTE | STATE PROJECT       | SHEET NO. |
|---|-------------|-------|---------------------|-------|---------------------|-----------|
| 4/30/97<br>7/08/97<br>8/25/97<br>8/28/97<br>9/23/97 | 3           | VA.   |                     | 0603  | 0603-099-171, C-501 | 9         |

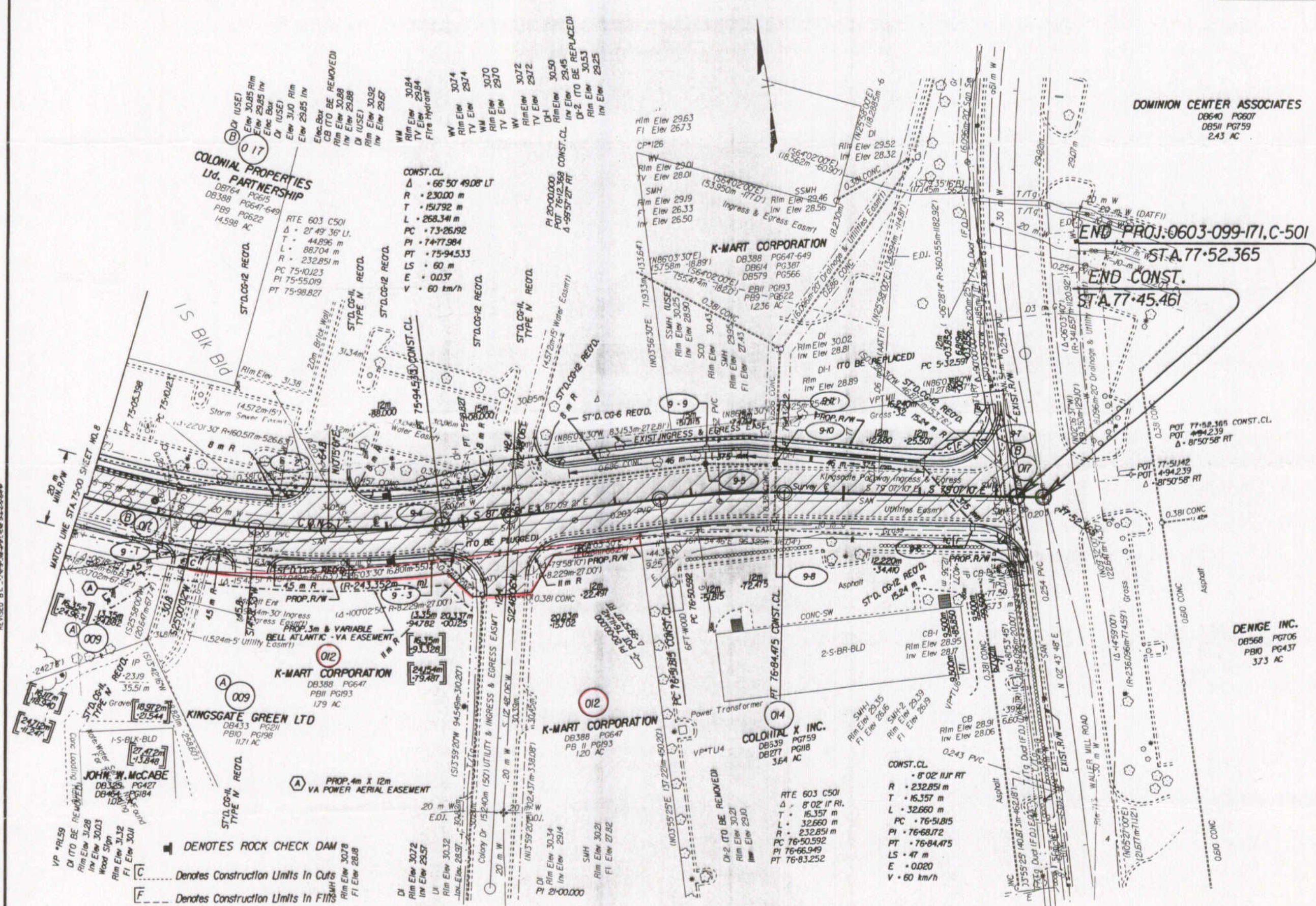

- 9-1  
1-DROP INLET RECD. RT. ST'D. DI-3A  
INV. (30.07), HEIGHT - 1.22m
- 3m - 375mm CONC. PIPE EXTENSION RECD. RT.  
INV. IN (30.07), INV. OUT (30.03)  
(HEIGHT OF COVER 0.78m)
- 9-2  
1-DROP INLET RECD. LT.  
ST'D. DI-3C-L-1.83m  
INV. (29.85), HEIGHT - 0.70m
- 9-3  
EXIST. DROP INLET TO BE MODIFIED  
TO ST'D. DI-2D, INV. (29.57), H- 1.08m
- 9-4  
EXIST. DROP INLET TO BE MODIFIED TO  
ST'D. DI-2F-L-1.83m  
INV. (29.25), HEIGHT - 1.08m
- 9-5  
EXISTING DROP INLET TO BE  
MODIFIED TO A ST'D. MH-1,  
TOP ELEV. (130.0), INV. (28.90)
- 9-6  
1-DROP INLET ST'D. DI-3A RECD.  
INV. (29.05), HEIGHT - 0.956m
- 9-6 9-7  
21.03m - 375mm CONC. PIPE RECD.  
INV. IN (29.05), INV. OUT (29.00)  
(HEIGHT OF COVER 0.300m)
- 9-7  
1-DROP INLET ST'D. DI-3A RECD.  
INV. (29.00), HEIGHT - 0.72m
- 9-8  
EXISTING DROP INLET TO BE MODIFIED  
TO ST'D. DI-2E-L-1.83m  
INV. (29.0), H- 0.66m
- 9-9  
1-DROP INLET ST'D. DI-3B-L-1.22m RECD.  
INV. (28.91), HEIGHT - 1.13m
- 9-9 9-5  
3.05m - 375mm CONC. PIPE RECD.  
INV. IN (28.91), INV. OUT (28.91)  
(HEIGHT OF COVER 0.600m)
- 9-10  
EXISTING DROP INLET TO MODIFIED  
TO ST'D. MH-1, TOP ELEV. (29.94), INV. (28.89)  
1-FRAME & COVER RECD. MH-1
- 9-7 9-11  
37.49m - 375mm CONC. PIPE RECD.  
INV. IN (29.00), INV. OUT (28.89)  
(HEIGHT OF COVER 0.450mm)
- 9-11  
1-DROP INLET ST'D. DI-3B-L-1.22m RECD.  
INV. (28.89), HEIGHT - 1.05m

FIGURES IN BRACKETS AND DOT - DASHED LINES DENOTE PERMANENT EASEMENTS.

/// DENOTES DEMOLITION OF PAVEMENT

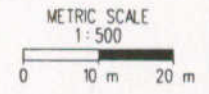

SUPERVISED BY: D. WARRICK  
DESIGNED BY: L. N. HOLLOWELL  
CHECKED BY: R. T. SCOTT, JR. (757) 825-2558  
CAD OPERATOR: E. L. STRONGFIELD  
REVISED BY: J. H. WARRICK (757) 825-2558

08/23/97 06:45:48