

COUNTY OF YORK  
GEODETIC CONTROL  
VIRGINIA STATE GRID

YORK COUNTY  
APPROVED FOR RECORDATION  
BY: *J. B. August*  
TITLE: *Right-of-Way Agent*  
DATE: *April 13, 2001*

N/F  
GRADY L. MONTGOMERY  
TM# 25A(2)-A  
DB 102, PG 72

N/F  
NORWOOD P. MONTGOMERY  
TM# 25A(2)-A2  
DB 212, PG 297  
PB 5, PG 204  
PB 6, PG 111

N/F  
JOAN E. MILLS  
TM# 25A(2)-A1  
DB 981, PG 378

N/F  
ROLAND R. & HELEN B. MONTGOMERY  
TM# 25A(3)-10  
DB 602, PG 608  
PB 6, PG 111

10'±20' UTILITY EASEMENT  
AREA = 200.00 S.F.  
OR 0.01 AC.

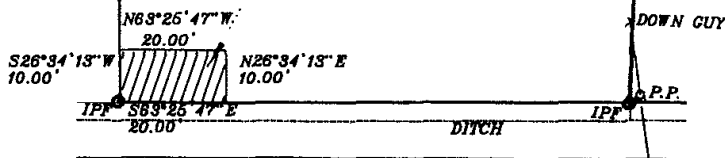

SUNSET DRIVE 40' R/W

ADDRESS: 102 SUNSET DRIVE

PLAT OF EASEMENT CONVEYANCE  
FROM  
NORWOOD P. MONTGOMERY  
TO  
COUNTY OF YORK, VIRGINIA

LOCATED: GRAFTON MAGISTERIAL DISTRICT,  
YORK COUNTY, VIRGINIA

DATE: FEBRUARY 2, 2000 SCALE: 1" = 30'

JAMES R. MITCHELL

0014528

2/2/00

MITCHELL-WILSON ASSOCIATES, P.C.  
CIVIL ENGINEERS & LAND SURVEYORS  
720 MAIN STREET, SUITE 112, 2ND FLOOR, P.O. BOX 1269  
WEST POINT, VIRGINIA 23181 (804) 843-9744