

Design File: ... Ref. File: ... Levels On: ...

HAMPTON ROADS DISTRICT DESIGN UNIT

DESIGN FEATURES RELATING TO CONSTRUCTION OR TO REGULATION AND CONTROL OF TRAFFIC MAY BE SUBJECT TO CHANGE AS DEEMED NECESSARY BY THE DEPARTMENT

REVISION	DATE	BY	DESCRIPTION
1	VA		

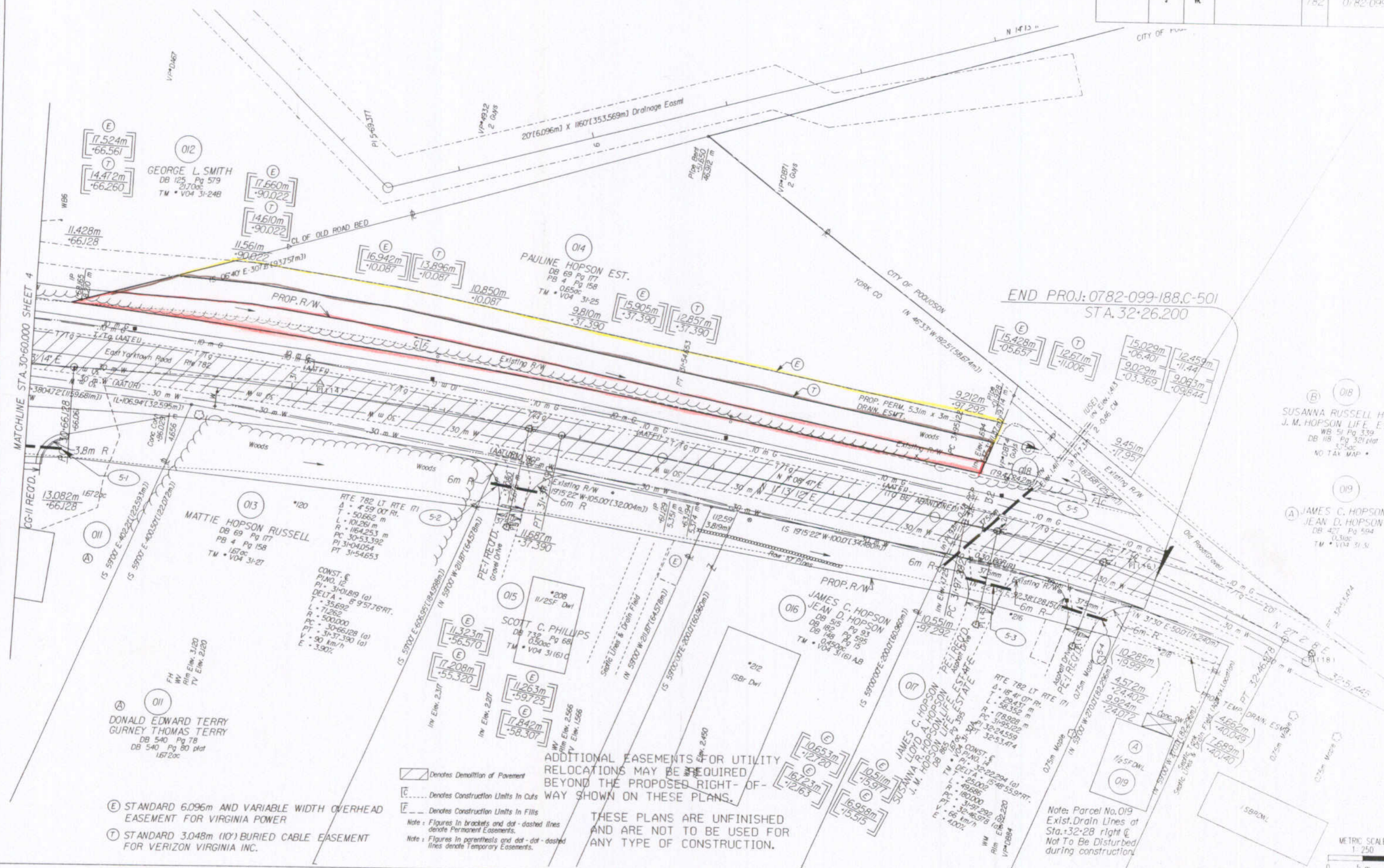

ADDITIONAL EASEMENTS FOR UTILITY RELOCATIONS MAY BE REQUIRED BEYOND THE PROPOSED RIGHT-OF-WAY SHOWN ON THESE PLANS.

THESE PLANS ARE UNFINISHED AND ARE NOT TO BE USED FOR ANY TYPE OF CONSTRUCTION.

- (E) STANDARD 6.096m AND VARIABLE WIDTH OVERHEAD EASEMENT FOR VIRGINIA POWER
- (T) STANDARD 3.048m (10') BURIED CABLE EASEMENT FOR VERIZON VIRGINIA INC.

- Denotes Demolition of Pavement
- Denotes Construction Limits in Cuts
- Denotes Construction Limits in Fills
- Figures in brackets and dot-dashed lines denote Permanent Easements.
- Figures in parenthesis and dot-dot-dashed lines denote Temporary Easements.

Note: Parcel No. 019 Exist. Drain Lines at Sta. 32+28 right of Way Not To Be Disturbed during construction



SURVEYED BY: ...  
 DESIGNED BY: ...  
 CAD OPERATOR: ...  
 REVISED BY: ...

2/9/02 10:26:22