

Design File - c:\document and settings\j... Ref. File - c:\document and settings\j...
 Design Date - 1/13/01 Levels On - 140, 145, 150, 155, 160, 165, 170, 175, 180, 185, 190, 195, 200, 205, 210, 215, 220, 225, 230, 235, 240, 245, 250, 255, 260, 265, 270, 275, 280, 285, 290, 295, 300, 305, 310, 315, 320, 325, 330, 335, 340, 345, 350, 355, 360, 365, 370, 375, 380, 385, 390, 395, 400, 405, 410, 415, 420, 425, 430, 435, 440, 445, 450, 455, 460, 465, 470, 475, 480, 485, 490, 495, 500, 505, 510, 515, 520, 525, 530, 535, 540, 545, 550, 555, 560, 565, 570, 575, 580, 585, 590, 595, 600, 605, 610, 615, 620, 625, 630, 635, 640, 645, 650, 655, 660, 665, 670, 675, 680, 685, 690, 695, 700, 705, 710, 715, 720, 725, 730, 735, 740, 745, 750, 755, 760, 765, 770, 775, 780, 785, 790, 795, 800, 805, 810, 815, 820, 825, 830, 835, 840, 845, 850, 855, 860, 865, 870, 875, 880, 885, 890, 895, 900, 905, 910, 915, 920, 925, 930, 935, 940, 945, 950, 955, 960, 965, 970, 975, 980, 985, 990, 995, 1000

SUFFOLK DISTRICT DESIGN UNIT

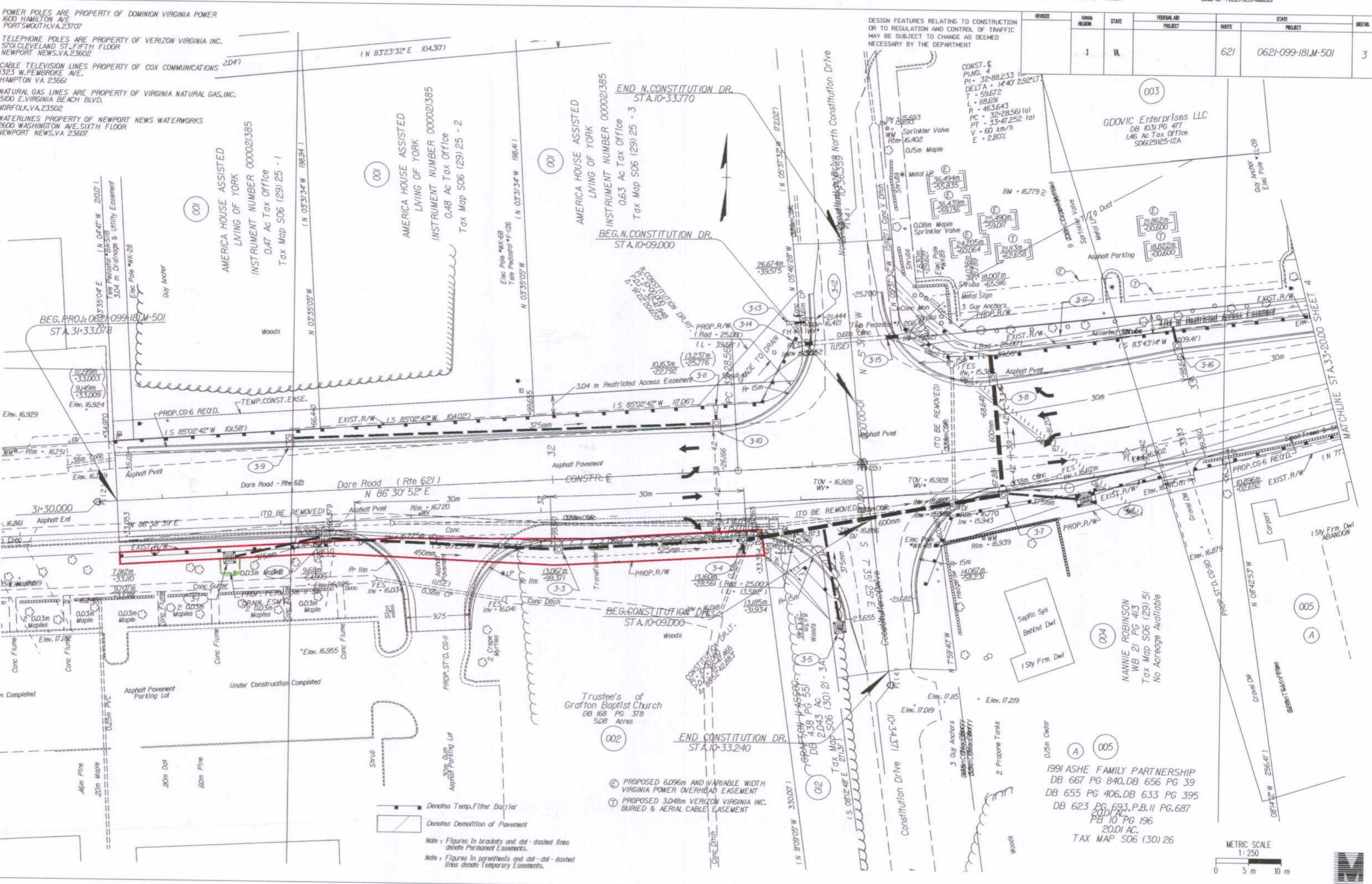

POWER POLES ARE PROPERTY OF DOMINION VIRGINIA POWER
 1600 HAMILTON AVE.
 PORTSMOUTH, VA 23707

TELEPHONE POLES ARE PROPERTY OF VERIZON VIRGINIA INC.
 5701 CLEVELAND ST., FIFTH FLOOR
 NEWPORT NEWS, VA 23602

CABLE TELEVISION LINES PROPERTY OF COX COMMUNICATIONS
 1323 W. PEMBROKE AVE.
 HAMPTON VA 23661

NATURAL GAS LINES ARE PROPERTY OF VIRGINIA NATURAL GAS, INC.
 5100 E. VIRGINIA BEACH BLVD.
 NORFOLK, VA 23502

WATER LINES PROPERTY OF NEWPORT NEWS WATERWORKS
 2600 WASHINGTON AVE. SIXTH FLOOR
 NEWPORT NEWS, VA 23607

DESIGN FEATURES RELATING TO CONSTRUCTION OR TO REGULATION AND CONTROL OF TRAFFIC MAY BE SUBJECT TO CHANGE AS DEEMED NECESSARY BY THE DEPARTMENT

REVISED	FHWA REGION	STATE	FEDERAL AID PROJECT	ROUTE	STATE PROJECT	SHEET
	3	VA		621	0621-099-1B1M-501	3

SURVEYED BY: W.L.S. BAILEY, JR. 757-925-9962
 SUPERVISED BY: H.L. BUNNITS, M.D. 757-925-5086
 DESIGNED BY: L.E. BATTEN, JR. 757-925-1556
 CAD OPERATOR: J. BATTEN, JR. 757-925-1556
 REVISION BY: L.

12/18/01 12:41:26

Denotes Temp. Filter Barrier
 Denotes Demolition of Pavement
 Note: Figures in brackets and dot-dashed lines denote Permanent Easements.
 Note: Figures in parenthesis and dot-dashed lines denote Temporary Easements.

(E) PROPOSED 6.096m AND VARIABLE WIDTH VIRGINIA POWER OVERHEAD EASEMENT
 (T) PROPOSED 3.048m VERIZON VIRGINIA INC. BURIED & AERIAL CABLE EASEMENT

1991 ASHE FAMILY PARTNERSHIP
 DB 667 PG 840, DB 656 PG 39
 DB 655 PG 406, DB 633 PG 395
 DB 623 PG 693, P.B. II PG. 687
 20.01 AC
 TAX MAP 506 (30) 26

METRIC SCALE
 1:250
 0 5 m 10 m



PLAN	PROJECT	REVISION	SHEET
A	0621-099-1B1		3