

Design File - c:\documents of ms.john\7935\793506.dgn Ref. File - c:\documents of ms.john\7935\793506.dgn Levels On - 173-63  
Ref. File - c:\documents of ms.john\7935\793506.dgn Levels On - 15052-63  
Ref. File - c:\documents of ms.john\7935\793506.dgn Levels On - 143348-606263  
Ref. File - s17935.dgn Levels On - 143  
Ref. File - s17935.dgn Levels On - 143  
Ref. File - c:\documents of ms.john\7935\793506.dgn Levels On - 15064-63  
Ref. File - c:\documents of ms.john\7935\793506.dgn Levels On - 143  
Ref. File - c:\documents of ms.john\7935\793506.dgn Levels On - 143  
Ref. File - c:\documents of ms.john\7935\793506.dgn Levels On - 143  
Ref. File - c:\documents of ms.john\7935\793506.dgn Levels On - 143

REVISION	DATE	BY	DESCRIPTION
09/18/01	10/17/01		

FEDERAL AID PROJECT	ROUTE	STATE PROJECT	SHEET NO.
	782	0782-099-188,C-501	5

state highway Plat Book No. 9 Page 60

HAMPTON ROADS DISTRICT DESIGN UNIT

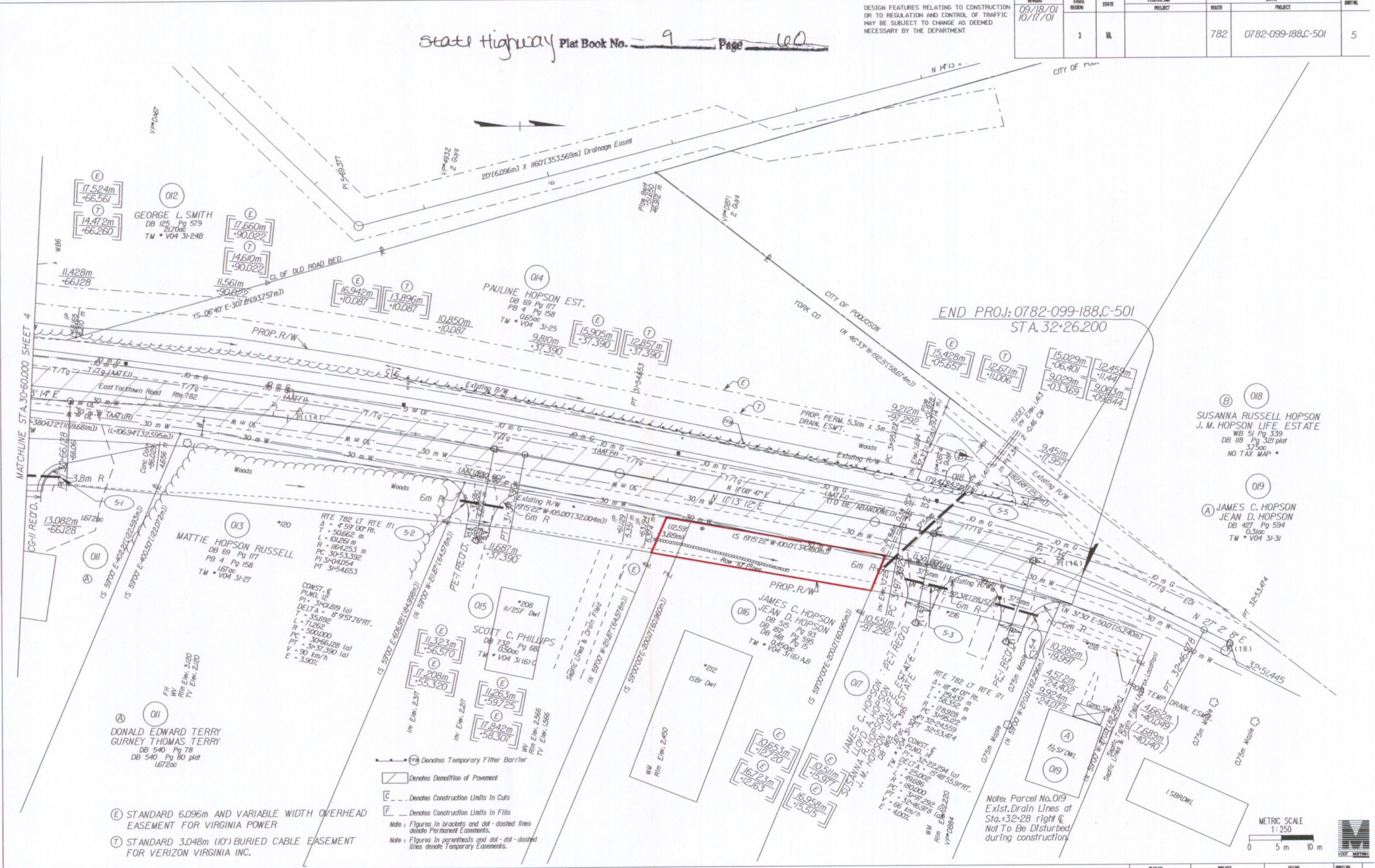

- (E) STANDARD 6.096m AND VARIABLE WIDTH OVERHEAD EASEMENT FOR VIRGINIA POWER
  - (T) STANDARD 3.048m (10') BURIED CABLE EASEMENT FOR VERIZON VIRGINIA INC.
- Denotes Temporary Filter Barrier  
 ▭ Denotes Demolition of Pavement  
 --- Denotes Construction Limits In Cuts  
 --- Denotes Construction Limits In Fills
- Note: Figures in brackets and dot-dashed lines denote Permanent Easements.  
 Note: Figures in parentheses and dot-dashed lines denote Temporary Easements.

Note: Parcel No. 019 Exist. Drain Lines at Sta. 32+28 right @ Not To Be Disturbed during construction

METRIC SCALE  
 1:250  
 0 5 m 10 m

SURVEYED BY: B. J. HARMON, 757-653-5572  
 SUPERVISED BY: K. M. BARNES, 757-653-2882  
 DESIGNED BY: K. BATTEN, 757-653-2556  
 CAD OPERATOR: B. J. HARMON, 757-653-5572  
 REVISED BY:

5/7/02 09:50:43