

NOW OR FORMERLY
 ROBERTS, PAUL W., ET UX
 101 MARLBANK DR
 TAX PARCEL: 019C 1 C 23
 GPIN: Q10d-3952-0981
 D.B. 465, PG. 31

LINE TABLE

LINE	BEARING	DISTANCE
L1	S 80°08'47" W	5.01'
L2	S 75°08'45" W	40.15'
L3	S 80°08'47" W	46.60'
L4	N 80°33'49" W	10.59'
L5	S 80°08'47" W	5.00'
L6	S 60°51'23" W	10.59'
L7	S 80°08'47" W	21.94'
L8	S 09°51'13" E	5.00'
L9	S 80°08'47" W	20.00'

**PERMANENT
 UTILITY EASEMENT
 HEREBY CONVEYED TO
 YORK COUNTY
 753 SQ. FT.**

**TEMPORARY
 CONSTRUCTION EASEMENT
 HEREBY CONVEYED TO
 YORK COUNTY
 693 SQ. FT.**

PROPERTY OF
 PARCELL, DAVID RAY, ET UX
 103 MARLBANK DR
 TAX PARCEL: 019C 1 C 24
 GPIN: Q10d-3981-0760
 D.B. 430, PG. 186

NOW OR FORMERLY
 ZALUMAS, STEVE & ROBERT C. GREGORIE
 105 MARLBANK DR
 TAX PARCEL: 019C 1 C 24
 GPIN: Q10d-4290-0751
 D.B. 281, PG. 84

LINE TABLE

LINE	BEARING	DISTANCE
L10	N 09°51'13" W	10.00'
L11	N 80°08'47" E	158.54'
L12	S 80°08'47" W	5.21'
L13	S 75°08'45" W	40.15'
L14	S 80°08'47" W	46.60'
L15	N 80°33'49" W	10.59'
L16	S 80°08'47" W	5.00'
L17	S 60°51'23" W	10.59'
L18	S 80°08'47" W	21.94'

**YORK COUNTY
 APPROVED FOR RECORDATION**
 BY: *J.B. Maguire*
 TITLE: *Right of Way Agreement*
 DATE: *3-25-04*

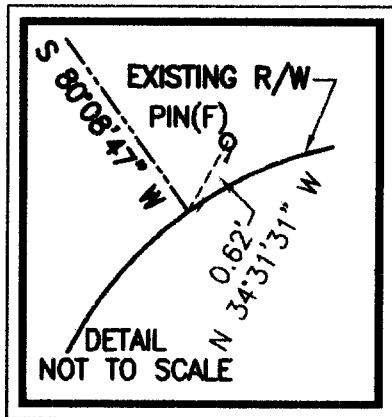

CURVE TABLE

CURVE	RADIUS	ARC LENGTH	CHORD LENGTH	CHORD BEARING
C1	100.00'	1.50'	1.50'	S 10°16'50" E
C2	100.00'	5.00'	5.00'	S 12°08'38" E

MARLBANK DRIVE
 (40' R/W)

ARTILLERY ROAD
 (40' R/W)

- NOTES:**
1. THIS PLAT IS INTENDED FOR A DESCRIPTION OF EASEMENT ONLY, AND DOES NOT CONSTITUTE A BOUNDARY SURVEY
 2. THIS SURVEY WAS PERFORMED WITHOUT THE BENEFIT OF A TITLE REPORT, AND MAY NOT REFLECT ALL EASEMENTS OR RESTRICTIONS THAT MAY AFFECT THE PROPERTY.

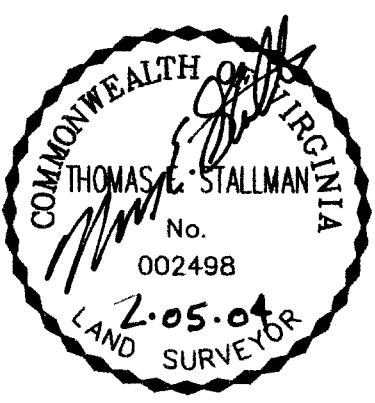

REFERENCES:
 D.B. 430, PG. 186
 P.B. 7, PG. 140
 P.B. 4, PG. 52

PLAT OF EASEMENT ACQUISITION
 FROM: DAVID RAY PARCELL, ET UX
 TO: COUNTY OF YORK, VIRGINIA
 PROJECT: MARLBANK FARM
 SANITARY SEWER IMPROVEMENTS

DATE: 2/5/04 | SCALE: 1" = 50'

MERIDIAN IS BASED ON:
 VIRGINIA STATE PLANE
 COORDINATE SYSTEM,
 SOUTH ZONE, NAD 83
 U.S. SURVEY FEET

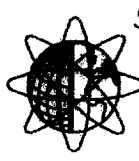

PRECISION MEASUREMENTS, INC.
 SURVEYORS • GPS • GIS • MAPPERS
 813 DILIGENCE DRIVE, SUITE 119
 NEWPORT NEWS, VIRGINIA 23606
 (757) 595-7570