

CURVE	RADIUS	ARC LENGTH	CHORD LENGTH	CHORD BEARING
C1	100.00'	20.03'	20.00'	S 75°28'53" W
C2	100.00'	8.36'	8.35'	N 67°20'54" E

YORK COUNTY
APPROVED FOR RECORDATION
 BY: *J.B. Ingalls*
 TITLE: *Right-of-Way Agent*
 DATE: *May 26, 2004*

EXISTING R/W
 PIN(F)

MARLBANK DRIVE
 (40' R/W)
 ASPHALT SURFACE

NOW OR FORMERLY
 BAILEY, MARY ELIZABETH H.
 100 MARLBANK DR
 TAX PARCEL: 019C 1 C 22
 GPIN: Q10d-4046-1166
 D.B. 619, PG. 326

PROPERTY OF
 BAILEY, MARY ELIZABETH H.
 102 MARLBANK DR
 TAX PARCEL: 019C 1 C 21
 GPIN: Q10d-4265-1195
 D.B. 619, PG. 326

NOW OR FORMERLY
 COLE, ELEANOR A.
 204 ARTILLERY RD
 TAX PARCEL: 019C 1 C 19
 GPIN: Q10d-4495-1070
 D.B. 76, PG. 324

PERMANENT EASEMENT TO YORK COUNTY
 3,773 SQ. FT.

LINE TABLE

LINE	BEARING	DISTANCE
L1	N 14°15'36" W	123.27'
L2	N 46°20'33" W	16.79'
L3	N 81°52'39" W	30.27'
L4	N 28°03'08" W	23.89'
L5	S 81°52'39" E	49.75'
L6	S 46°20'33" E	28.95'
L7	S 14°15'36" E	128.93'



ARTILLERY ROAD
 (40' R/W)

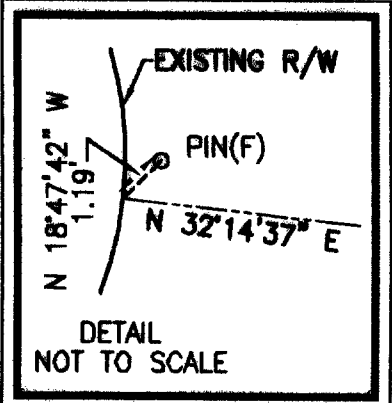

NOTES:
 1. THIS PLAT IS INTENDED FOR A DESCRIPTION OF EASEMENT ONLY, AND DOES NOT CONSTITUTE A BOUNDARY SURVEY
 2. THIS SURVEY WAS PERFORMED WITHOUT THE BENEFIT OF A TITLE REPORT, AND MAY NOT REFLECT ALL EASEMENTS OR RESTRICTIONS THAT MAY AFFECT THE PROPERTY.

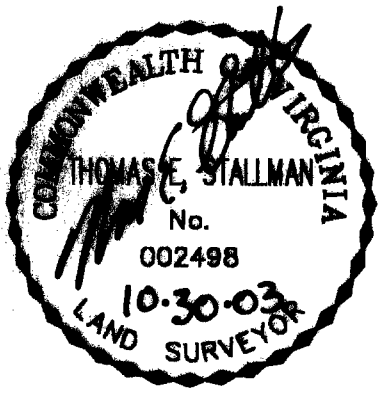

REFERENCES:
 D.B. 619, PG. 326
 P.B. 7, PG. 140
 P.B. 4, PG. 52

MERIDIAN IS BASED ON:
 VIRGINIA STATE PLANE COORDINATE SYSTEM, SOUTH ZONE, NAD 83
 U.S. SURVEY FEET

PLAT OF EASEMENT ACQUISITION
 FROM: MARY ELIZABETH H. BAILEY
 TO: COUNTY OF YORK, VIRGINIA
 PROJECT: MARLBANK FARM
 SANITARY SEWER IMPROVEMENTS

DATE: 10/30/03 SCALE: 1" = 50'

PRECISION MEASUREMENTS, INC.
 SURVEYORS • GPS • GIS • MAPPERS
 813 DILIGENCE DRIVE, SUITE 119
 NEWPORT NEWS, VIRGINIA 23606
 (757) 595-7570