

SURVEYED BY - ROBERT D. HARMON  
 SUPERVISED BY - SONYA HALLUMS-PORTON (757) 925-2960  
 DESIGNED BY - M. CHAM, GEORGE (757) 925-3624  
 HAMPTON ROADS DISTRICT DESIGN UNIT

DESIGN FEATURES RELATING TO CONSTRUCTION OR TO REGULATION AND CONTROL OF TRAFFIC MAY BE SUBJECT TO CHANGE AS DEEMED NECESSARY BY THE DEPARTMENT

FEED	FYNA DESIGN	STATE	FEDERAL AID PROJECT	ROUTE	STATE PROJECT	SHEET NO.
10-14-04		VA		1050	1050-099-180, C-501 R/W-201	6

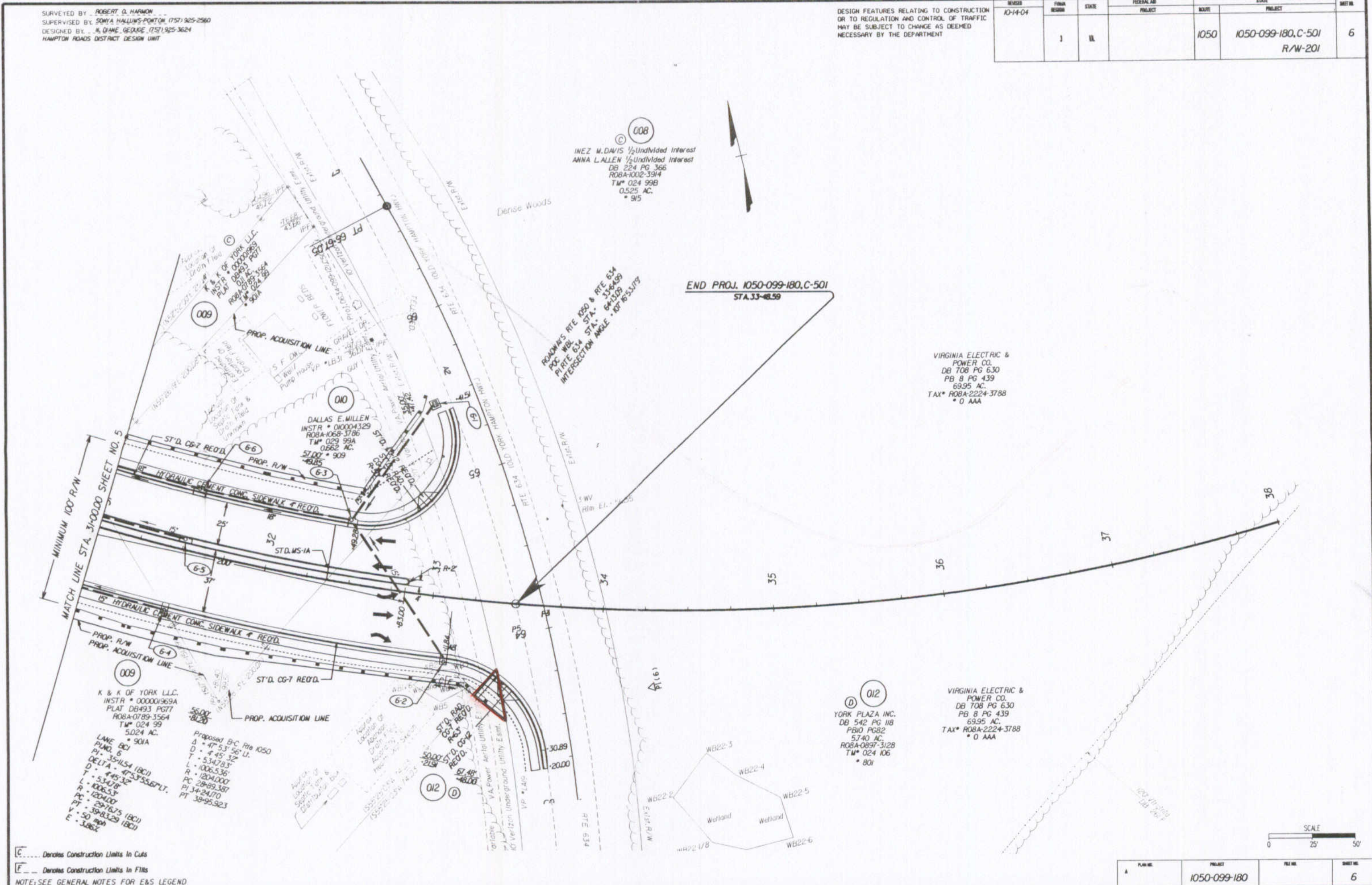

008  
 INEZ M. DAVIS 1/2 Undivided Interest  
 ANNA L. ALLEN 1/2 Undivided Interest  
 DB 224 PG 366  
 ROBA-1002-3914  
 TM# 024 99B  
 0.525 AC.  
 \* 915

RODWIN'S RTE 1050 & RTE 834  
 POC WBL 834 STA. 53+64.89  
 PI RTE 834 STA. 64+109  
 INTERSECTION ANGLE = 107° 15' 53.07"

DALLAS E. MILLEN  
 INSTR# 010004329  
 ROBA-1068-3786  
 TM# 029 99A  
 0.662 AC.  
 ST. 007 - 909  
 \* 6385

VIRGINIA ELECTRIC & POWER CO.  
 DB 708 PG 630  
 PB 8 PG 439  
 69.95 AC.  
 TAX# ROBA-2224-3788  
 \* 0 AAA

012  
 YORK PLAZA INC.  
 DB 542 PG 118  
 PB10 PG82  
 57.40 AC.  
 ROBA-0897-3128  
 TM# 024 106  
 \* 801

009  
 K & K OF YORK L.L.C.  
 INSTR# 00001969A  
 PLAT DB493 PG77  
 ROBA-0789-3564  
 TM# 024 99  
 5.024 AC.  
 \* 901A  
 LANE BCI  
 P.M.O. 6  
 PI - 35+15.4 (BCI)  
 DELTA - 47° 53' 56" PL.  
 D - 4' 45' 32"  
 T - 5347.83'  
 L - 0065.36'  
 R - 1204.000'  
 PC 29+99.387  
 PI 34+84.170  
 PT 38+95.923

Proposed E.C. Rte 1050  
 Δ = 47° 53' 56" PL.  
 D = 4' 45' 32"  
 T = 5347.83'  
 L = 0065.36'  
 R = 1204.000'  
 PC 29+99.387  
 PI 34+84.170  
 PT 38+95.923

C..... Denotes Construction Limits In Cuts  
 F..... Denotes Construction Limits In Fills  
 NOTE: SEE GENERAL NOTES FOR E&S LEGEND

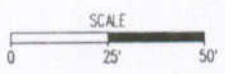

PLAN NO.	PROJECT	SHEET NO.	SHEET NO.
	1050-099-180		6