

SURVEYED BY: BOB HARMON (757) 253-5137
 SUPERVISED BY: P.H. BYRUM (757) 925-2557
 DESIGNED BY: M.D. WINSTEAD (757) 925-2556
 HAMPTON ROADS DISTRICT DESIGN UNIT

Inst# 070000758 State Highway

Plat Book No. 9 Page 306

DESIGN FEATURES RELATING TO CONSTRUCTION OR TO REGULATION AND CONTROL OF TRAFFIC MAY BE SUBJECT TO CHANGE AS DEEMED NECESSARY BY THE DEPARTMENT

REVISED 12/09/05 02/06/06	STATE VA.	FEDERAL AID PROJECT	ROUTE 17	STATE PROJECT 6017-099-129, RW-201, C-501	SHEET NO. 16
---------------------------------	--------------	------------------------	-------------	---	-----------------

REFERENCES
(PROFILES, DETAIL & DRAINAGE DESCRIPTION SHEETS, ETC.)

MAINLINE PROFILES	16A
CONNECTION PROFILES	16B
ENTRANCE PROFILES	24F
DRAINAGE DESC.	2H11 - 2H71
CROSS-OVER DETAIL	2E

THESE PLANS ARE UNFINISHED AND ARE NOT TO BE USED FOR ANY TYPE OF CONSTRUCTION.

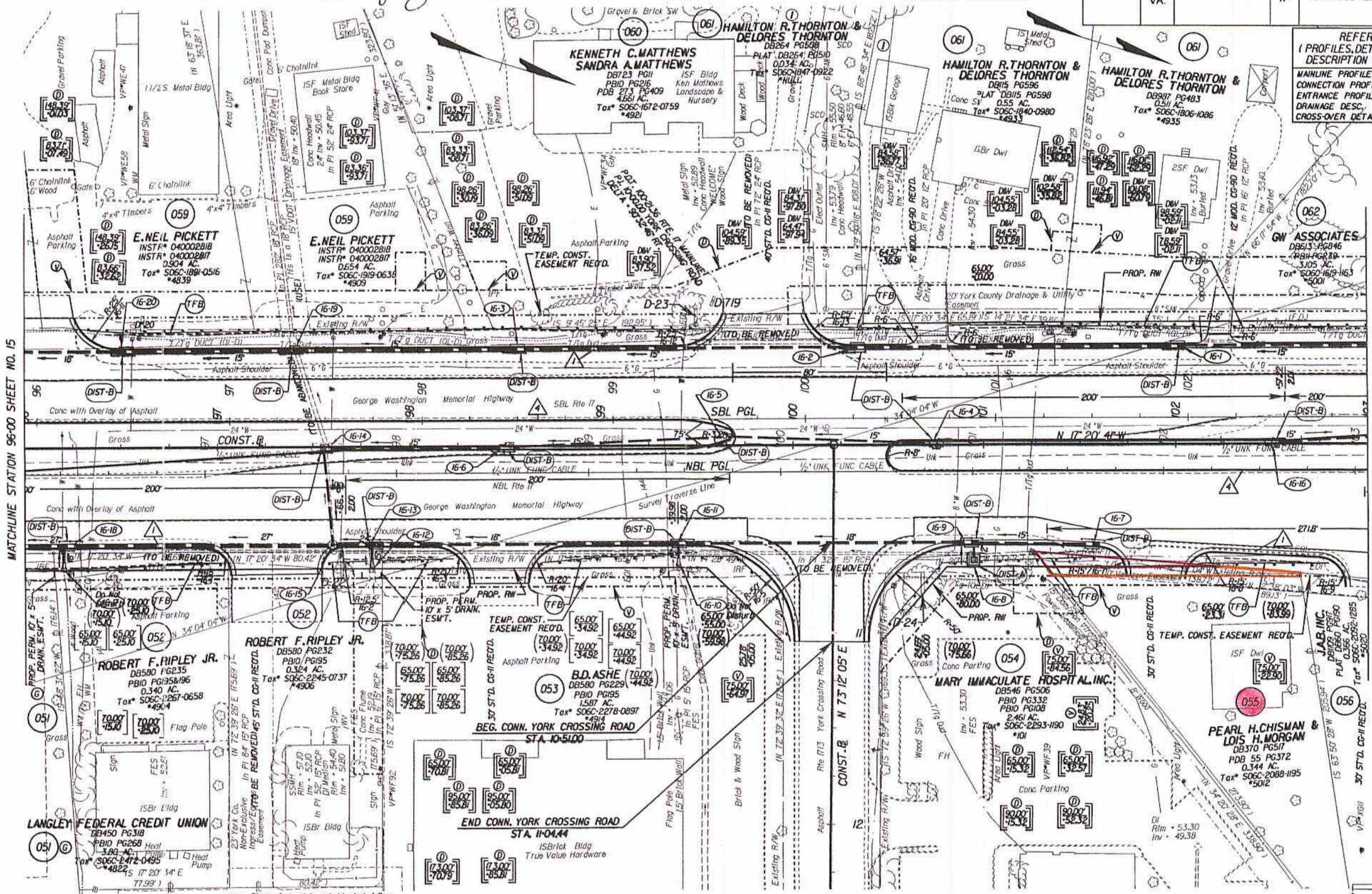

MATCHLINE STATION 96+00 SHEET NO. 15

MATCHLINE STATION 103+00 SHEET NO. 17

NOTE: PGL DENOTES PROFILE GRADE LINE
 NOTE: SEE GENERAL NOTES FOR E&S LEGEND
 ○ DENOTES DRAINAGE STRUCTURE NUMBER

Note: Figures in brackets and dot-dashed lines denote Permanent Easements.
 V Denotes variable easement required for Verizon Virginia
 D Denotes variable easement required for Dominion Virginia Power

Note: Figures in parenthesis and dot-dashed lines denote Temporary Easements.

C Denotes Construction Limits In Cuts
 F Denotes Construction Limits In Fills
 1 ST'D. CG-7 REO'D.
 4 ST'D. MS-2 REO'D.



PLAN NO.	PROJECT	FILE NO.	SHEET NO.
	6017-099-129		16