

SURVEYED BY: J.B. HARMON (757) 253-5377
 SUPERVISED BY: P.H. BYRUM (757) 925-2557
 DESIGNED BY: J.A. WINSTEAD (757) 925-2556
 HAMPTON ROADS DISTRICT DESIGN UNIT

REVISION	DATE	FEDERAL AID PROJECT	ROUTE	STATE PROJECT	SHEET NO.
02/06/06 03/23/06		VA.	17	6017-099-129, RW-201 C-501	18

THESE PLANS ARE UNFINISHED
 AND ARE NOT TO BE USED FOR
 ANY TYPE OF CONSTRUCTION.

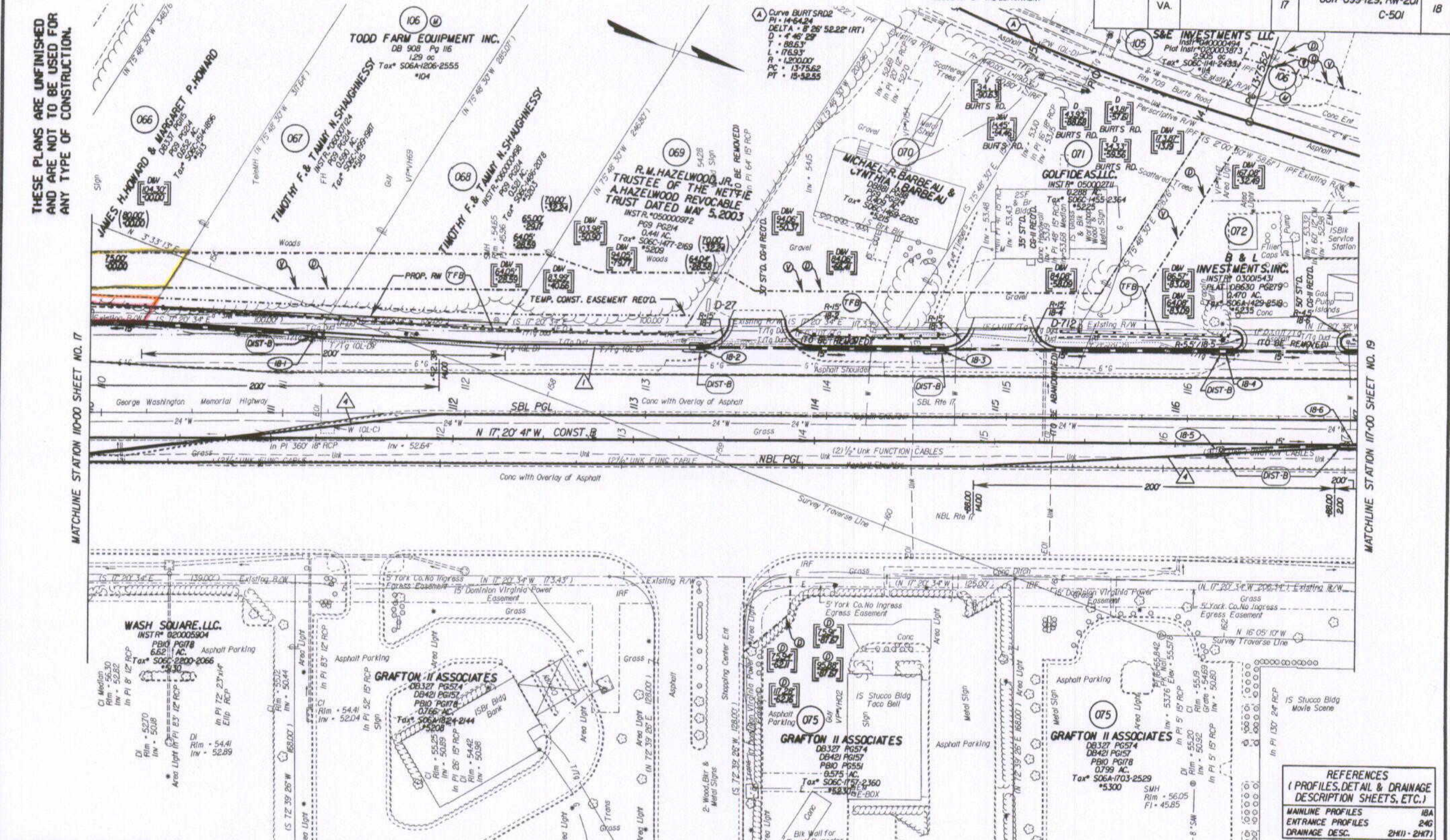

NOTE: PGL DENOTES PROFILE GRADE LINE
 NOTE: SEE GENERAL NOTES FOR E&S LEGEND
 ○ DENOTES DRAINAGE STRUCTURE NUMBER

Note: Figures in brackets and dot-dashed lines denote Permanent Easements.
 (V) Denotes variable easement required for Verizon Virginia
 (D) Denotes variable easement required for Dominion Virginia Power
 Note: Figures in parentheses and dot-dot-dashed lines denote Temporary Easements.

(C) Denotes Construction Units In Cuts
 (F) Denotes Construction Units In Fills
 (1) ST'D. CG-7 REQ'D.
 (4) ST'D. WS-2 REQ'D.

REFERENCES (PROFILES, DETAIL & DRAINAGE DESCRIPTION SHEETS, ETC.)	
MAINLINE PROFILES	18A
ENTRANCE PROFILES	24G
DRAINAGE DESC.	2H(1) - 2H(7)

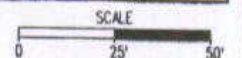

PLAN NO.	PROJECT	FILE NO.	SHEET NO.
	6017-099-129		18

State Highway Plat Book No. 10 Page 19 doc. # 070004610

MATCHLINE STATION 110+00 SHEET NO. 17

MATCHLINE STATION 117+00 SHEET NO. 19

9/27/2006 15:44:04