

DESIGN FEATURES RELATING TO CONSTRUCTION OR TO REGULATION AND CONTROL OF TRAFFIC MAY BE SUBJECT TO CHANGE AS DEEMED NECESSARY BY THE DEPARTMENT

REVISED	FYNA REGION	STATE	FEDERAL AID PROJECT	ROUTE	STATE PROJECT	SHEET NO.
	3	VA.		199	0199-099-101, PE-101, RW-202, C-502	10E(1)

State Highway  
 Plat Book No. 10 Page 62  
 Instr# LR070010893

Conveyed to The Marquis at Williamsburg, LLC by deed dated May 7, 2007

Area \*A of Existing R/W to be Vacated 110,450,736 SF = 2.5356 AC.  
 Area \*B of Existing R/W to be Vacated 41,965,704 SF = 0.9634 AC.  
 Total Area of Existing R/W to be Vacated 152,416,440 SF = 3.4990 AC.

This Plan Sheet is for informational purposes only

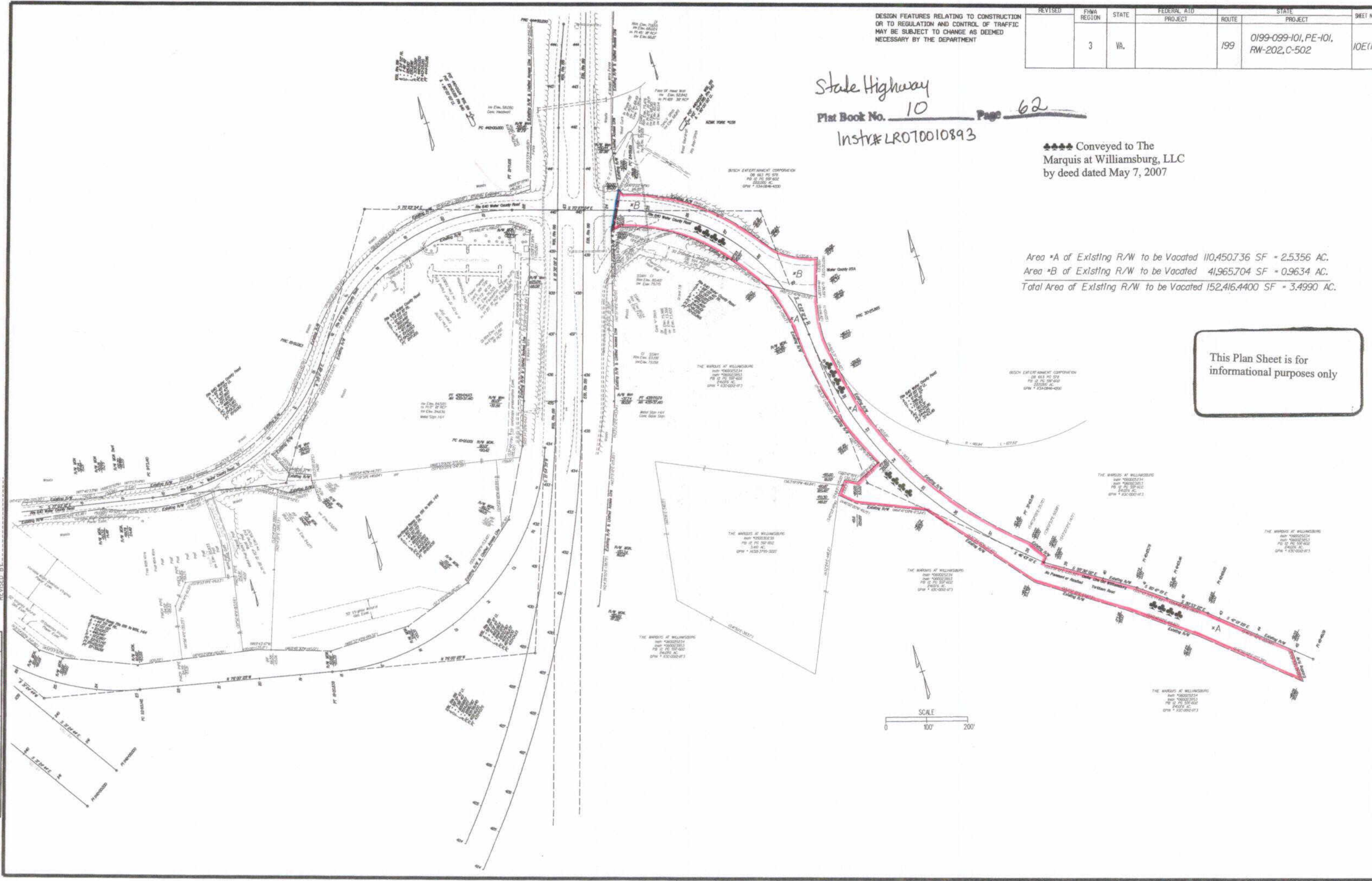

SUPERVISED BY: [blank]  
 DESIGNED BY: [blank]  
 CAD OPERATOR: [blank]  
 REVISED BY: [blank]

PLAN	NOTE BOOK
1	1
2	2
3	3
4	4
5	5
6	6
7	7
8	8
9	9
10	10