

LINE TABLE

LINE	BEARING	DISTANCE
L1	N 31°30'48" E	20.00'
L2	S 58°29'12" E	10.00'
L3	S 31°30'48" W	20.00'
L4	N 58°29'12" W	10.00'

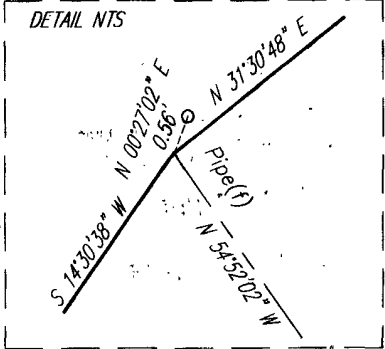

**UTILITY EASEMENT HEREBY CONVEYED TO YORK COUNTY**  
200 SQ.FT. OR 0.005 ACRE



NOTES:

1. THIS PLAT IS INTENDED FOR A DESCRIPTION OF UTILITY EASEMENT ONLY, AND DOES NOT CONSTITUTE A BOUNDARY SURVEY.
2. THIS SURVEY WAS PERFORMED WITHOUT THE BENEFIT OF A TITLE REPORT, AND MAY NOT REFLECT ALL EASEMENTS OR RESTRICTIONS THAT MAY AFFECT THE PROPERTY.

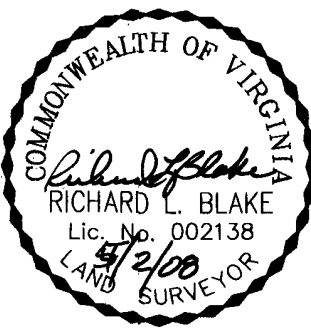

REFERENCES:  
D.B. 430, PG. 218  
P.B. 7, PG. 153

PLAT OF UTILITY EASEMENT ACQUISITION  
FROM: PATRICK V. FORD, ET UX  
TO: COUNTY OF YORK, VIRGINIA  
PROJECT: YORK POINT SEWER PROJECT

DATE: 5/2/08

SCALE: 1" = 40'

MERIDIAN IS BASED ON:  
VIRGINIA STATE PLANE COORDINATE SYSTEM, SOUTH ZONE, NAD 83 U.S. SURVEY FEET

PRECISION MEASUREMENTS, INC.  
SURVEYORS • GPS • 3-D SCANNING • MAPPERS  
813 DILIGENCE DRIVE, SUITE 119  
NEWPORT NEWS, VIRGINIA 23606  
(757) 595-7570