

N/F
 MICHAEL G. PARKER & S. L. HURLBURT
 INST# 070014694
 P.B. 8, PG. 190
 D.B. 923, PG. 516(PLAT)
 GPIN: V08A-1797-2550
 TAX MAP# 026-00-00-034

N: 3,597,410.567
 E: 12,091,922.849

N/F
 CHARLES MASON THOMAS, JR., ET AL
 INST# 050016573
 P.B. 8, PG. 190
 GPIN: V08C-1559-2417
 TAX MAP# 026H-01-00-010D

N: 3,597,361.398
 E: 12,091,819.628

N/F
 HEIRS OF J.H. PRESSON
 P.B. 8, PG. 190
 GPIN: V08C-1645-2270
 TAX MAP# 026H-1-E

YORK COUNTY
 APPROVED FOR RECORDATION
 BY: *J.B. [Signature]*
 RIGHT-OF-WAY AGENT
 DATE: 8-13-08

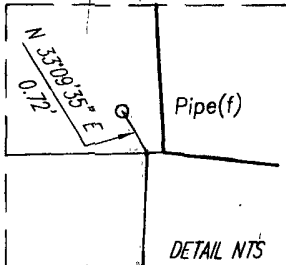

 UTILITY EASEMENT HEREBY CONVEYED TO YORK COUNTY 5,400 SQ.FT. OR 0.124 ACRE

- NOTES:
1. THIS PLAT IS INTENDED FOR A DESCRIPTION OF UTILITY EASEMENT ONLY, AND DOES NOT CONSTITUTE A BOUNDARY SURVEY.
 2. THIS SURVEY WAS PERFORMED WITHOUT THE BENEFIT OF A TITLE REPORT, AND MAY NOT REFLECT ALL EASEMENTS OR RESTRICTIONS THAT MAY AFFECT THE PROPERTY.

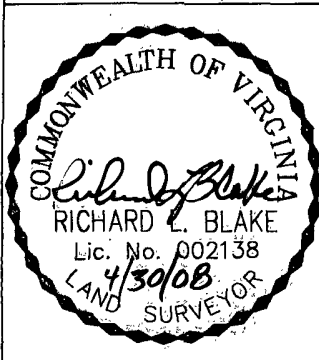

REFERENCES:
 INST# 050016573
 P.B. 8, PG. 190

PLAT OF UTILITY EASEMENT ACQUISITION
 FROM: CHARLES MASON THOMAS, JR., ET AL
 TO: COUNTY OF YORK, VIRGINIA
 PROJECT: YORK POINT SEWER PROJECT

DATE: 4/30/08

SCALE: 1" = 40'

MERIDIAN IS BASED ON:
 VIRGINIA STATE PLANE COORDINATE SYSTEM, SOUTH ZONE, NAD 83 U.S. SURVEY FEET

PRECISION MEASUREMENTS, INC.
 SURVEYORS • GPS • 3-D SCANNING • MAPPERS
 813 DILIGENCE DRIVE, SUITE 119
 NEWPORT NEWS, VIRGINIA 23606
 (757) 595-7570