

UTILITY OWNERS:
 SEE SHEET 3 FOR DETAILS.

Instr # 08-26129
 State Hwy Plat Book # 10 P. 268
 MATCHLINE SHEET NO. 10B

DESIGN FEATURES RELATING TO CONSTRUCTION OR TO REGULATION AND CONTROL OF TRAFFIC MAY BE SUBJECT TO CHANGE AS DEEMED NECESSARY BY THE DEPARTMENT

REVISED	STATE	FEDERAL AID PROJECT	ROUTE	STATE PROJECT	SHEET NO.
12/08/05 02/06/06 03/23/06 05/29/07 02/11/08 05/19/08	VA.		17	6017-099-129, RW-201, C-501	10

THESE PLANS ARE UNFINISHED AND ARE NOT TO BE USED FOR ANY TYPE OF CONSTRUCTION.

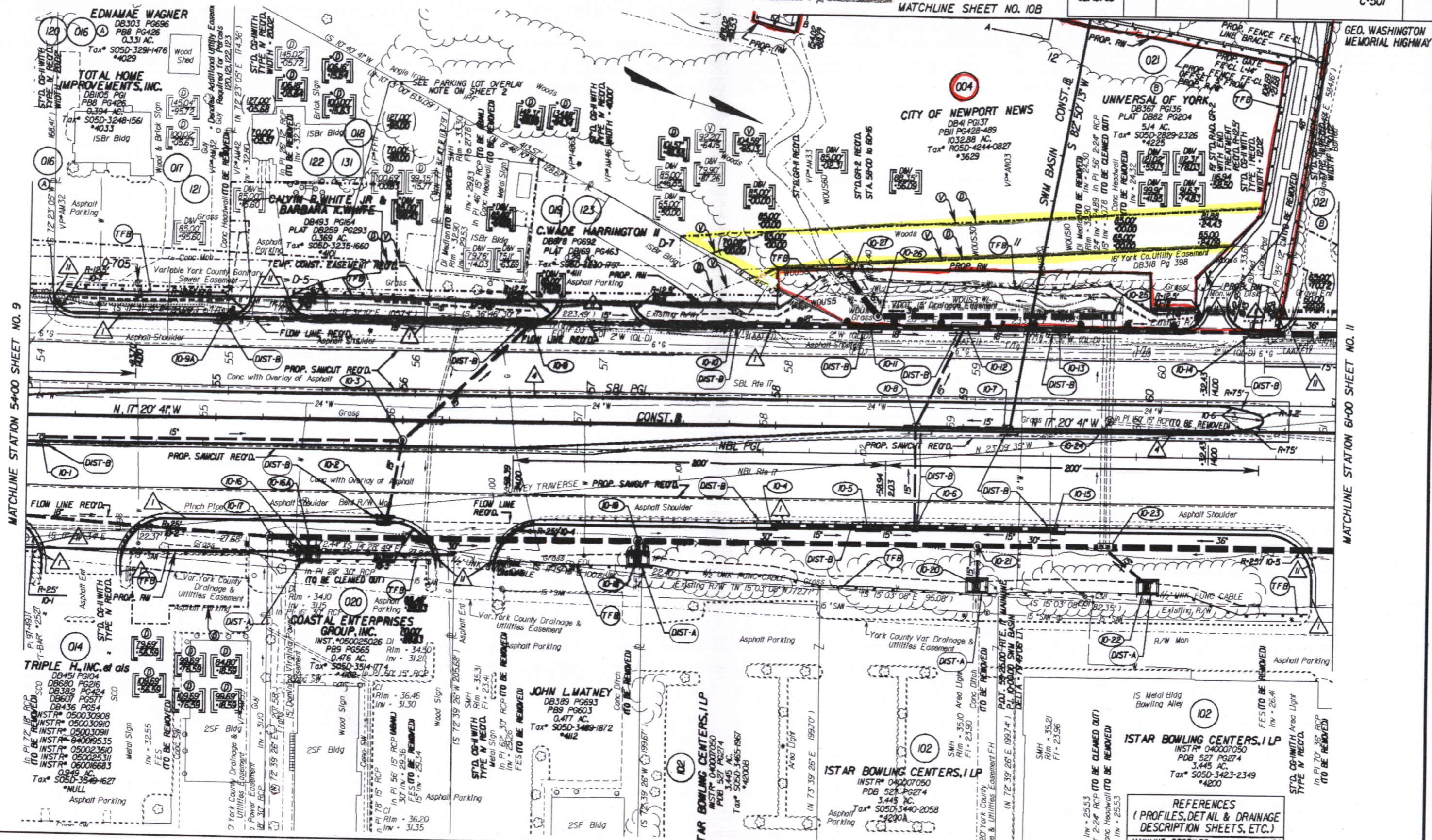

LEGEND

- Denotes Drainage Structure Number
- Ⓢ Denotes variable easement required for Verizon Virginia
- Ⓣ Denotes Construction Limits in Cuts
- ⓕ Denotes Construction Limits in Fills
- PGL Denotes Profile Grade Line
- Ⓥ Denotes variable easement required for Dominion Virginia Power
- ⓄⓄ Figures without parenthesis or brackets and solid lines denote Proposed Right of Way.
- () Figures in parenthesis and dot-dot-dashed lines denote Temporary Easements.
- { } Figures in double brackets and dot-dashed lines denote Permanent Utility Easements.
- ▲ RAD. CG-7 REQ'D.
- △ ST'D. MS-2 REQ'D.
- Ⓜ RAD. CG-7 REQ'D.

NOTES
 See General Notes for E&S Legend

REFERENCES (PROFILES, DETAIL & DRAINAGE DESCRIPTION SHEETS, ETC.)

MAINLINE PROFILES	10A
ENTRANCE PROFILES	24C
DRAINAGE DESC.	2H(1) - 2H(7)
CROSS-OVER DETAIL	2F(5)



PLAN NO.	PROJECT	FILE NO.	SHEET NO.
	6017-099-129		10

LR080026129

MATCHLINE STATION 5+400 SHEET NO. 9

MATCHLINE STATION 6+000 SHEET NO. 11