

Y:\1908\26985 CONSERVATION PLAT.dwg\Sheet\Plat\26985V-XPESMT.dwg | Plotted on 12/12/2008 3:07 PM | by Chris Marston

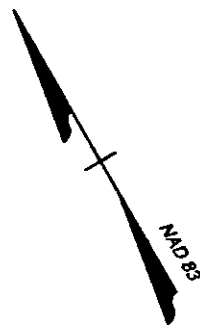

LEGEND

- IRF IRON ROD FOUND
- IPF IRON PIPE FOUND
- S.T.L. SURVEY TIE LINE
- W/WIRE WITH WIRE FENCE
- IRS IRON ROD SET

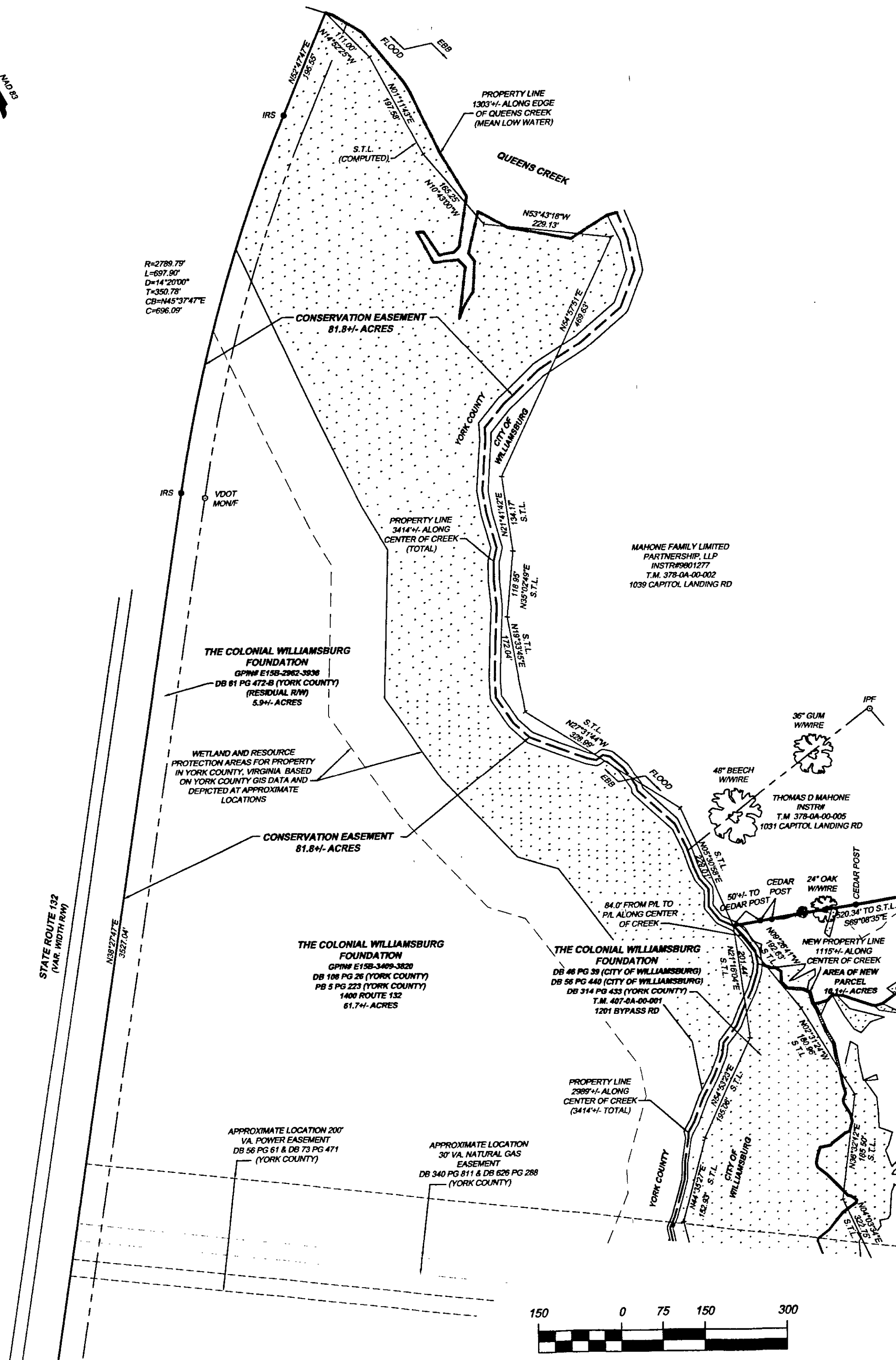

GENERAL NOTES:

1. THIS SURVEY IS BASED ON AN ACTUAL FIELD SURVEY CONDUCTED BY THIS FIRM DURING THE MONTHS OF OCTOBER AND NOVEMBER, 2008.
2. THIS SURVEY WAS CONDUCTED WITHOUT THE BENEFIT OF A CURRENT TITLE COMMITMENT, AND AS SUCH, MAY NOT REFLECT ALL MATTERS OF RECORD AFFECTING THE SUBJECT PROPERTY.
3. JURISDICTIONAL WETLANDS, RESOURCE PROTECTION AREAS, AND OTHER DESIGNATED ENVIRONMENTAL RESOURCES INDICATED HEREON ARE PROVIDED BY WILLIAMSBURG ENVIRONMENTAL GROUP, INC. AND YORK COUNTY GIS.
4. STREAMS WHICH DEFINE PROPERTY BOUNDARIES WERE ALL BASED ON FIELD-RUN SURVEYS. OTHER STREAM LOCATIONS, AND SOME OTHER PHYSICAL FEATURES (ADJACENT PAVING, ETC.) INDICATED HEREON, ARE BASED ON A COMBINATION OF FIELD-RUN LOCATIONS, AND OTHER SOURCES (I.E. PUBLISHED GIS INVENTORIES).

YORK COUNTY
APPROVED AS TO CONFORMANCE WITH
EXISTING GIS DATA

BY: Carl A. Bryant *CAB*
 TITLE: Computer Support Services
 DATE: 12-16-08

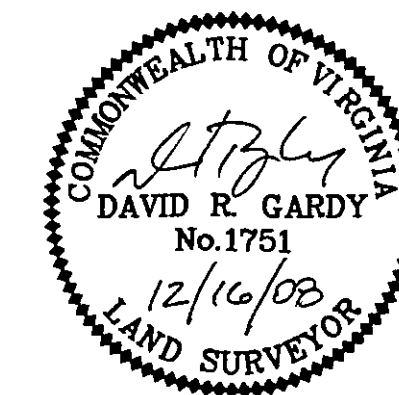

**PLAT SHOWING CONSERVATION EASEMENT
ACROSS THE PROPERTY OF THE COLONIAL
WILLIAMSBURG FOUNDATION BEING A
PORTION OF 1201 BYPASS ROAD, CITY OF
WILLIAMSBURG, VIRGINIA AND 1400 ROUTE
132 AND RESIDUAL RIGHT-OF-WAY,
COUNTY OF YORK, VIRGINIA**

CITY OF WILLIAMSBURG	YORK COUNTY, VA.
DATE: NOV. 17, 2008	SCALE: 1" = 150'
SHEET 2 OF 2	J.N.: 26985
DRAWN BY: C. MARSTON	CHECK BY: D. GARDY

MATCH LINE SHEET 2 SHEET 1

THIS DRAWING PREPARED AT THE
CORPORATE OFFICE
 1.001 Boulders Parkway, Suite 300 | Richmond, VA 23225
 TEL: 804.200.6500 FAX: 804.560.1016 www.timmons.com

YOUR VISION ACHIEVED THROUGH OURS.

Site Development Residential Infrastructure Technology

TIMMONS GROUP

080027381

10-4