

LINE TABLE

LINE	BEARING	DISTANCE
L1	S 45°16'59" W	10.24'
L2	N 32°22'56" W	26.19'
L3	N 57°37'04" E	10.00'
L4	S 32°22'56" E	24.00'
L5	S 45°16'59" W	10.24'
L6	N 32°22'56" W	38.37'
L7	N 57°37'04" E	20.00'
L8	S 32°22'56" E	10.00'
L9	N 45°16'59" E	30.71'
L10	S 29°51'01" E	1.57'
L11	S 27°26'52" E	0.56'

PROPERTY OF
MARK W. ROBINSON
DEBORAH B. ROBINSON
 D.B. 496, PG. 99
 P.B. 10, PG. 396
 TAX MAP: 24-00-00-269
 GPIN: R09d-4646-1349
 1020 HORNSBYVILLE ROAD

N 43°09'00" W 329.61'

VARIABLE WIDTH TEMPORARY
 CONSTRUCTION EASEMENT
 473 SQ. FT. OR 0.011 ACRES

10' X 24' PERMANENT
 UTILITY EASEMENT
 251 SQ. FT. OR 0.006 ACRES

MON(F)BASE

S 45°16'59" W 108.60'

ROD(F)BENT

VARIABLE WIDTH C&D RAILROAD R/W
 (D.B. 90, PG. 341)

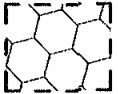
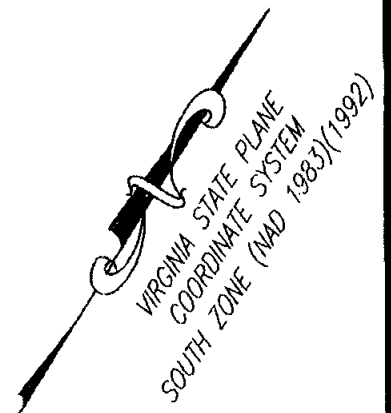
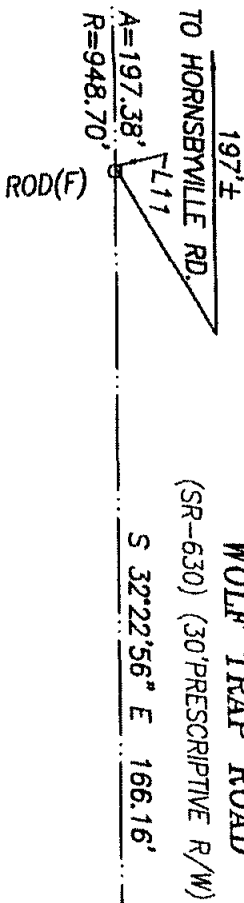

TEMPORARY CONSTRUCTION EASEMENT
 473 SQ. FT. OR 0.011 ACRES



10' X 24' PERMANENT UTILITY EASEMENT
 251 SQ. FT. OR 0.006 ACRES



GRAPHIC SCALE

NOTES:

1. THIS PLAT IS INTENDED FOR A DESCRIPTION OF EASEMENT ONLY, AND DOES NOT CONSTITUTE A BOUNDARY SURVEY.
2. THIS SURVEY WAS PERFORMED WITHOUT THE BENEFIT OF A TITLE REPORT, AND MAY NOT REFLECT ALL EASEMENTS OR RESTRICTIONS THAT AFFECT THE PROPERTY.

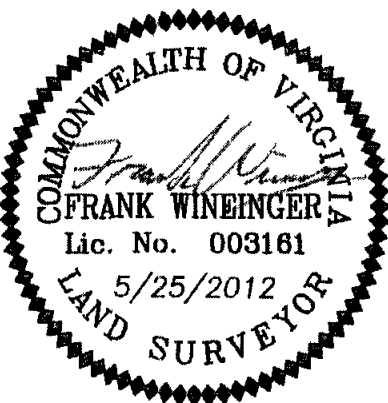

REFERENCES:

D.B. 496, PG. 99
 P.B. 10, PG. 396

MERIDIAN SOURCE
 IS BASED ON:
 VIRGINIA STATE PLANE
 COORDINATE SYSTEM,
 SOUTH ZONE
 NAD 1983(1992)

PLAT SHOWING PERMANENT UTILITY
 & TEMPORARY CONSTRUCTION EASEMENT
 TO BE ACQUIRED BY
COUNTY OF YORK
 FROM
MARK W. ROBINSON
DEBORAH B. ROBINSON
 YORK COUNTY, VIRGINIA

DATE: 05/25/2012 SCALE: 1" = 30'

PRECISION MEASUREMENTS, INC.
 SURVEYORS • GPS • 3-D SCANNING • GIS • MAPPERS
 VIRGINIA BEACH-RICHMOND-NEWPORT NEWS-CHANTILLY, VIRGINIA
 813 DILIGENCE DRIVE, SUITE 121-B
 NEWPORT NEWS, VIRGINIA 23606
 TEL: (757) 595-7570