

THIS GALLOP WAY RIGHT-OF-WAY IS PLATTED WITH THE INTENT OF BEING EXTENDED AND CONTINUED IN ORDER TO PROVIDE INGRESS AND EGRESS TO AND FROM ADJOINING PROPERTIES.

SEE SHEET 3

MATCHLINE SEE SHEET 6

MATCHLINE SEE SHEET 7



SEE SHEET 8 FOR EASEMENT DETAILS

SUBDIVISION PLAT			
ROSE HILL			
PHASE 1			
AN OPEN SPACE DEVELOPMENT			
TAX PARCELS: 17-00-00-149 & 17-00-00-150			
NELSON DISTRICT			
YORK COUNTY, VIRGINIA			
DRAWN:	DHW	DATE:	7/1/24
COMP:	BJL	SCALE:	1"=50'
CHECKED:	BJL	REVISION:	

PARRISH LAYNE DESIGN GROUP
 Engineers • Surveyors • Planners
 P.O. Box 9164, Chesapeake, VA 23321
 Phone: 757.686.3345 Fax: 757.686.3348

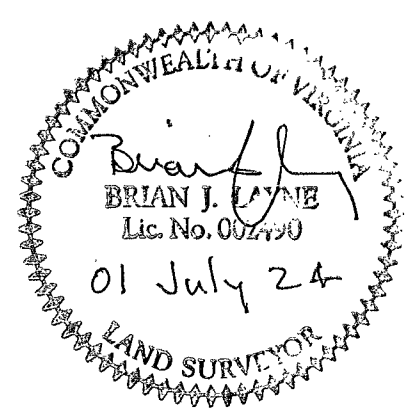

- T BAR FOUND
- DISK FOUND
- CONC. MON FOUND
- PIPE FOUND
- PIN FOUND
- T BAR FOUND
- DISK FOUND
- CONCRETE MONUMENT FOUND
- PIPE FOUND
- IRON PIN FOUND
- #5 IRON REBAR SET
- #5 IRON REBAR SET IN CONCRETE

CURVE DATA					
CURVE #	RADIUS	LENGTH	DELTA	TANGENT	CHORD
C47	25.00'	38.27'	87°42'34"	24.02'	N43°01'42"E 34.64'
C48	25.00'	39.27'	90°00'00"	25.00'	S45°49'35"E 35.36'
C49	352.00'	177.00'	28°48'41"	90.42'	S76°25'15"E 175.15'
C50	300.00'	150.86'	28°48'41"	77.06'	N76°25'15"W 149.27'
C51	25.00'	39.27'	90°00'00"	25.00'	N17°00'54"W 35.36'
C72	25.00'	39.27'	90°00'00"	25.00'	N45°49'35"W 35.36'
C73	25.00'	39.27'	90°00'00"	25.00'	S44°10'25"W 35.36'
C74	1000.00'	53.65'	3'04'25"	26.83'	N89°17'23"W 53.64'

LEGEND

- IRON PIN FOUND (UNLESS OTHERWISE NOTED)
- #5 IRON REBAR SET (UNLESS OTHERWISE NOTED)
- #5 IRON REBAR SET IN CONCRETE

APPROVED

YORK COUNTY BOARD OF SUPERVISORS

BY: Brian Kassell
 PLAT APPROVING AGENT

DATE: August 26, 2024

STATE OF VIRGINIA
 COUNTY OF YORK
 IN THE CLERK'S OFFICE OF THE CIRCUIT COURT FOR THE COUNTY OF YORK-POQUOSON, ON THIS 29 DAY OF August, 2024
 THIS MAP WAS PRESENTED AND ADMITTED TO RECORD AS THE LAW DIRECTS, AS INSTRUMENT NUMBER 24001754

TESTE: Kristen N. Nelson, CLERK
 BY: Cheryl McKeown DC