

NOTES:
 CASHED LINES DENOTE APPROXIMATE LIMITS OF GRADING WHICH THESE NOTES SHEET NUMBERS ON PLANS.
 DENOTES CUT
 DENOTES FILL
 SUTABLE TRANSITION TO EXISTING DRAINAGE TO BE CON-
 3-3-6, 9, 11 ALL SHEETS
 ENGINEER
 DOT-DASHED LINE AND FIGURES IN PARENTHESES DENOTE
 4-5-5, 7, 8, 9, 10 ALL SHEETS
 ALL ENTRANCES ARE TO BE STD. CG-6
 4-5-5, 7, 9, 10
 DEPARTMENT CONSTRUCTION AGREEMENT TO BE ACQUIRED.

CONVEYED TO Colonial
 WILLIAMSBURG FOUNDATION
 by deed dated 1-11-52
 NOTE: Center of Stream is
 N.C.L. OF WILLIAMSBURG &
 N.Y.C. EXCEPT IN ROAD CUTS
 (Channel has been widened)

DESIGN FEATURES RELATING
 TO REGULATION AND CON-
 TROL OF FLOW MAY BE SUBJECT TO CHANGE
 NECESSARY BY THE DEPART-
 MENT OF PUBLIC WORKS

DATE	REVISION	BY	REASON
10-17-79			

PROJECT: 0060-099-103, PE C-501

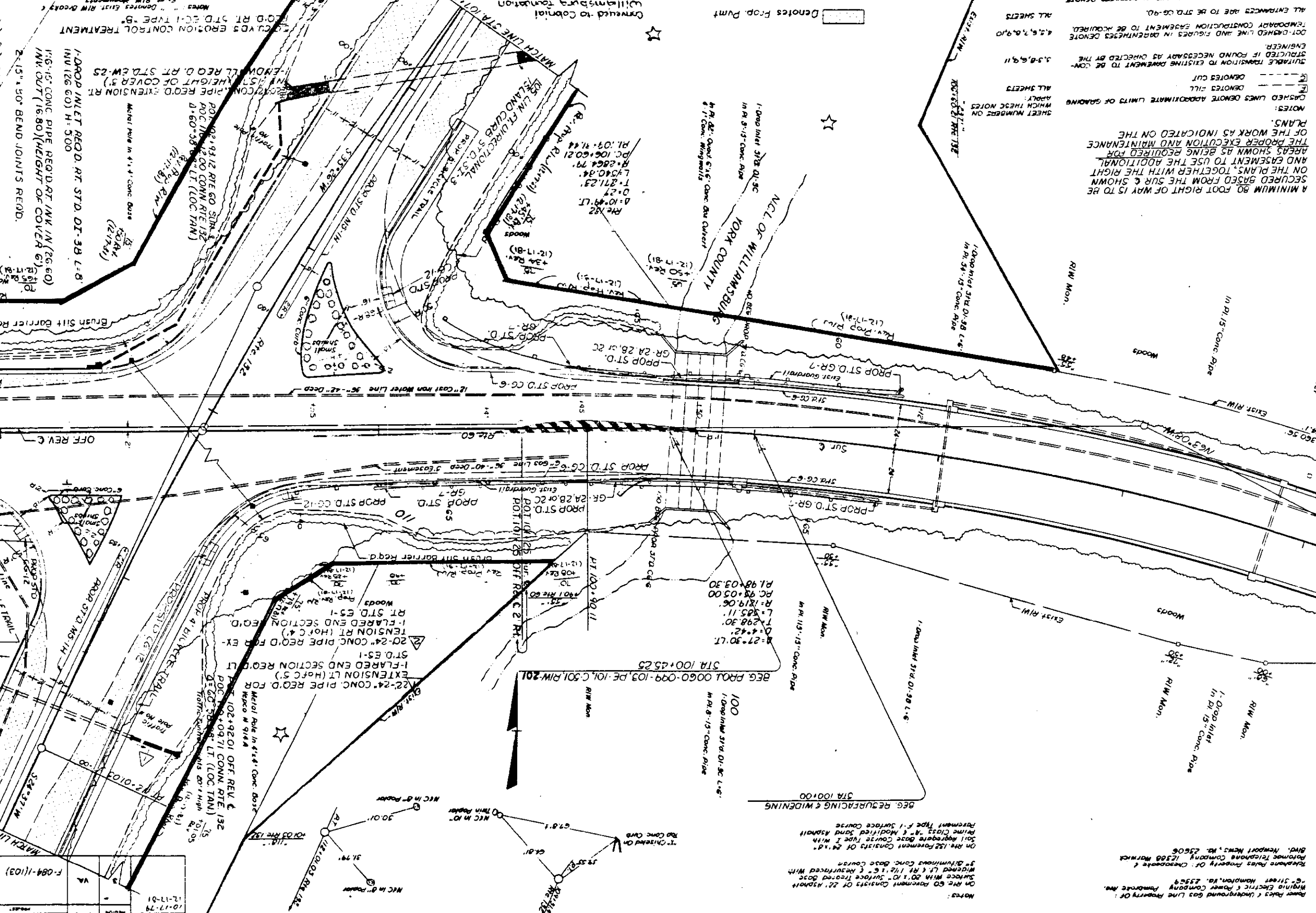

Notes:
 On Rte 60 Pavement Consists of 2 1/2" Asphalt
 Surface with 20" 1 1/2" Surface Treated Base
 Surface with 1 1/2" 1 1/2" & Resurfaced with
 3" Diffuse Conc. Base Course
 Pavement Paves Property of Chesapeake &
 Potomac Telephone Company (2500 March
 Blvd. Newport News, Va. 23606
 Power Poles & Underground Gas Line Property of
 Virginia Electric & Power Company
 6" Street Hampton, Va. 23509

Match Line STA 101+50 SHEET NO. 3 B
 Match Line STA 102+00 SHEET NO. 3 C
 Match Line STA 102+50 SHEET NO. 3 D